

PERFORMANCE DATA

- Flex Cycles:** 2500 cycles*
- Current Rating:** Single Powerline = 15.1 Amps**
- Voltage Rating:** 300 V***
- CC DCR:** 4.6Ω/1000ft
- Availability:** Single, tape bonded
- Temperature Rating:** -10°C to 200°C, UL VW-1 Rated***
-40°C to 200°C****
- DWV Working Voltage:** 1250 V*****

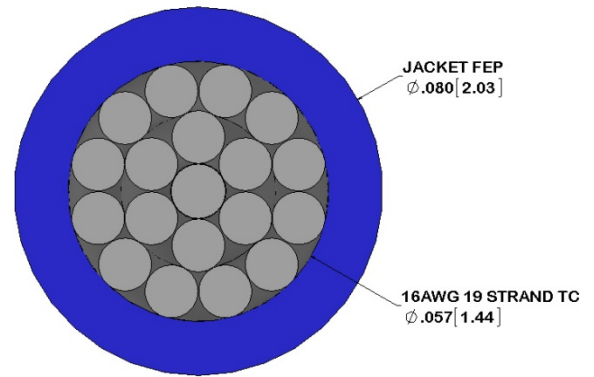

CURRENT CARRYING CAPACITY GRAPH **

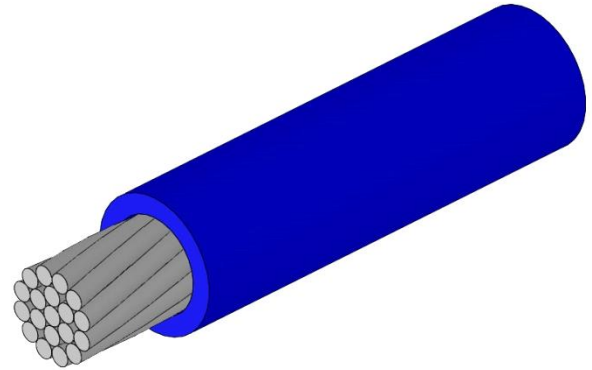
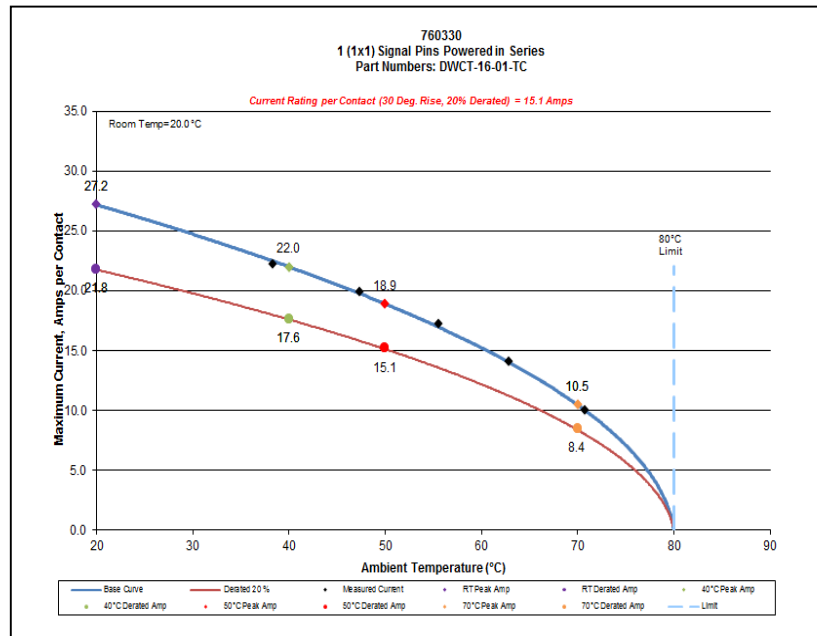

* Test Conditions – 4 oz. weight, dia 1/4" mandrel, +/-90 bend X2

** Rating - 30°C Temperature Rise, 20% de-rated

*** Temperature Rating – U.L. certification under style #10518, horizontal and VW-1 flame rating

**** Temperature Rating – Heat Shock/Cold Bend per UL1581, wire wrap 1/4" mandrel, visual inspection

***** Test Conditions – DWV per EIA-364-20, ASTM D470-13 and D149-09