

- NOTES:  
 1. THIS IS AN INDUSTRY STANDARD PRODUCT. MAKE NO CHANGES WITHOUT CONTACTING THE INDUSTRY STANDARD DEPARTMENT.  
 2. REPRESENTS A CRITICAL DIMENSION.  
 3. MAXIMUM CUT FLASH: .020[0.51]  
 4. ITEM 3 BODY NOT TO BE MORE THAN ±.005[0.13] FROM PLANE SET BY ITEM 1.  
 5. PARTS TO BE PACKAGED IN UNIFORM LAYER.  
 6. ORDERS WILL BE PACKAGED ACCORDING TO THE SAMTEC PACKAGING EFFICIENCY STANDARDS (SPES) FOUND ON [WWW.SAMTEC.COM](http://WWW.SAMTEC.COM).

DO NOT SCALE FROM THIS PRINT

BY SIGNING THIS DOCUMENT YOU ARE ACCEPTING THE CONDITIONS SET WITHIN. YOUR REQUIREMENTS MUST BE LISTED WITHIN THIS DRAWING. WHERE NO DIRECTION FROM THE CUSTOMER IS IDENTIFIED SAMTEC'S PROCESS REQUIREMENTS WILL BE USED.

DATE: \_\_\_\_\_  
 COMPANY: \_\_\_\_\_  
 CUSTOMER SIGNATURE: \_\_\_\_\_  
 PRINTED NAME: \_\_\_\_\_  
 PHONE No: \_\_\_\_\_  
 EXCEPTIONS: \_\_\_\_\_

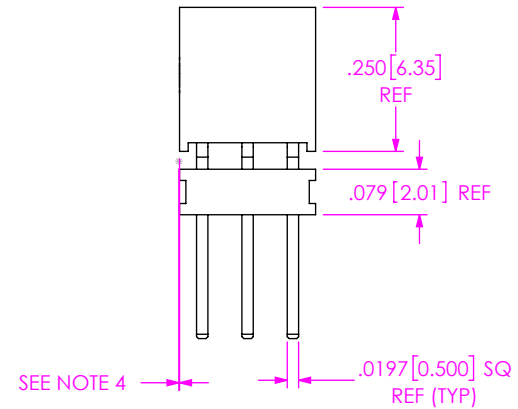
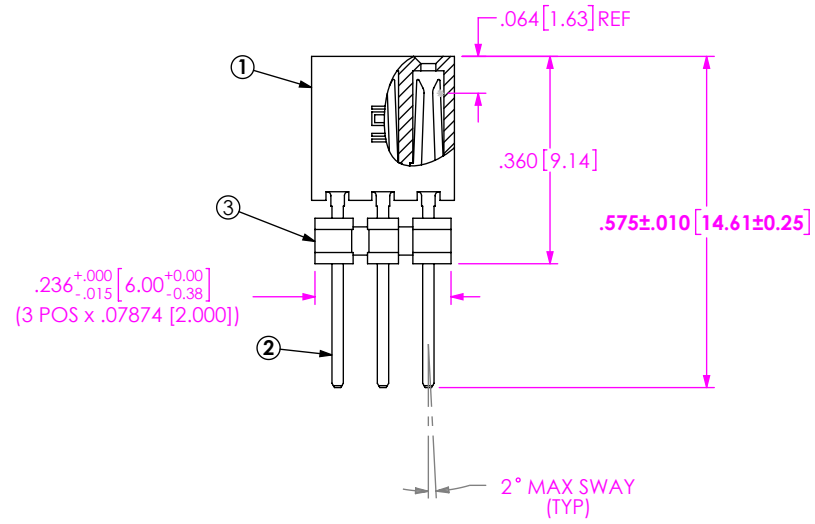
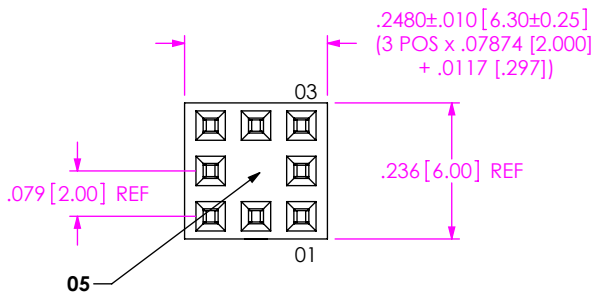
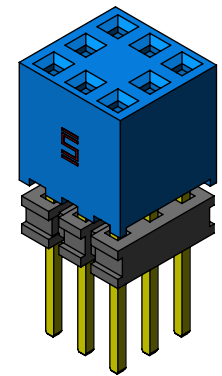

UNLESS OTHERWISE SPECIFIED, DIMENSIONS ARE IN INCHES.  
 TOLERANCES ARE:  
 DECIMALS ANGLES  
 .XX: ±.01 [0.3] 2°  
 .XXX: ±.005 [0.13]  
 .XXXX: ±.0020 [0.051]

**PROPRIETARY NOTE**  
 THIS DOCUMENT CONTAINS CONFIDENTIAL AND PROPRIETARY INFORMATION AND ALL DESIGN, MANUFACTURING, REPRODUCTION, USE, PATENT RIGHTS AND SALES RIGHTS ARE EXPRESSLY RESERVED BY SAMTEC, INC. THIS DOCUMENT SHALL NOT BE DISCLOSED, IN WHOLE OR PART, TO ANY UNAUTHORIZED PERSON OR ENTITY NOR REPRODUCED, TRANSFERRED OR INCORPORATED IN ANY OTHER PROJECT IN ANY MANNER WITHOUT THE EXPRESS WRITTEN CONSENT OF SAMTEC, INC.



520 PARK EAST BLVD., NEW ALBANY, IN 47150  
 PHONE: 812-944-6733 FAX: 812-948-5047  
 e-Mail: info@SAMTEC.com code: 55322

DO NOT SCALE DRAWING SHEET SCALE: 3:1  
 PLATING:  
 CONTACT AREA: .000020 GOLD OVER .000050 NICKEL  
 REMAINDER: .000003 GOLD OVER .000050 NICKEL

DESCRIPTION: 2MM TRIPLE ROW SOCKET STRIP

DWG. NO. ASP-232112-07

BY: TAMMY B 07/24/2023 SHEET 1 OF 1

ITEM NO.	PART NUMBER	QUANTITY	MATERIAL
1	ASP-232382-02-B	.08333	VECTRA E130 ID2, COLOR: BLUE
2	ASP-232113-02-P-G	8.0000	PHOS BRONZE, 510 EXTRA HARD TEMPER
3	TMMH-50-T	.06250	VECTRA E130i, COLOR: BLACK