

# SI-FLY<sup>®</sup> HD

## 224 GBPS PAM4, CO-PACKAGED AND NEAR-CHIP SYSTEMS



### FEATURES & BENEFITS

- High-density 224 Gbps PAM4 co-packaged and near-chip (ASIC adjacent) cable systems
- Co-packaged offers the lowest loss signal transmission from the package to the front panel or backplane while providing the highest density
- PCIe<sup>®</sup> 7.0 capable
- Eye Speed<sup>®</sup> hyper low skew twinax cable technology supports 224G signaling with an industry leading 1.75 ps/m max intra-pair skew
- Placement of Flyover<sup>®</sup> cable solutions on, or near, the chip package improves transmission line density and extends signal reach in high-performance applications
- Co-packaged signal density: 170 differential pairs per square inch
- Near-chip signal density: 64 differential pairs per square inch
- Routes an extremely high number of transmission lines from one PCB to the next
- Surface mount reflow technology to the substrate (co-packaged) or PCB (near-chip)

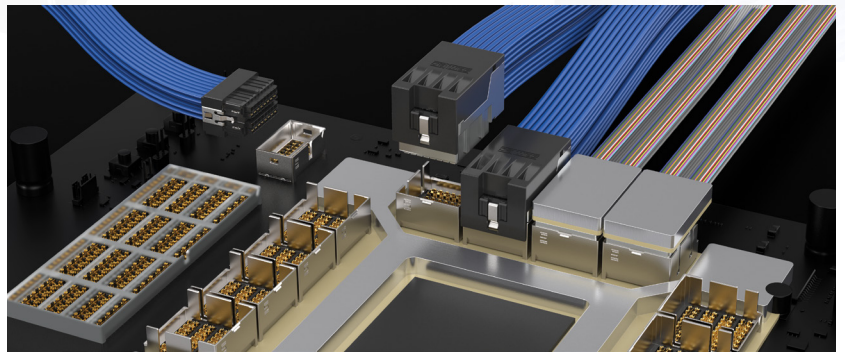

CPX: Electrically pluggable co-packaged copper and optic high-performance, high-density interconnects on a 95 mm x 95 mm or smaller substrate (SFCC, SFCC, Optics). Contact [HDR@samtec.com](mailto:HDR@samtec.com) for more details.

### KEY SPECIFICATIONS

SERIES	CABLE	SIGNAL ROUTING	INSULATOR MATERIAL	CONTACT MATERIAL	PLATING	OPERATING TEMP RANGE	CURRENT RATING	VOLTAGE RATING
SFCC/SFCM SFNC/SFNM	32 AWG hyper low skew twinax	92 Ω Differential	Black LCP	Copper Alloy	Au or Sn over 50 μ" (1.27 μm) Ni	Testing Now!	Testing Now!	Testing Now!

NEAR-CHIP CABLE & CONNECTOR

SFNC	STYLE	1	NO. OF PAIRS PER ROW	NO. OF ROWS	VT	CABLE LENGTH	END 2 OPTION	WIRING OPTION
	-DP = Differential Twinax pairs only		-04 = Four	-04 = Four Rows -08 = Eight Rows		-“XX.X” = Length in Inches 06.0” (152.4 mm) minimum	-A = SFNC-VT End	-1 = Pin A01 to Pin A16 -2 = Pin A01 to Pin N01 (N=Last Row)

PRELIMINARY

SFNC  
Board Mates:  
SFNM



NO. OF ROWS	A
-04	(11.45) .451
-08	(21.65) .852

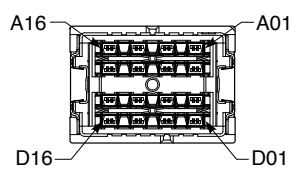
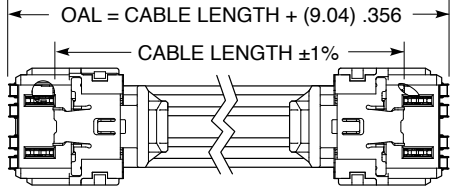
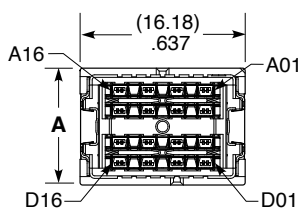

SFNC-DP-1-04-04-VT-XX.X-A-1

Notes:  
Cable lengths longer than 118" (3 meter) are not supported with S.I. test data.

Some lengths, styles and options are non-standard, non-returnable.

View complete specifications at: [samtec.com?SFNC](http://samtec.com?SFNC)

SFNM	STYLE	NO. OF PAIRS PER ROW	NO. OF ROWS	01	VT	PLATING OPTION	PACKAGING
------	-------	----------------------	-------------	----	----	----------------	-----------

-DP  
= Differential Twinax pairs only

-04  
= Four

-04  
= Four Rows  
-08  
= Eight Rows

-S  
= 30 μ" (0.76 μm)  
Gold in contact area,  
Tin on tails

-TY  
= Tray  
-TR  
= Tape & Reel

PRELIMINARY

SFNM  
Cable Mates:  
SFNC

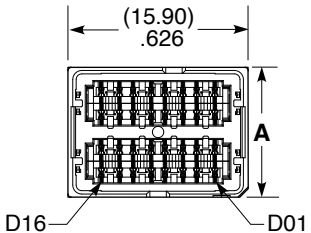

NO. OF ROWS	A
-04	(11.45) .451
-08	(21.65) .852

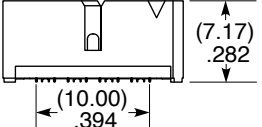

SFNM-DP-04-04-01-VT-S-0-XX

Note:  
Some sizes, styles and options are non-standard, non-returnable.

View complete specifications at: [samtec.com?SFNM](http://samtec.com?SFNM)