

## PERFORMANCE DATA

- Capacitance:** 13.9 pF/ft (nominal)
- Skew:** 10 ps/m within pairs
- Propagation Delay:** 1.46 ns/foot
- Flex Cycles:** 13,000 cycles, single\*
- Current Rating:** Single Conductor = 2.6 Amps\*\*
- Shield DCR:** 26Ω/1000ft
- CC DCR:** 101Ω/1000ft
- Min. Bend Radius:** .375"
- Availability:** Single, tape bonded
- Temperature Rating:** -55°C to 200°C, UL VW-1 Tested \*\*\*
- DWV Working Voltage:** 281 V\*\*\*\*
- Performance Rating:**

IL	.25m	1m
-3dB	14GHz	3GHz
-7dB	>20GHz	10GHz

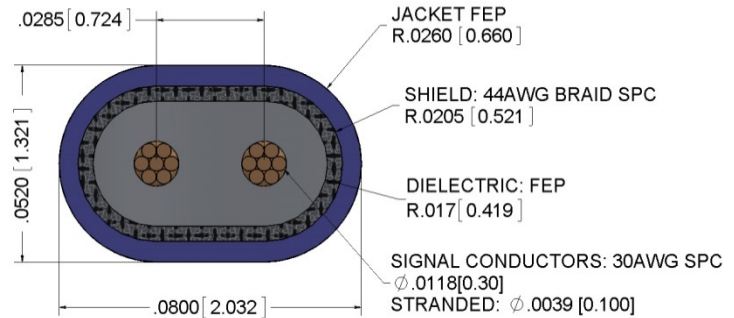
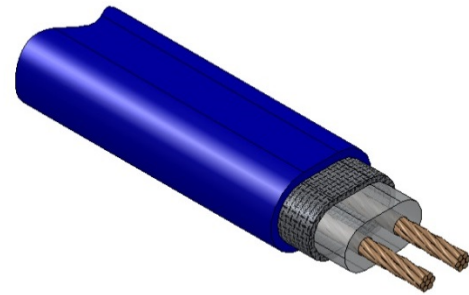

## INSERTION LOSS AND RETURN LOSS GRAPHS \*\*\*\*\*

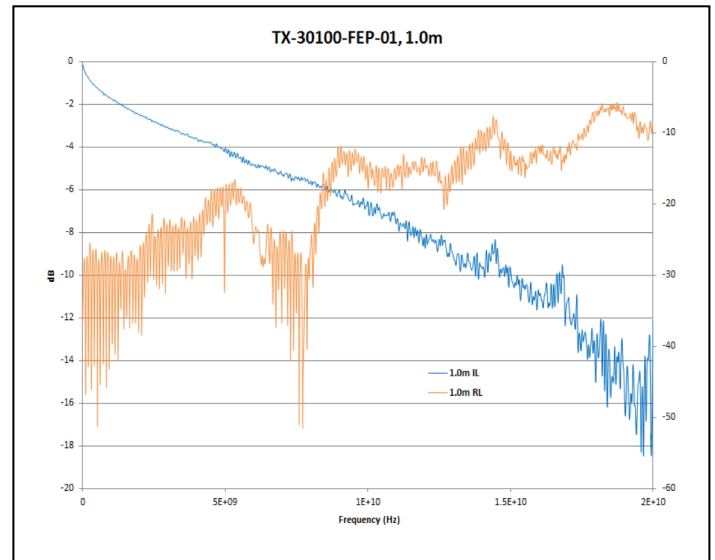
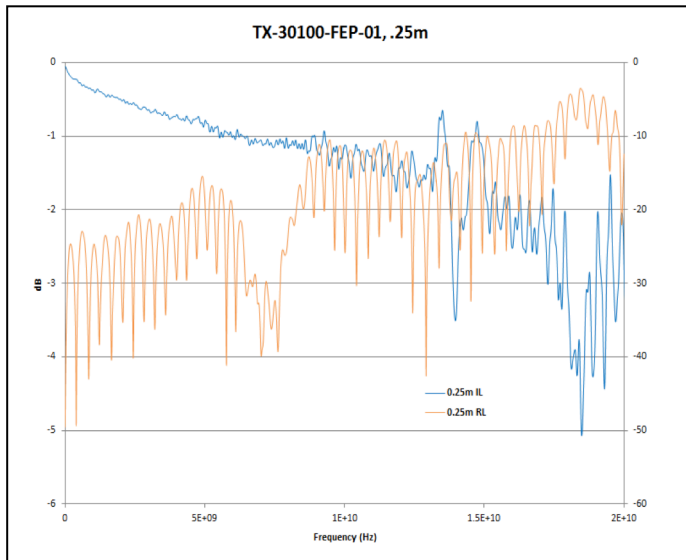

\* Test Conditions – 4 oz. weight, dia 7/8" mandrel, +/-90 bend X2

\*\* Rating - 30°C Temperature Rise, 20% de-rated

\*\*\* Test Conditions – Heat Shock/Cold Bend per UL1581, wire wrap 1/4" mandrel, visual inspection

\*\*\*\* Test Conditions – IR/DWV/Thermal Shock/Humidity per EIA-364-20, 21, 31 and 32

\*\*\*\*\* IL and RL data are typical. Results may vary.