

DO NOT SCALE FROM THIS PRINT

DESIGNED & DIMENSIONED IN INCHES[MILLIMETERS]

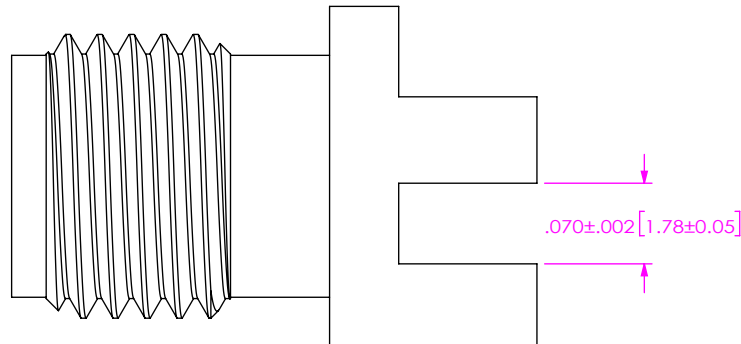
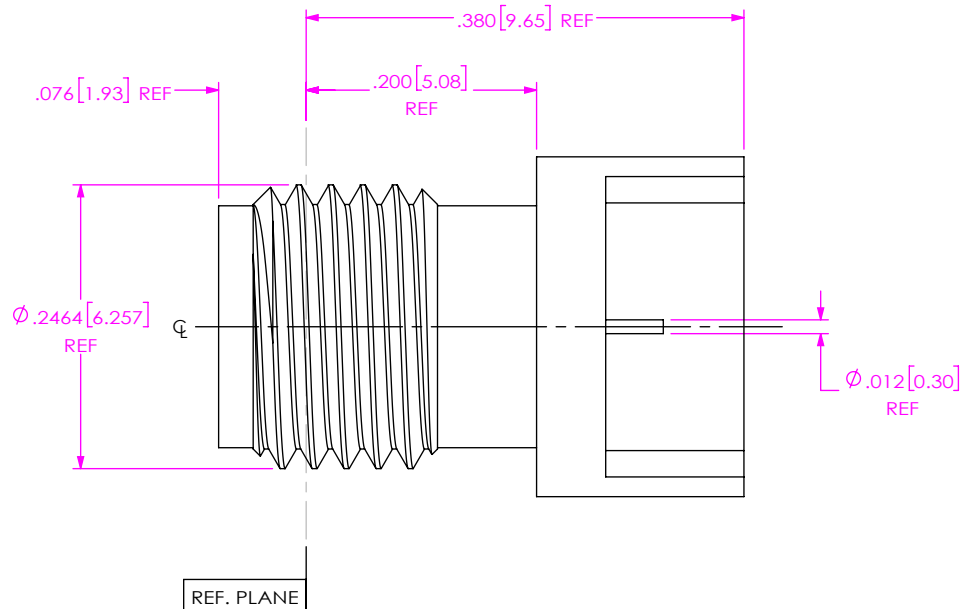

292-J-P-EE-ST-EM-1

- SERIES
-292: 2.92MM
- GENDER
-J: JACK
- TYPE
-P: PCB
- FINISH
-EE: 50µ" EXTRA HEAVY GOLD CENTER CONTACT, 50µ" EXTRA HEAVY GOLD OUTER BODY
- OPTION
-1
- TERMINATION
-EM: EDGE MOUNT
- ORIENTATION
-ST: STRAIGHT

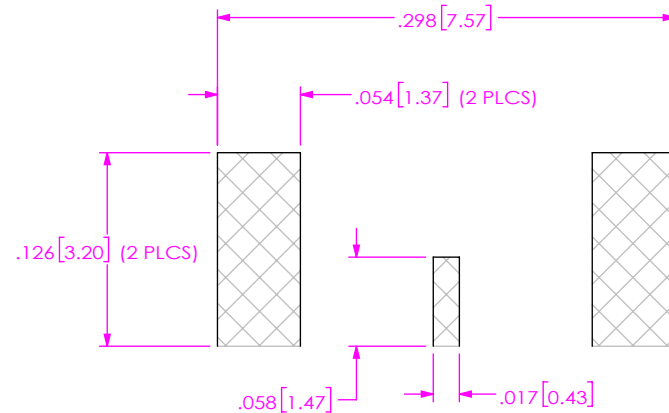
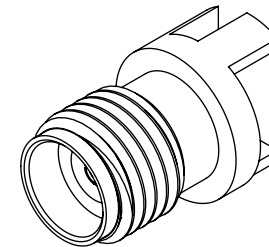

RECOMMENDED PCB LAYOUT (SEE NOTE 4, 5 & 6)

NOTES:

1. MATERIAL:
BODY, SOCKET & BUSHING: BERYLLIUM COPPER.
BEAD: ULTEM 1000.
2. FINISH:
BODY, SOCKET & BUSHING: GOLD OVER NICKEL PLATE,
50 µ" MIN GOLD OVER 50 µ" MIN NICKEL.
3. PCI P/N: 3212.
4. PCB THICKNESS TO BE .062[1.57].
5. STENCIL APERTURES TO BE 1:1 WITH THE PCB SURFACE MOUNT PADS.
STENCIL THICKNESS TO BE .005[0.13].
6. A FIXTURE IS RECOMMENDED DURING THE REFLOW PROCESS TO HOLD THE CONNECTOR STRAIGHT AND PARALLELL WITH THE PCB. CONTACT IPG FOR MORE DETAILS.

UNLESS OTHERWISE SPECIFIED, DIMENSIONS ARE IN INCHES.
TOLERANCES ARE:
DECIMALS ANGLES
.XX: ±.01 [0.3] 1°
.XXX: ±.005 [0.13]
.XXXX: ±.0005 [0.013]

PROPRIETARY NOTE
THIS DOCUMENT CONTAINS CONFIDENTIAL AND PROPRIETARY INFORMATION AND ALL DESIGN, MANUFACTURING, REPRODUCTION, USE, PATENT RIGHTS AND SALES RIGHTS ARE EXPRESSLY RESERVED BY SAMTEC, INC. THIS DOCUMENT SHALL NOT BE DISCLOSED, IN WHOLE OR PART, TO ANY UNAUTHORIZED PERSON OR ENTITY NOR REPRODUCED, TRANSFERRED OR INCORPORATED IN ANY OTHER PROJECT IN ANY MANNER WITHOUT THE EXPRESS WRITTEN CONSENT OF SAMTEC, INC.



520 PARK EAST BLVD, NEW ALBANY, IN 47150
PHONE: 812-944-6733 FAX: 812-948-5047
e-Mail info@SAMTEC.com code 55322

DO NOT SCALE DRAWING

SHEET SCALE: 4.5:1

DESCRIPTION:
2.92MM JACK PCB MOUNT DIA.012 PIN

DWG. NO. 292-J-P-EE-ST-EM-1

BY: HENSON T 08/07/2020 SHEET 1 OF 1