

DESIGNED AND DIMENSIONED IN MILLIMETERS [INCHES]  
ALL DIMENSIONS REFERENCE EXCEPT AS SHOWN

DO NOT SCALE FROM THIS PRINT

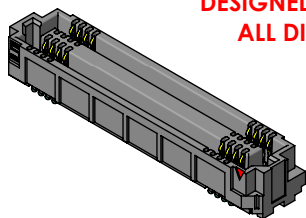

ADF6-XXX-XX.X-XXX-4-X-X-XR

PACKAGING (SEE NOTES 2, 5 & 7)  
-TR: TAPE & REEL  
-FR: FULL REEL QTY TAPE & REEL

No. OF POSITIONS  
-10 -20, -30, -40, -50, -60,  
\*\*-70, \*\*-80, \*\*-90, \*\*-100  
(PER ROW)

LEAD STYLE  
-03.5: 3.5MM  
-07.5: 7.5MM

PLATING SPECIFICATION  
-L: 10µ" SELECTIVE GOLD  
IN CONTACT AREA,  
MATTE TIN ON TAIL  
-S: 30µ" SELECTIVE GOLD  
IN CONTACT AREA,  
MATTE TIN ON TAIL  
\*\*-STL: 30µ" SELECTIVE GOLD  
IN CONTACT AREA,  
TIN/LEAD ON SOLDER TAIL.

OPTION  
BLANK: NO ALIGNMENT PIN  
-A: ALIGNMENT PIN  
(SEE SHT 3, FIG 3)

TERMINATION  
-0: COLUMN (SEE NOTE 8)  
\*\*∅ -1: BALL (63.0% TIN/37.0% LEAD)  
-2: BALL (96.5% TIN/3.0% SILVER/0.5% COPPER)

4 ROW

(\*\* = NOT RELEASED FOR -07.5 LEAD STYLE)  
(∅ = ONLY AVAILABLE WITH -STL PLATING)

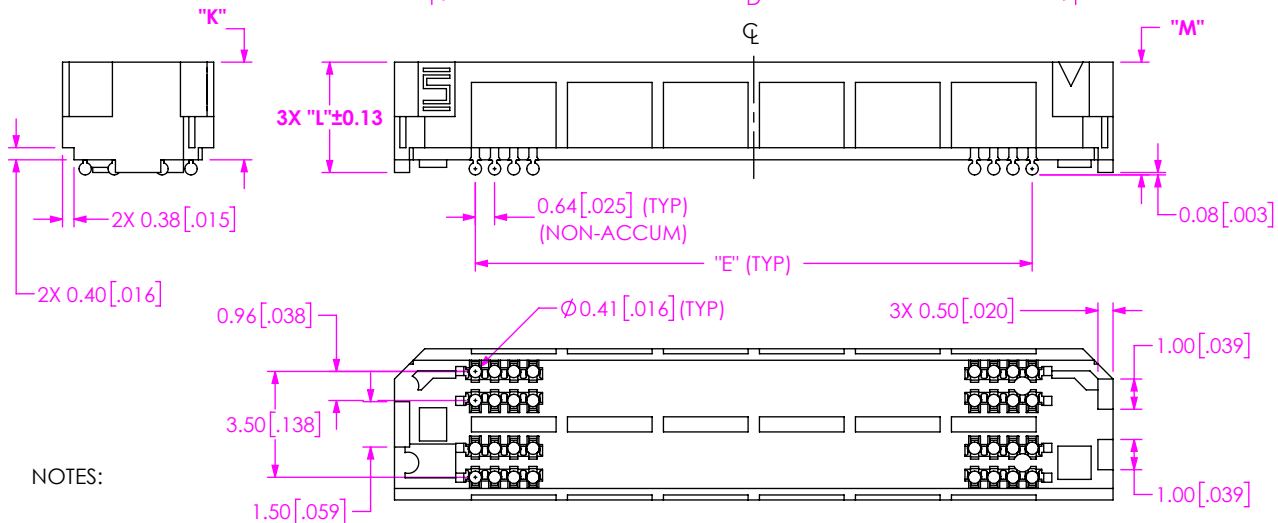
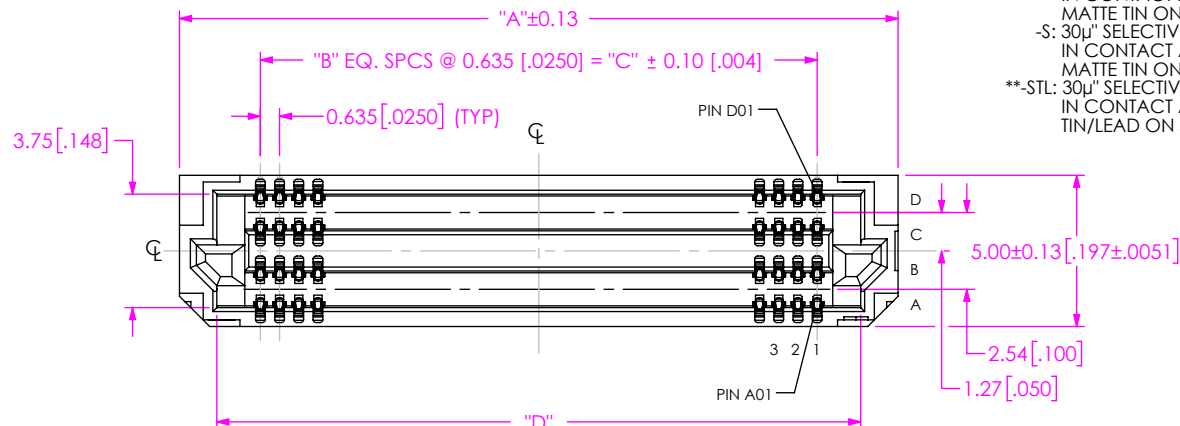

**TABLE 7**

LEADSTYLE	"K"	"L"	"M"
-03.5	3.230 [0.1272]	3.65 [0.144]	3.73 [0.147]
-07.5	7.230 [0.2846]	7.65 [0.301]	7.73 [0.304]

**TABLE 1**  
STACK HEIGHT

ADM6 LEAD STYLE	ADM6 LEAD STYLE			
	-01.5	-03.5	-06.5	-08.5
-03.5	5.00 [0.197]	7.00 [0.276]	10.00 [0.394]	12.00 [0.472]
-07.5	9.00 [0.354]	11.00 [0.433]	14.00 [0.551]	16.00 [0.630]

**TABLE 2**

No. OF POS. PER ROW	"A"	"B"	"C"	"D"	"E"
-10	11.07 [.436]	9	5.715 [2.25]	8.595 [3.38]	5.72 [2.25]
-20	17.42 [686]	19	12.065 [4.75]	14.945 [5.88]	12.07 [4.75]
-30	23.77 [936]	29	18.415 [7.25]	21.295 [8.38]	18.42 [7.25]
-40	30.12 [1.186]	39	24.765 [9.75]	27.645 [1.088]	24.77 [9.75]
-50	36.47 [1.436]	49	31.115 [1.225]	33.995 [1.338]	31.12 [1.225]
-60	42.82 [1.686]	59	37.465 [1.475]	40.345 [1.588]	37.47 [1.475]
-70	49.17 [1.936]	69	43.815 [1.725]	46.695 [1.838]	43.82 [1.725]
-80	55.52 [2.186]	79	50.165 [1.975]	53.045 [2.088]	50.17 [1.975]
-90	61.87 [2.436]	89	56.515 [2.225]	59.395 [2.338]	56.52 [2.225]
-100	68.22 [2.686]	99	62.865 [2.475]	65.745 [2.588]	62.87 [2.475]

- NOTES:
- NOTE DELETED.
  - TAPE & REEL IS STANDARD PACKAGING.
  - NOTE DELETED.
  - NOTE DELETED.
  - ATTACH LABEL-4X2 TO EACH REEL.
  - K-DOT PROVIDED AS STANDARD.
  - ORDERS WILL BE PACKAGED ACCORDING TO THE SAMTEC PACKAGING EFFICIENCY STANDARDS (SPES) FOUND ON WWW.SAMTEC.COM.
  - L AND -S PLATED PARTS WILL HAVE MATTE TIN ON THE TAIL. -STL PLATED PARTS WILL HAVE TIN/LEAD ON THE TAIL. PARTS ARE SOLDERED WITH OPTIMIZED SOLDER PASTE VOLUME IN PLACE OF AN ATTACHED SOLDER BALL. FOR MORE INFORMATION, CONTACT SAMTEC'S INTERCONNECT PROCESSING GROUP ([IPG@SAMTEC.COM](mailto:IPG@SAMTEC.COM)).

FIG 1  
ADF6-30-03.5-XXX-4-X-XR SHOWN  
(SOME CENTER FEATURES REMOVED FOR CLARITY)

PROPRIETARY NOTE  
THIS DOCUMENT CONTAINS CONFIDENTIAL AND PROPRIETARY INFORMATION AND ALL DESIGN, MANUFACTURING, REPRODUCTION, USE, PATENT RIGHTS AND SALES RIGHTS ARE EXPRESSLY RESERVED BY SAMTEC, INC. THIS DOCUMENT SHALL NOT BE DISCLOSED, IN WHOLE OR PART, TO ANY UNAUTHORIZED PERSON OR ENTITY NOR REPRODUCED, TRANSFERRED OR INCORPORATED IN ANY OTHER PROJECT IN ANY MANNER WITHOUT THE EXPRESS WRITTEN CONSENT OF SAMTEC, INC.

DO NOT SCALE DRAWING  
SHEET SCALE: 4:1

MATERIAL:  
INSULATOR: LCP, COLOR BLACK  
CONTACT: COPPER ALLOY

520 PARK EAST BLVD, NEW ALBANY, IN 47150  
PHONE: 812-944-6733 FAX: 812-948-5047  
e-Mail: info@SAMTEC.com code 55322

DESCRIPTION:  
**ADF6 ASSEMBLY**

DWG. NO.  
**ADF6-XXX-XX.X-XXX-4-X-X-XR**

BY: J RUZZI 6/10/2016 SHEET 1 OF 4

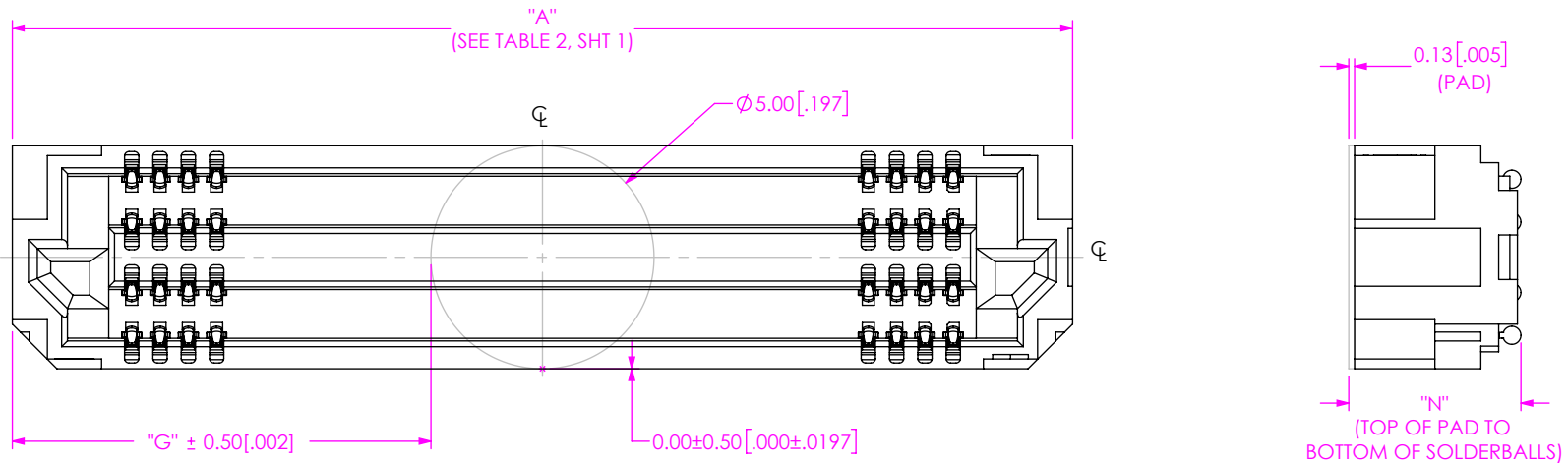

FIG 2  
 POLYIMIDE PAD  
 ADF6-30-03.5-XXX-4-X-XR SHOWN  
 (SOME CENTER FEATURES REMOVED FOR CLARITY)

-No OF POS IN ROW	"G"
10 POS	3.03 [0.119]
20 POS	6.21 [0.244]
30 POS	9.38 [0.369]
40 POS	12.56 [0.494]
50 POS	15.73 [0.619]
60 POS	18.91 [0.744]
70 POS	22.08 [0.869]
80 POS	25.26 [0.994]
90 POS	28.43 [1.119]
100 POS	31.61 [1.244]

LEADSTYLE	"N"
-03.5	3.86 [0.152]
-07.5	7.86 [0.309]

**PROPRIETARY NOTE**  
 THIS DOCUMENT CONTAINS CONFIDENTIAL AND PROPRIETARY INFORMATION AND ALL DESIGN, MANUFACTURING, REPRODUCTION, USE, PATENT RIGHTS AND SALES RIGHTS ARE EXPRESSLY RESERVED BY SAMTEC, INC. THIS DOCUMENT SHALL NOT BE DISCLOSED, IN WHOLE OR PART, TO ANY UNAUTHORIZED PERSON OR ENTITY NOR REPRODUCED, TRANSFERRED OR INCORPORATED IN ANY OTHER PROJECT IN ANY MANNER WITHOUT THE EXPRESS WRITTEN CONSENT OF SAMTEC, INC.



520 PARK EAST BLVD, NEW ALBANY, IN 47150  
 PHONE: 812-944-6733 FAX: 812-948-5047  
 e-Mail info@SAMTEC.com code 55322

DO NOT SCALE DRAWING

SHEET SCALE: 4:1

DESCRIPTION:  
**ADF6 ASSEMBLY**  
 DWG. NO.  
**ADF6-XXX-XX.X-XXX-4-X-XR**  
 BY: J RUZZI 6/10/2016 SHEET 2 OF 4

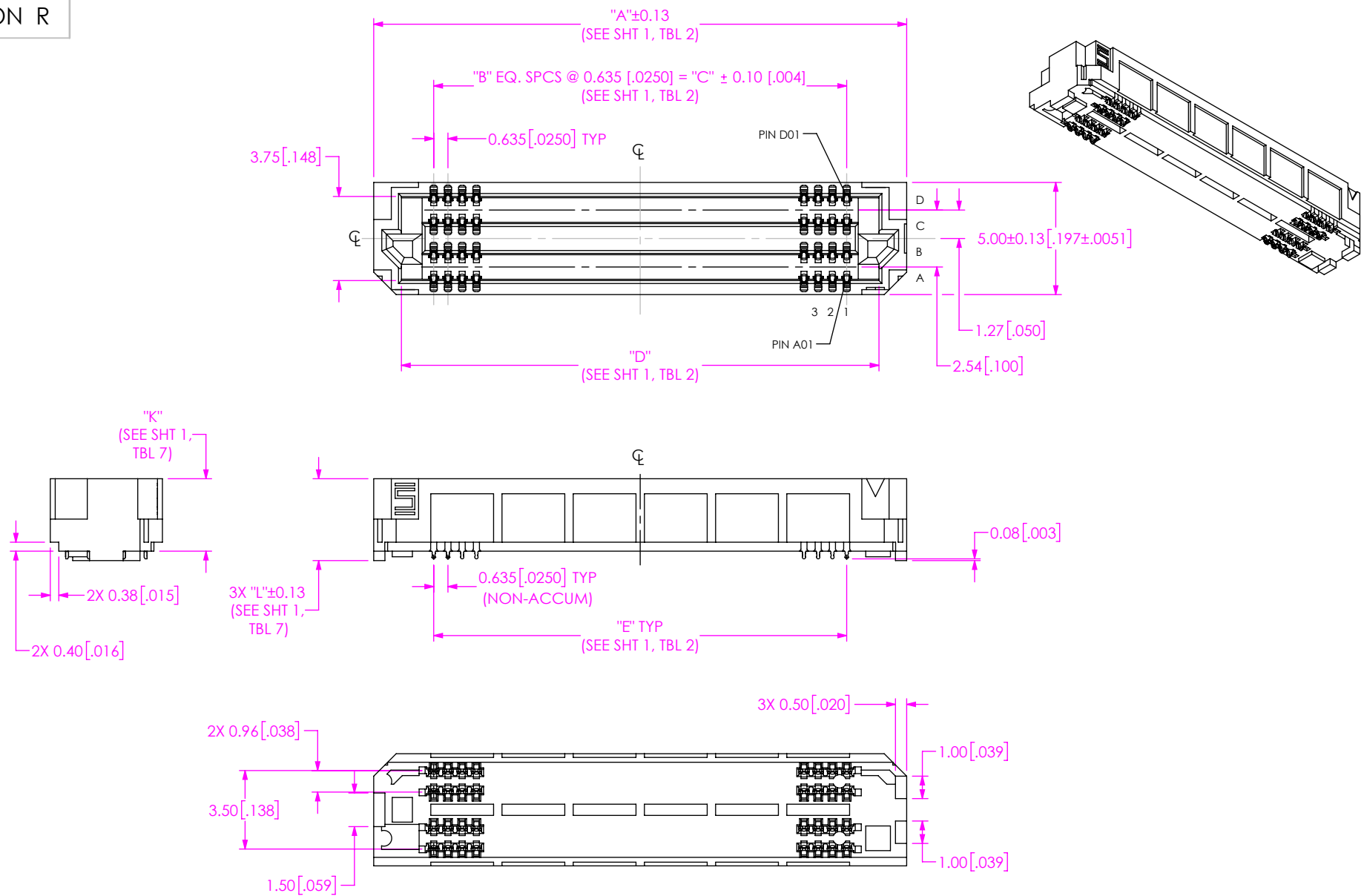

FIG 4  
 ADF6-30-03.5-XXX-4-0-XR SHOWN  
 (NO SOLDER BALL OPTION)  
 (SOME CENTER FEATURES REMOVED FOR CLARITY)

**PROPRIETARY NOTE**  
 THIS DOCUMENT CONTAINS CONFIDENTIAL AND PROPRIETARY INFORMATION AND ALL DESIGN, MANUFACTURING, REPRODUCTION, USE, PATENT RIGHTS AND SALES RIGHTS ARE EXPRESSLY RESERVED BY SAMTEC, INC. THIS DOCUMENT SHALL NOT BE DISCLOSED, IN WHOLE OR PART, TO ANY UNAUTHORIZED PERSON OR ENTITY NOR REPRODUCED, TRANSFERRED OR INCORPORATED IN ANY OTHER PROJECT IN ANY MANNER WITHOUT THE EXPRESS WRITTEN CONSENT OF SAMTEC, INC.



520 PARK EAST BLVD, NEW ALBANY, IN 47150  
 PHONE: 812-944-6733 FAX: 812-948-5047  
 e-Mail info@SAMTEC.com code 55322

DO NOT SCALE DRAWING

SHEET SCALE: 4:1

DESCRIPTION:

ADF6 ASSEMBLY

DWG. NO.

ADF6-XXX-XX.X-XXX-4-X-X-XR

BY: J RUZZI

6/10/2016

SHEET 3 OF 4

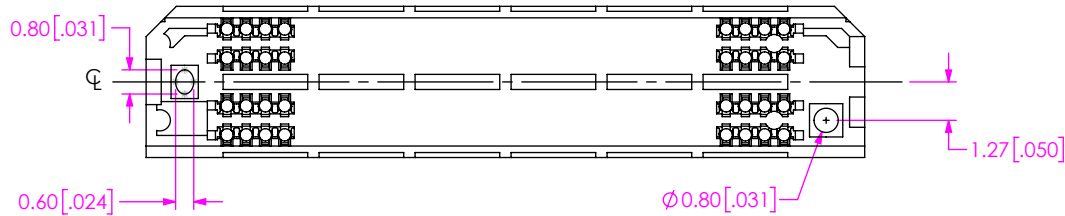
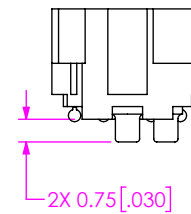
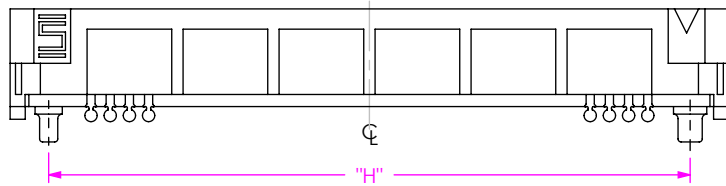
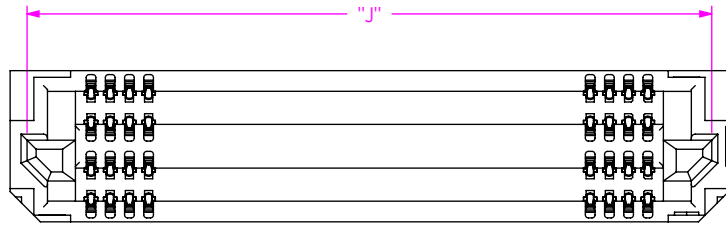

**TABLE 5**

No OF POS PER ROW	"H"
-10	8.52 [0.335]
-20	14.87 [0.585]
-30	21.22 [0.835]
-40	27.57 [1.085]
-50	33.92 [1.335]
-60	40.27 [1.585]
-70	46.62 [1.835]
-80	52.97 [2.085]
-90	59.32 [2.335]
-100	65.67 [2.585]

**TABLE 6**

No OF POS PER ROW	"J"
-10	9.945 [0.3915]
-20	16.295 [0.6415]
-30	22.645 [0.8915]
-40	28.995 [1.1415]
-50	35.345 [1.3915]
-60	41.695 [1.6415]
-70	48.045 [1.8915]
-80	54.395 [2.1415]
-90	60.745 [2.3915]
-100	67.095 [2.6415]

**FIG 3**  
 -A: ALIGNMENT PIN  
 ADF6-30-03.5-XXX-4-X-A-XR SHOWN  
 (SAME AS FIG 1, EXCEPT AS SHOWN)  
 (SOME CENTER FEATURES REMOVED FOR CLARITY)

**PROPRIETARY NOTE**  
 THIS DOCUMENT CONTAINS CONFIDENTIAL AND PROPRIETARY INFORMATION AND ALL DESIGN, MANUFACTURING, REPRODUCTION, USE, PATENT RIGHTS AND SALES RIGHTS ARE EXPRESSLY RESERVED BY SAMTEC, INC. THIS DOCUMENT SHALL NOT BE DISCLOSED, IN WHOLE OR PART, TO ANY UNAUTHORIZED PERSON OR ENTITY NOR REPRODUCED, TRANSFERRED OR INCORPORATED IN ANY OTHER PROJECT IN ANY MANNER WITHOUT THE EXPRESS WRITTEN CONSENT OF SAMTEC, INC.



520 PARK EAST BLVD, NEW ALBANY, IN 47150  
 PHONE: 812-944-6733 FAX: 812-948-5047  
 e-Mail info@SAMTEC.com code 55322

DO NOT SCALE DRAWING

SHEET SCALE: 4:1

DESCRIPTION: **ADF6 ASSEMBLY**

DWG. NO. **ADF6-XXX-XX.X-XXX-4-X-X-XR**

BY: J RUZZI 6/10/2016 SHEET 4 OF 4