

DO NOT SCALE FROM THIS PRINT

DESIGNED & DIMENSIONED IN MILLIMETERS [INCHES]

ADP7-76SP2-73SP1

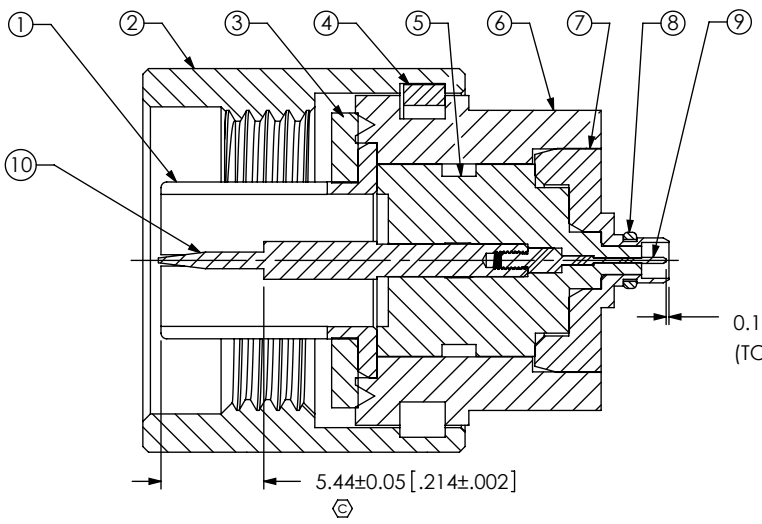

SECTION "A"-"A"

IMPEDANCE -7: 75 OHM

PLATING SPECIFICATION
-HF: 30μ" GOLD CENTER CONTACT (SEE TABLE 1, ITEM 9),
3μ" GOLD OUTER CONTACT (SEE TABLE 1, ITEM 7, 8) (SEE TABLE 1)

END 1
-76SP: N-TYPE STRAIGHT PLUG

PLATING SPECIFICATION
-HN: 30μ" GOLD CENTER CONTACT (SEE TABLE 1, ITEM 10),
100μ" NICKEL OUTER CONTACT (SEE TABLE 1, ITEM 1, 2, 6) (SEE TABLE 1)

END 2
-73SP: MMCX7 STRAIGHT PLUG

TABLE 1		
ITEM	COMPONENT	PATR NUMBER
1	SHELL 2	NTPE-P-C-N-ST-C10-SHL
2	COUPLING NUT	NTPE-CNUT-002-N
3	GASKET	NTPE-GKT-002
4	C-RING 2	NTPE-CRNG-001
5	INSULATOR	ADP7-76SP2-73SP1-INS
6	BODY	ADP7-76SP2-CBDY
7	SHELL 1	ADP7-73SP1-SHL
8	C-RING1	MMCX-CRNG-001-F
9	CENTER CONTACT 1	ADP7-73SP1-PIN
10	CENTER CONTACT 2	ADP7-76SP2-PIN

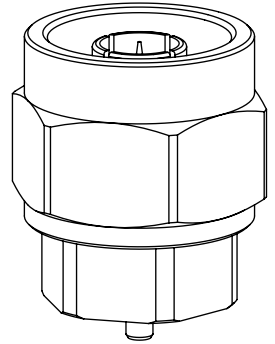
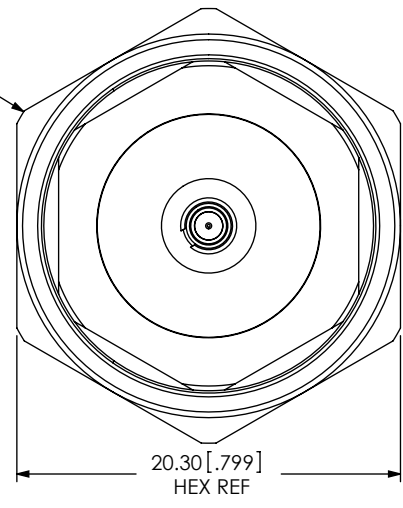
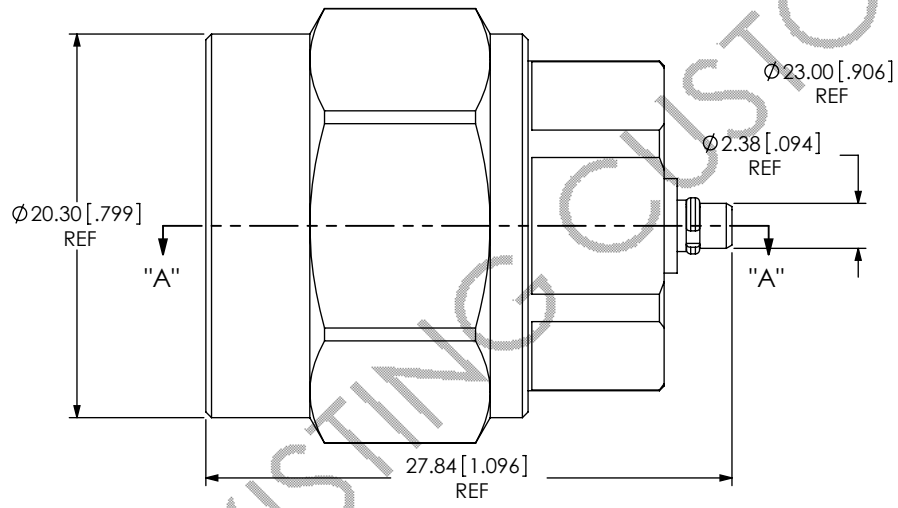

NOTES:

- ⊕ REPRESENTS A CRITICAL DIMENSION.
- CENTER CONTACT PUSHOUT FORCE: 28 N [6.3LBS] MIN.
- PRODUCT TO BE PACKAGED PER PACKING STANDARD CO-HD-WI-3040-M. TRAY: TY-BNC002-1 COVER: TY-BNC002-2 36 PARTS PER TRAY(ONE PART PER POCKET).

UNLESS OTHERWISE SPECIFIED, DIMENSIONS ARE IN MILLIMETERS. TOLERANCES ARE:
DECIMALS ANGLES
X.X: ±0.3 [.01] 5°
X.XX: ±0.13 [.005]
X.XXX: ±0.051 [.0020]

PROPRIETARY NOTE
THIS DOCUMENT CONTAINS CONFIDENTIAL AND PROPRIETARY INFORMATION AND ALL DESIGN, MANUFACTURING, REPRODUCTION, USE, PATENT RIGHTS AND SALES RIGHTS ARE EXPRESSLY RESERVED BY SAMTEC, INC. THIS DOCUMENT SHALL NOT BE DISCLOSED, IN WHOLE OR PART, TO ANY UNAUTHORIZED PERSON OR ENTITY NOR REPRODUCED, TRANSFERRED OR INCORPORATED IN ANY OTHER PROJECT IN ANY MANNER WITHOUT THE EXPRESS WRITTEN CONSENT OF SAMTEC, INC.



520 PARK EAST BLVD, NEW ALBANY, IN 47150
PHONE: 812-944-6733 FAX: 812-948-5047
e-Mail info@SAMTEC.com code 55322

MATERIAL: DO NOT SCALE DRAWING SHEET SCALE: 2.5:1
COUPLING NUT, SHELLS, BODY, CENTER CONTACTS: BRASS
GASKET: SILICONE
C-RING 2: STAINLESS STEEL
C-RING 1: BeCu
INSULATOR: PTFE

DESCRIPTION: N TYPE ST PLUG TO MMCX ST PLUG ADAPTER, 75 OHM

DWG. NO. ADP7-76SP2-73SP1

BY: DUKES Z 01/19/2012 SHEET 1 OF 1