

DO NOT SCALE FROM THIS PRINT

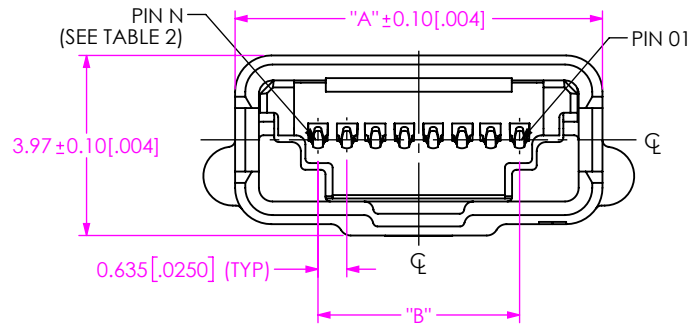

(KAPTON PAD NOT SHOWN FOR CLARITY)

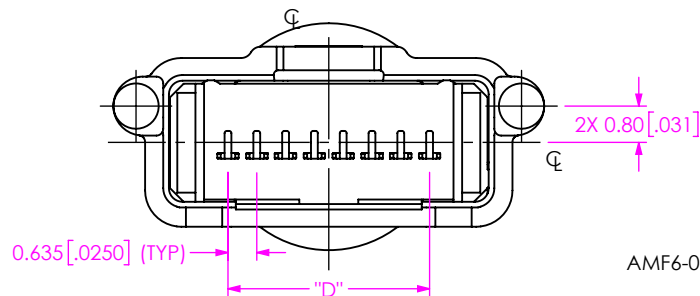
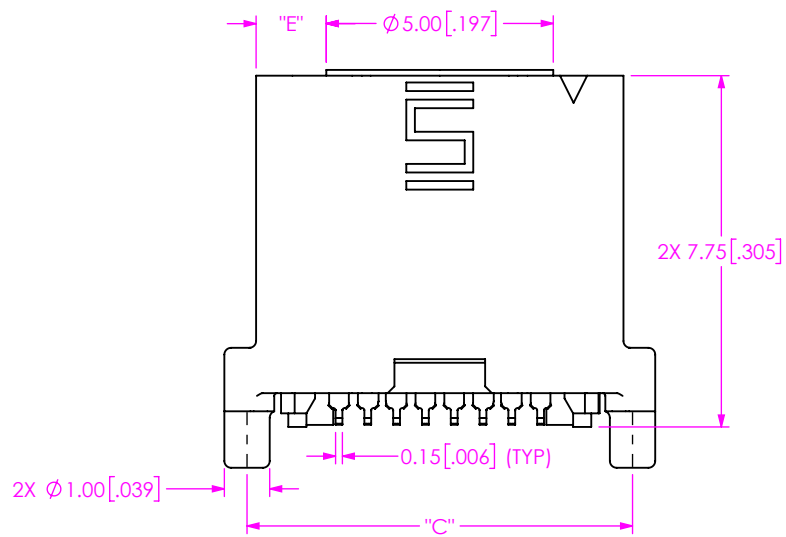

FIG 1
AMF6-02-S-K-XR SHOWN

No OF PAIRS (TOTAL)
-01, -02

TAPE & REEL (SEE NOTES 2 & 3)
-TR: TAPE & REEL
-FR: FULL REEL QTY TAPE & REEL

KAPTON PAD

PLATING SPECIFICATION
-S: 30μ" SELECTIVE GOLD
IN CONTACT AREA,
MATTE TIN ON TAIL

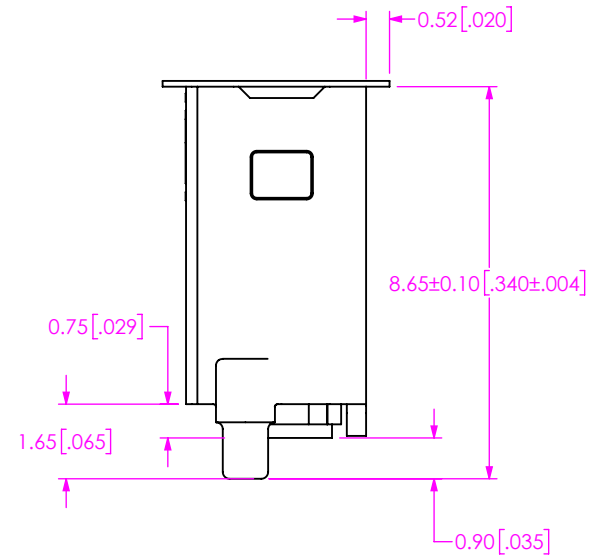
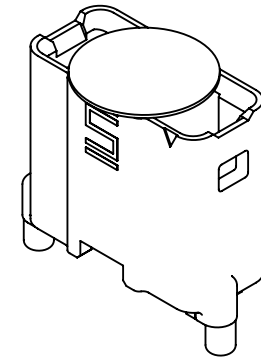

No OF PAIRS	N
-01	04
-02	08

No OF PAIRS	"A"	"B"	"C"	"D"	"E"
-01	5.56 [0.219]	1.91 [0.075]	5.96 [0.235]	1.91 [0.075]	0.28 [0.011]
-02	8.10 [0.319]	4.45 [0.175]	8.50 [0.335]	4.45 [0.175]	1.55 [0.061]

- NOTES:
1. KAPTON PAD PROVIDED AS STANDARD.
 2. ORDERS WILL BE PACKAGED ACCORDING TO THE SAMTEC PACKAGING EFFICIENCY STANDARDS (SPES) FOUND ON WWW.SAMTEC.COM.
 3. ATTACH LABEL-4X2 TO EACH REEL.

PROPRIETARY NOTE
THIS DOCUMENT CONTAINS CONFIDENTIAL AND PROPRIETARY INFORMATION AND ALL DESIGN, MANUFACTURING, REPRODUCTION, USE, PATENT RIGHTS AND SALES RIGHTS ARE EXPRESSLY RESERVED BY SAMTEC, INC. THIS DOCUMENT SHALL NOT BE DISCLOSED, IN WHOLE OR PART, TO ANY UNAUTHORIZED PERSON OR ENTITY NOR REPRODUCED, TRANSFERRED OR INCORPORATED IN ANY OTHER PROJECT IN ANY MANNER WITHOUT THE EXPRESS WRITTEN CONSENT OF SAMTEC, INC.

DO NOT SCALE DRAWING
SHEET SCALE: 6:1

MATERIAL:
INSULATOR: LCP, COLOR: BLACK
CONTACT: COPPER ALLOY
SHIELD: ZAMAK

DESCRIPTION:
AMF6 ASSEMBLY

DWG. NO.
AMF6-XX-X-K-XR

BY: EVE L 01/20/2022 SHEET 1 OF 1



520 PARK EAST BLVD, NEW ALBANY, IN 47150
PHONE: 812-944-6733 FAX: 812-948-5047
e-Mail info@SAMTEC.com code 55322