

NOTES:

1. ITEMS -1, -2, & -3 NOT AVAILABLE AS STANDARD. CUSTOM FOR VARIATION OF VITA 42 XMC STANDARD.
2. Ⓢ REPRESENTS A CRITICAL DIMENSION.
3. MAXIMUM BURR ALLOWANCE: .0015[0.038]
4. MAXIMUM CUT FLASH: .010[0.25]
5. MINIMUM PUSHOUT FORCE: .5 LB
6. MAXIMUM ALLOWABLE BOW; TOP/BOTTOM: .004[0.10], SIDE/SIDE: .003[0.08] Ⓢ
7. PARTS TO BE PACKAGED IN TAPE & REEL. FOR QUANTITIES THAN 125 PIECES, NO TRAILER OR LEADER WILL BE SUPPLIED
8. NOTE DELETED.

DO NOT SCALE FROM THIS PRINT

ANY REV MADE TO THIS PRINT MUST HAVE AN UPDATED MKT PRINT

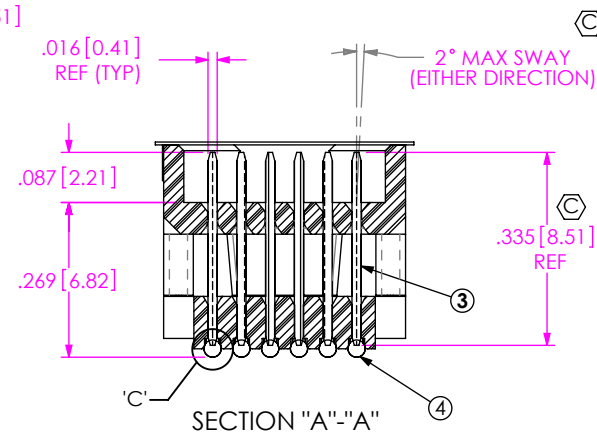
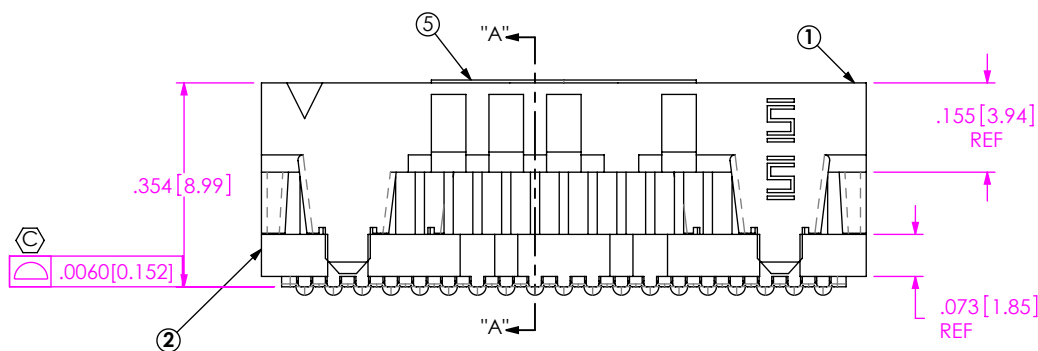
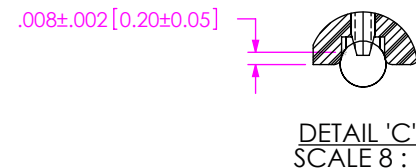
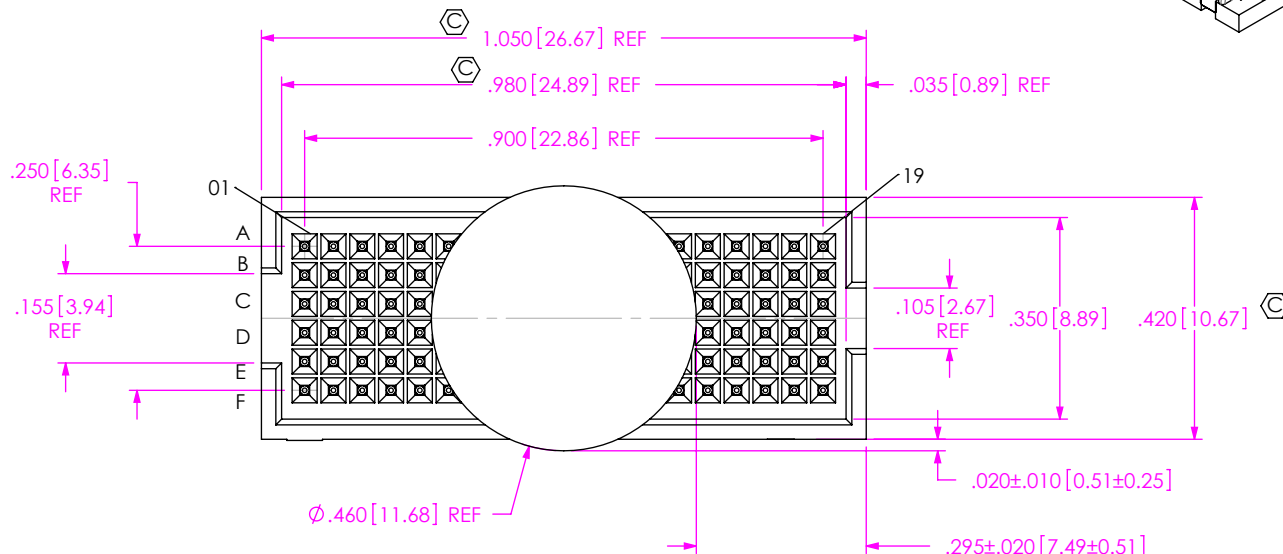
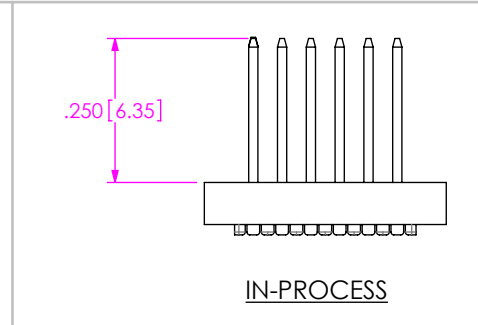
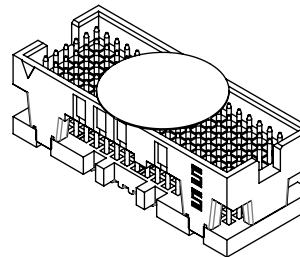

ITEM NO.	PART NUMBER	QUANTITY	MATERIAL
1	ASP-144052-03-B	1.0000	LCP,UL 94 V0, COLOR: BLACK
2	ASP-103599-01-B	1.0000	LCP,UL 94 V0, COLOR: BLACK
3	ASP-102056-02-P-H	114.00	BRASS ALLOY 260, 3/4 HARD
4	SBD-030-6337	114.00	63% TIN /37% LEAD
5	K-850-650	1.0000	POLYIMIDE FILM
6	CT-ASP1134MS	.00571	CONDUCTIVE POLYMER

UNLESS OTHERWISE SPECIFIED, DIMENSIONS ARE IN INCHES. TOLERANCES ARE:  
 DECIMALS ANGLES  
 .XX: ±.01 2°  
 .XXX: ±.005  
 .XXXX: ±.0020

**PROPRIETARY NOTE**  
 THIS DOCUMENT CONTAINS INFORMATION CONFIDENTIAL AND PROPRIETARY TO SAMTEC, INC. AND SHALL NOT BE REPRODUCED OR TRANSFERRED TO OTHER DOCUMENTS OR DISCLOSED TO OTHERS OR USED FOR ANY PURPOSE OTHER THAN THAT WHICH IT WAS OBTAINED WITHOUT THE EXPRESSED WRITTEN CONSENT OF SAMTEC, INC.



520 PARK EAST BLVD, NEW ALBANY, IN 47150  
 PHONE: 812-944-6733 FAX: 812-948-5047  
 e-Mail: info@SAMTEC.com code 55322

DESCRIPTION: VITA 42 10MM SOCKET ASSEMBLY  
 DWG. NO. ASP-103614-16  
 BY: J. BROWNING 07/27/2009 SHEET 1 OF 2

DO NOT SCALE DRAWING SHEET SCALE: 3:1  
 PLATING: CONTACT AREA: .000030 GOLD OVER .000050 NICKEL  
 REMAINDER: .000003 GOLD OVER .000050 NICKEL  
 C:\EnterpriseVault\DWG\MISC\MKTG\ASP-103614-16-MKT.SLDDRW

RECOMMENDED BOARD LAYOUT

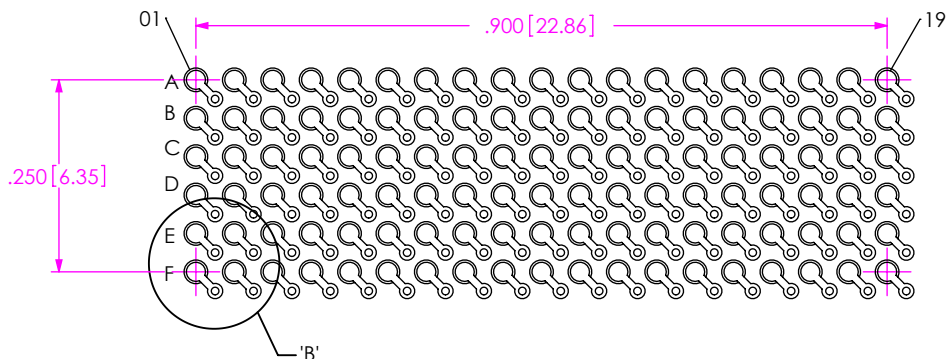

RECOMMENDED STENCIL LAYOUT  
STENCIL TO BE .0006[0.152] THICK

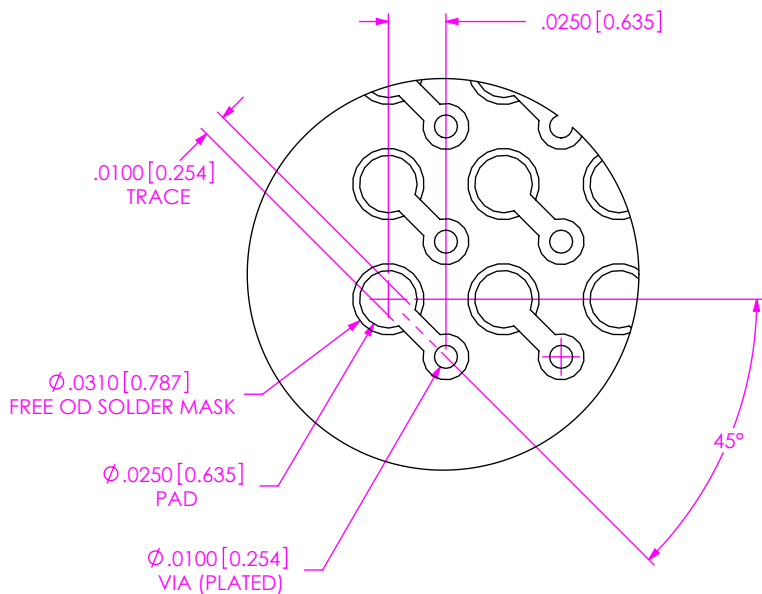
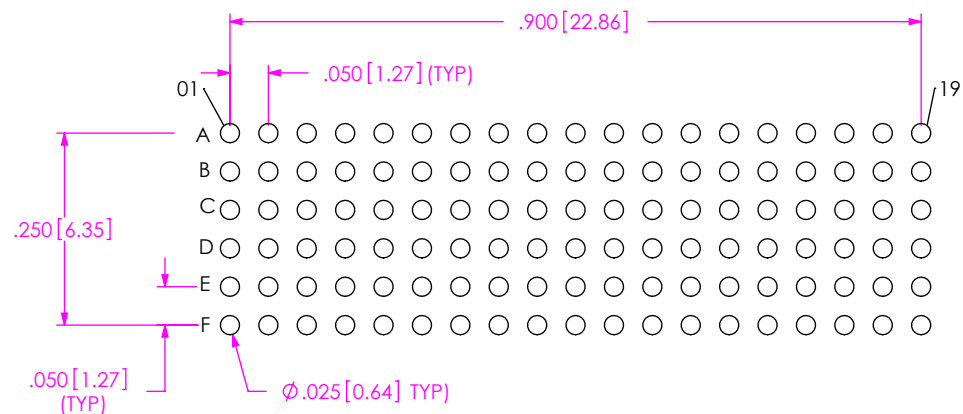

DETAIL 'B'  
SCALE 12:1

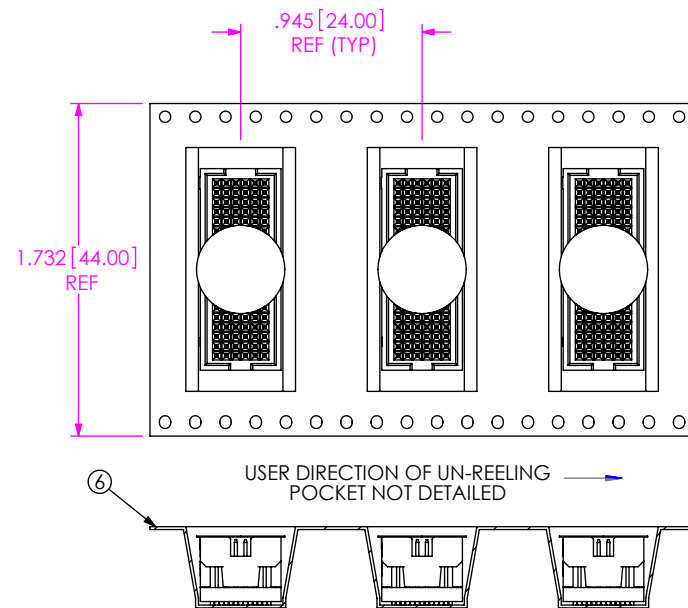

PACKAGING VIEW  
SCALE 1:1

PROPRIETARY NOTE

THIS DOCUMENT CONTAINS INFORMATION CONFIDENTIAL AND PROPRIETARY TO SAMTEC, INC. AND SHALL NOT BE REPRODUCED OR TRANSFERRED TO OTHER DOCUMENTS OR DISCLOSED TO OTHERS OR USED FOR ANY PURPOSE OTHER THAN THAT WHICH IT WAS OBTAINED WITHOUT THE EXPRESSED WRITTEN CONSENT OF SAMTEC, INC.



520 PARK EAST BLVD, NEW ALBANY, IN 47150  
PHONE: 812-944-6733 FAX: 812-948-5047  
e-Mail info@SAMTEC.com code 55322

SHEET SCALE: 4:1

DESCRIPTION:  
VITA 42 10MM SOCKET ASSEMBLY

DWG. NO.  
ASP-103614-16

BY: J. BROWNING 07/27/2009 SHEET 2 OF 2