

REVISION G

DO NOT SCALE FROM THIS PRINT

- NOTES:  
 1. ITEMS -1, -2, & -3 NOT AVAILABLE AS STANDARD. CUSTOM FOR VARIATION OF VITA 42 XMC STANDARD.  
 2. Ⓢ REPRESENTS A CRITICAL DIMENSION.  
 3. MAXIMUM BURR ALLOWANCE: .0015[0.038]  
 4. MAXIMUM CUT FLASH: .010[0.25]  
 5. MINIMUM PUSHOUT FORCE: .5 LB.  
 6. MAXIMUM ALLOWABLE BOW: TOP/BOTTOM: .004[0.10], SIDE/SIDE: .003[0.08] Ⓢ  
 7. PARTS TO BE PACKAGED IN TAPE & REEL. FOR QUANTITIES LESS THAN 125 PIECES, NO TRAILER OR LEADER WILL BE SUPPLIED.  
 8. LEAD FREE SOLDER BALLS.

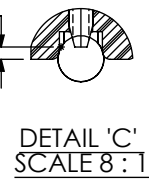
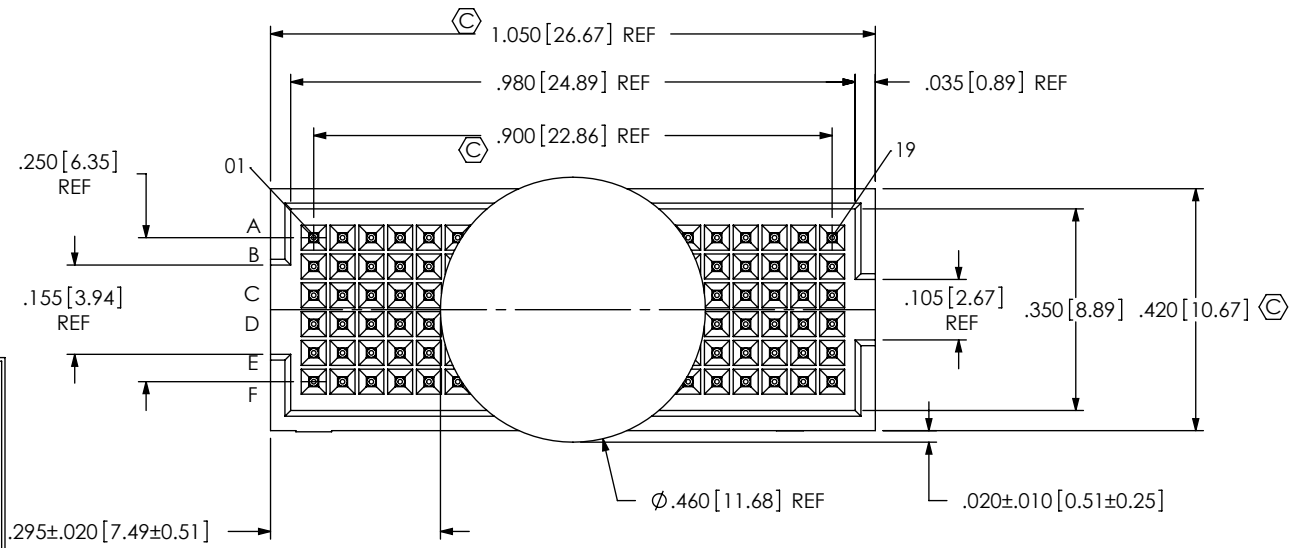
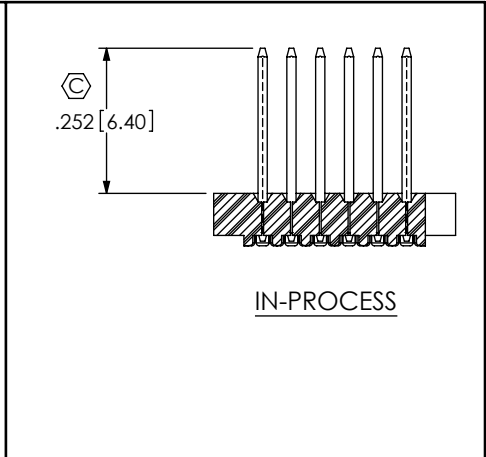
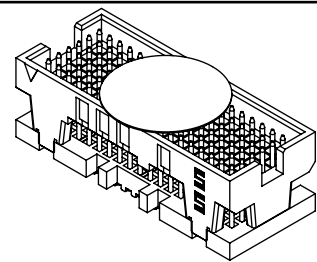

BY SIGNING THIS DOCUMENT YOU ARE ACCEPTING THE CONDITIONS SET WITHIN. YOUR REQUIREMENTS MUST BE LISTED WITHIN THIS DRAWING. WHERE NO DIRECTION FROM THE CUSTOMER IS IDENTIFIED SAMTEC'S PROCESS REQUIREMENTS WILL BE USED.

DATE: \_\_\_\_\_  
 COMPANY: \_\_\_\_\_  
 CUSTOMER SIGNATURE: \_\_\_\_\_  
 PRINTED NAME: \_\_\_\_\_  
 PHONE NO.: \_\_\_\_\_  
 EXCEPTIONS: \_\_\_\_\_

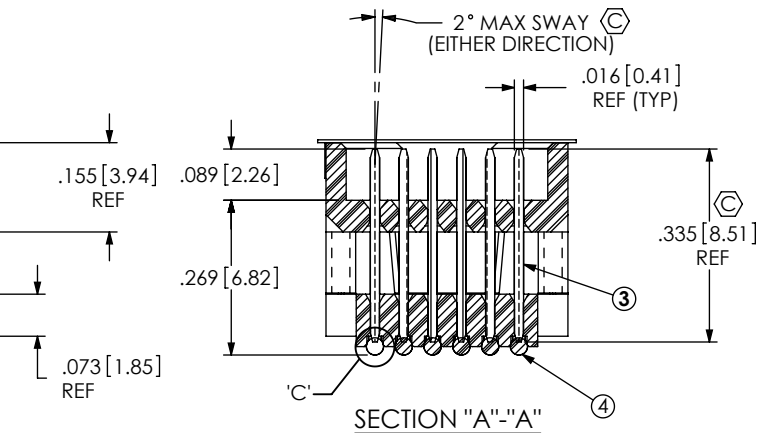
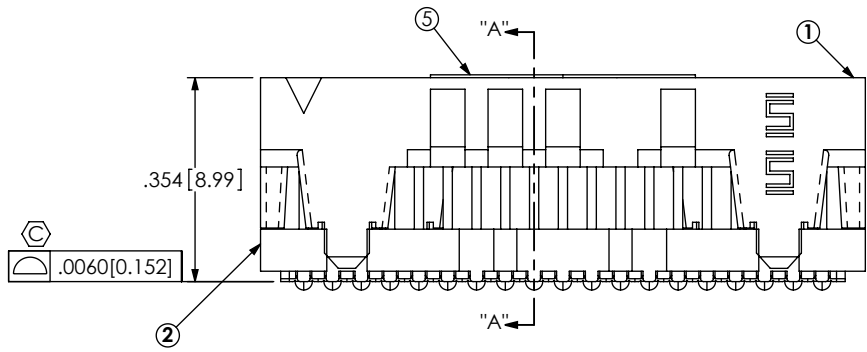

ITEM NO.	PART NUMBER	QUANTITY	MATERIAL
1	ASP-144052-03-B	1.0000	LCP, UL 94 V0, COLOR: BLACK
2	ASP-103599-01-B	1.0000	LCP, UL 94 V0, COLOR: BLACK
3	ASP-102056-02-P-H	114.00	BRASS ALLOY 260, 3/4 HARD
4	SBD-030-9653	114.00	96.5% TIN /3% SILVER/.5% COPPER
5	K-850-650	1.0000	POLYIMIDE FILM
6	CT-ASP1134MS	.00571	CONDUCTIVE POLYMER

NON STANDARD	UNLESS OTHERWISE SPECIFIED, DIMENSIONS ARE IN INCHES. TOLERANCES ARE: DECIMALS ANGLES .XX: ±.01 .XXX: ±.005 .XXXX: ±.0020	PROPRIETARY NOTE THIS DOCUMENT CONTAINS INFORMATION CONFIDENTIAL AND PROPRIETARY TO SAMTEC, INC. AND SHALL NOT BE REPRODUCED OR TRANSFERRED TO OTHER DOCUMENTS OR DISCLOSED TO OTHERS OR USED FOR ANY PURPOSE OTHER THAN THAT WHICH IT WAS OBTAINED WITHOUT THE EXPRESSED WRITTEN CONSENT OF SAMTEC, INC.
COMPONENT	X	DO NOT SCALE DRAWING SHEET SCALE: 3:1
ASSEMBLY		PLATING: CONTACT AREA: .000030 MIN GOLD OVER .000050 MIN NICKEL REMAINDER: .000003 MIN GOLD OVER .000050 MIN NICKEL
TOOLING		
PROCESS		
PACKAGING		
OTHER		

**samtec**

520 PARK EAST BLVD, NEW ALBANY, IN 47150  
 PHONE: 812-944-6733 FAX: 812-948-5047  
 e-Mail: info@SAMTEC.com code 55322

DESCRIPTION:  
**VITA 42 (LEAD FREE) SOCKET ASSEMBLY**

DWG. NO. **ASP-103614-17**

BY: J. BROWNING 07/27/2009 SHEET 1 OF 2

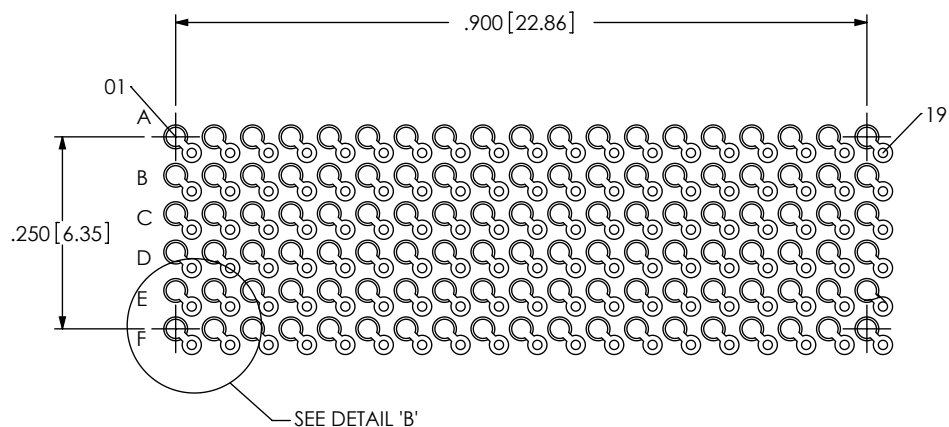

RECOMMENDED STENCIL LAYOUT  
STENCIL TO BE .0006[0.152] THICK

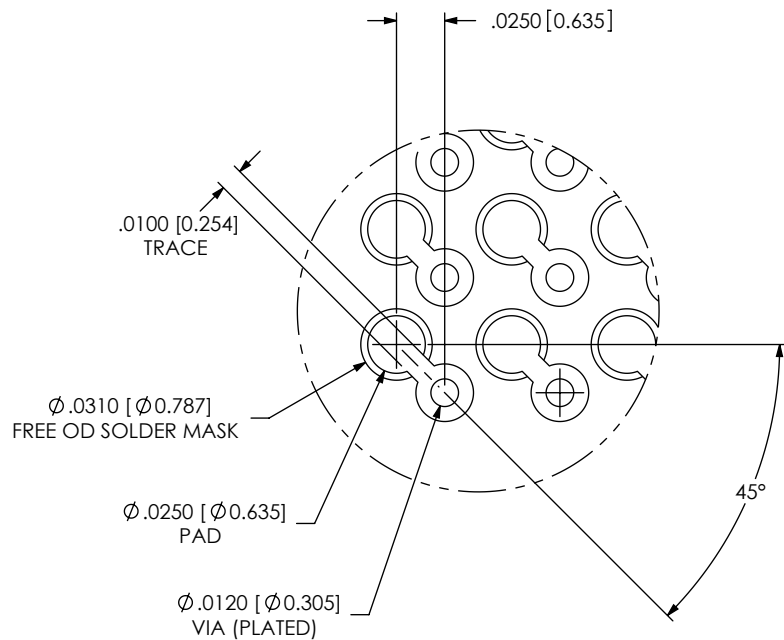
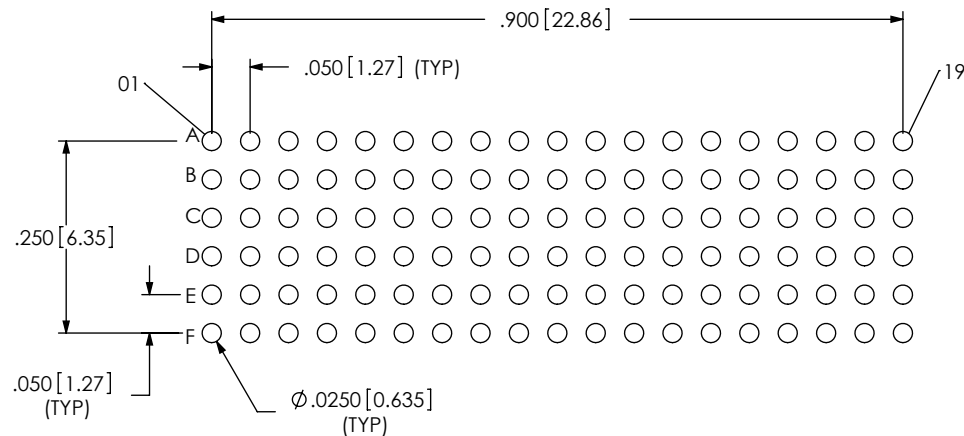

DETAIL 'B'

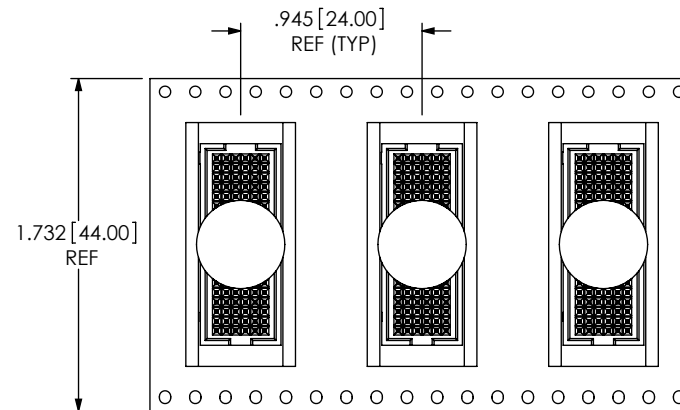

USER DIRECTION OF UN-REELING →  
POCKET NOT DETAILED

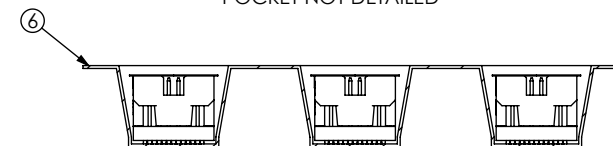

PACKAGING VIEW

PROPRIETARY NOTE

THIS DOCUMENT CONTAINS INFORMATION CONFIDENTIAL AND PROPRIETARY TO SAMTEC, INC. AND SHALL NOT BE REPRODUCED OR TRANSFERRED TO OTHER DOCUMENTS OR DISCLOSED TO OTHERS OR USED FOR ANY PURPOSE OTHER THAN THAT WHICH IT WAS OBTAINED WITHOUT THE EXPRESSED WRITTEN CONSENT OF SAMTEC, INC.



520 PARK EAST BLVD, NEW ALBANY, IN 47150  
PHONE: 812-944-6733 FAX: 812-948-5047  
e-Mail: info@SAMTEC.com code 55322

SHEET SCALE: 3:1

DESCRIPTION:  
VITA 42 (LEAD FREE) SOCKET ASSEMBLY

DWG. NO.  
ASP-103614-17