

DO NOT SCALE FROM THIS PRINT

- NOTES:
 1. CONTACT CONFIGURATION NOT AVAILABLE AS STANDARD.
 2. Ⓢ REPRESENTS A CRITICAL DIMENSION.
 3. MAXIMUM BURR ALLOWANCE: 0.038 [.0015].
 4. MINIMUM PUSHOUT FORCE: 2.22N [.5 LB].
 5. PARTS TO BE PACKAGED IN TRAYS.

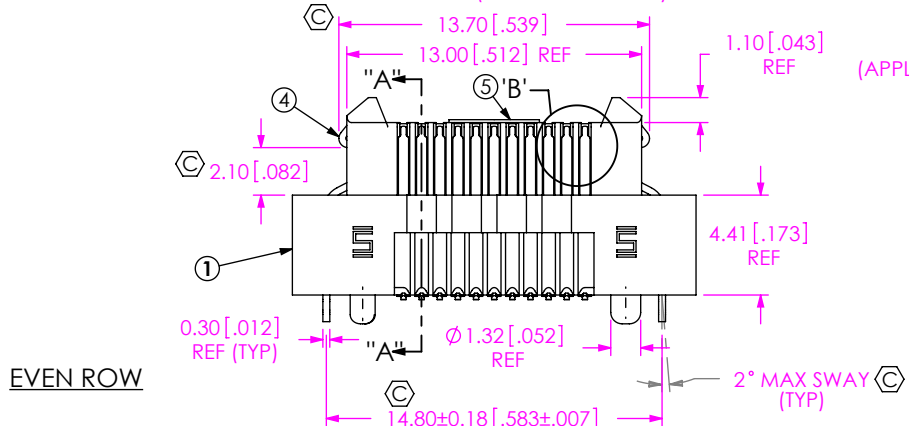
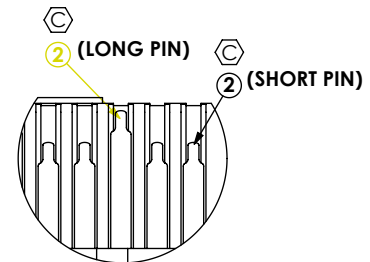
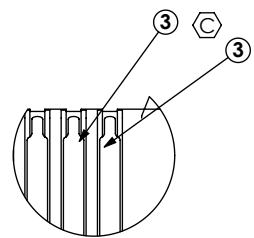
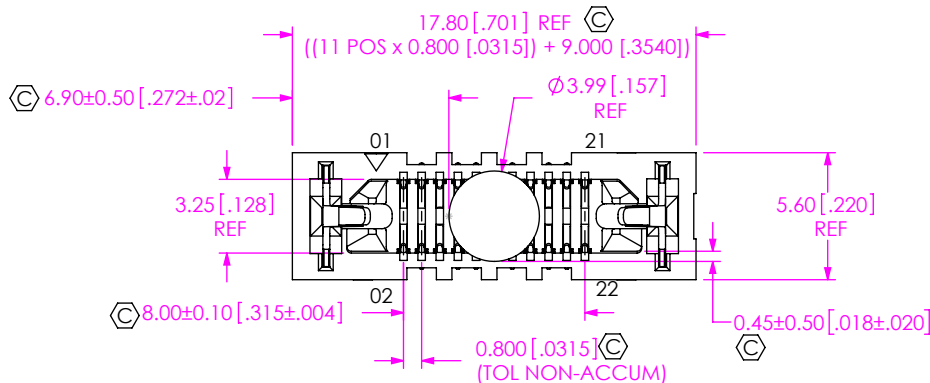

0.64 [.025] REF (APPLIES TO ALL OTHER SIGNALS)

1.34 [.053] REF (APPLIES TO -DP SIGNALS)

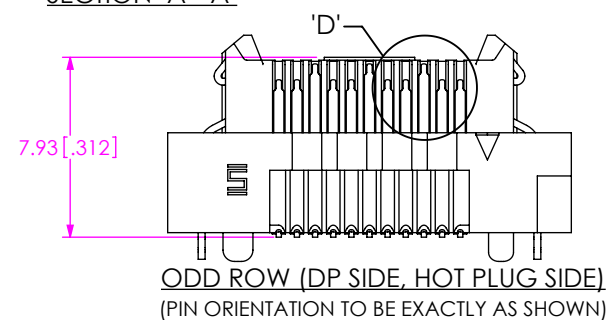
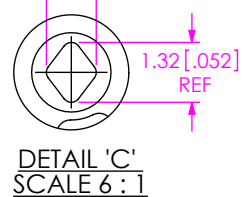
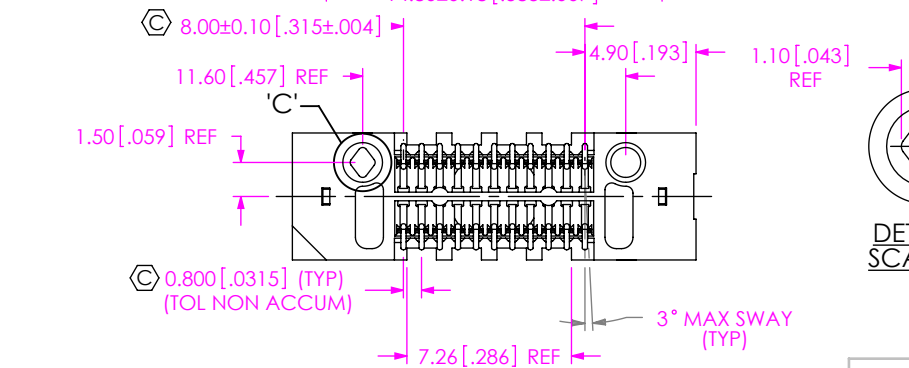
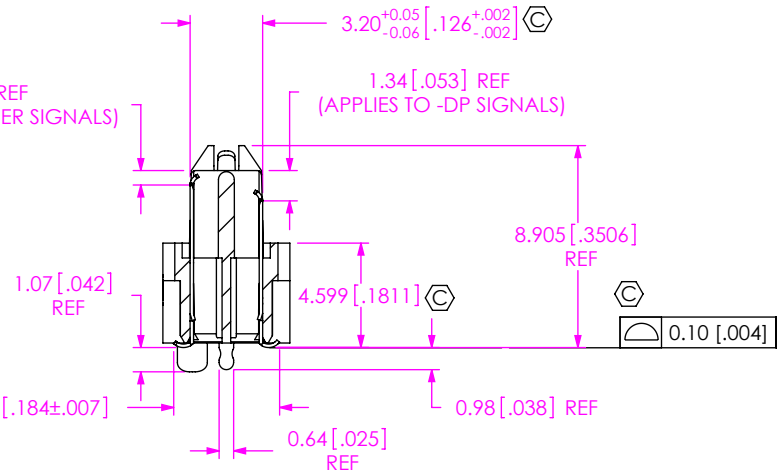

ITEM NO.	PART NUMBER	QUANTITY	MATERIAL
1	ERM8-011-05.0-DV-L	1.00000	VECTRA E130i, COLOR: BLACK
2	T-1M48-05.0-S	11.00000	PHOS BRONZE, 521 HARD TEMPER
3	T-1M37-05.0	11.00000	PHOS BRONZE, 521 HARD TEMPER
4	WT-29-03-F	2.00000	BeCu #25, 1/2 HT
5	K-DOT-.157-.250-.005	1.00000	POLYIMIDE FILM
6	TY-ERM8057-11-5-L	1.00000	BLACK HIPS

UNLESS OTHERWISE SPECIFIED, DIMENSIONS ARE IN INCHES.
 TOLERANCES ARE:
 DECIMALS ANGLES
 .X: ±0.3[.01] 2°
 .XX: ±0.13[.005]
 .XXX: ±0.051[.0020]

PROPRIETARY NOTE
 THIS DOCUMENT CONTAINS CONFIDENTIAL AND PROPRIETARY INFORMATION AND ALL DESIGN, MANUFACTURING, REPRODUCTION, USE, PATENT RIGHTS AND SALES RIGHTS ARE EXPRESSLY RESERVED BY SAMTEC, INC. THIS DOCUMENT SHALL NOT BE DISCLOSED, IN WHOLE OR PART, TO ANY UNAUTHORIZED PERSON OR ENTITY NOR REPRODUCED, TRANSFERRED OR INCORPORATED IN ANY OTHER PROJECT IN ANY MANNER WITHOUT THE EXPRESS WRITTEN CONSENT OF SAMTEC, INC.



520 PARK EAST BLVD, NEW ALBANY, IN 47150
 PHONE: 812-944-6733 FAX: 812-948-5047
 e-Mail: info@SAMTEC.com code: 55322

DO NOT SCALE DRAWING SHEET SCALE: 3:1
 PLATING:
 CONTACT AREA: .000030 GOLD OVER .000050 NICKEL
 REMAINDER: .000200 REF TIN OVER .000050 NICKEL
 LATCHES: .000003 GOLD OVER .000050 NICKEL

DESCRIPTION: MODIFIED ERM8 ASSEMBLY
 DWG. NO. ASP-137968-01
 BY: David F 01/24/2008 SHEET 1 OF 2

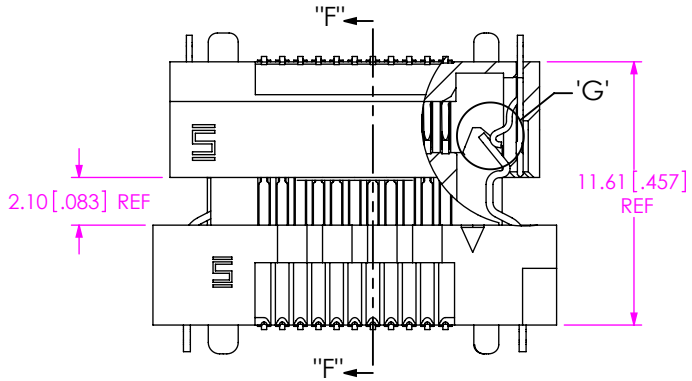

LATCH ENGAGING VIEW

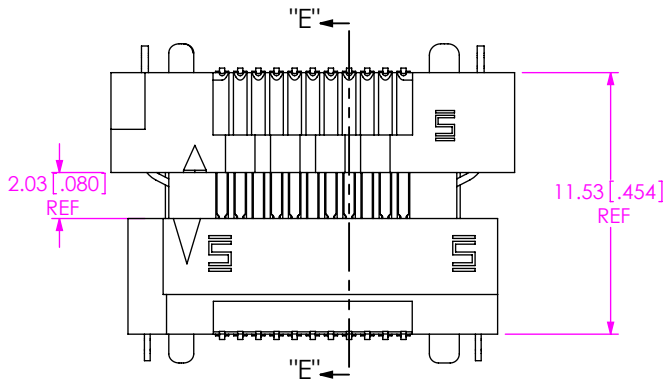

PIN ENGAGING VIEW

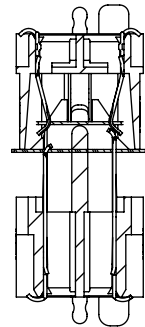

SECTION "F"-"F"

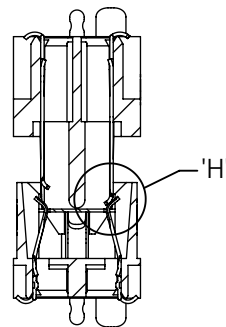

SECTION "E"-"E"

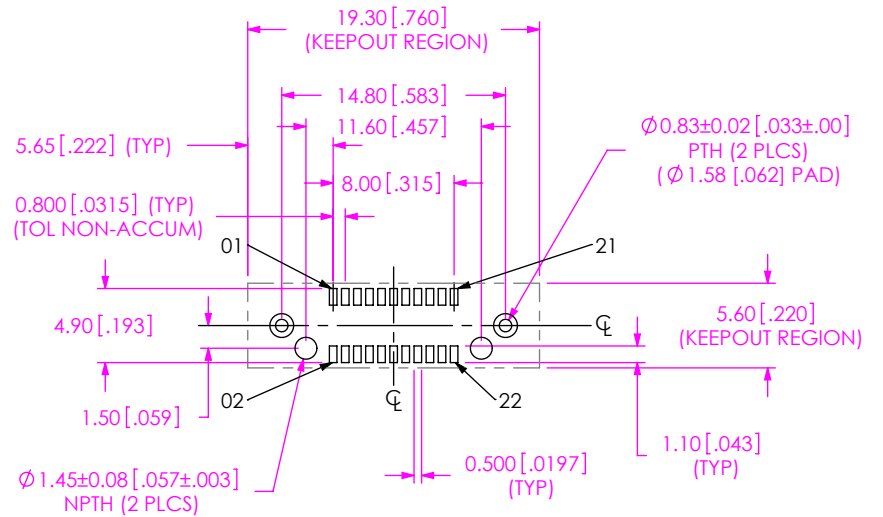

RECOMMENDED PCB LAYOUT

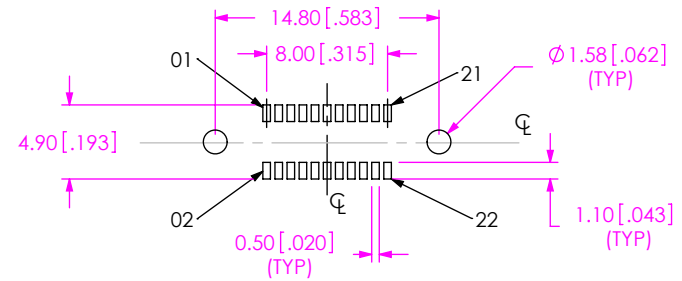

RECOMMENDED STENCIL LAYOUT

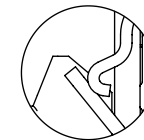

DETAIL 'G'
SCALE 6 : 1

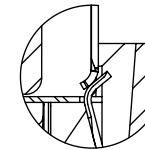

DETAIL 'H'
SCALE 6 : 1

<p>PROPRIETARY NOTE</p> <p>THIS DOCUMENT CONTAINS CONFIDENTIAL AND PROPRIETARY INFORMATION AND ALL DESIGN, MANUFACTURING, REPRODUCTION, USE, PATENT RIGHTS AND SALES RIGHTS ARE EXPRESSLY RESERVED BY SAMTEC, INC. THIS DOCUMENT SHALL NOT BE DISCLOSED, IN WHOLE OR PART, TO ANY UNAUTHORIZED PERSON OR ENTITY NOR REPRODUCED, TRANSFERRED OR INCORPORATED IN ANY OTHER PROJECT IN ANY MANNER WITHOUT THE EXPRESS WRITTEN CONSENT OF SAMTEC, INC.</p>			
	<p>SHEET SCALE: 3:1</p>	<p>DESCRIPTION: MODIFIED ERM8 ASSEMBLY</p> <p>DWG. NO. ASP-137968-01</p>	
<p>F:\DWG\MISC\MKTG\ASP-137968-01-MKT.SLDDRW</p>		<p>BY: David F 01/24/2008</p>	<p>SHEET 2 OF 2</p>