

NOTES:

1. CONTACT CONFIGURATION NOT AVAILABLE AS STANDARD.
2. Ⓢ REPRESENTS A CRITICAL DIMENSION.
3. MAXIMUM BURR ALLOWANCE: 0.038 [.0015]
4. MINIMUM PUSHOUT FORCE: 2.22N [.5 LB]
5. PARTS TO BE PACKAGED IN TRAYS.

DESIGNED & DIMENSIONED  
IN MILLIMETERS [INCHES]

DO NOT  
SCALE FROM  
THIS PRINT

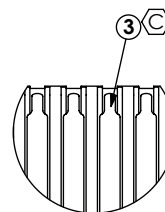
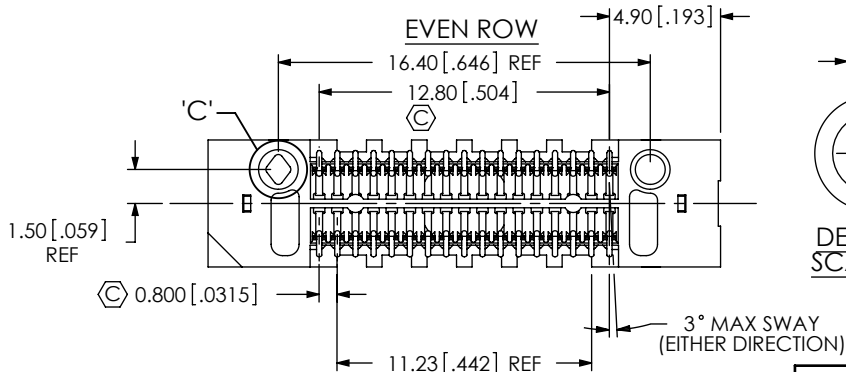
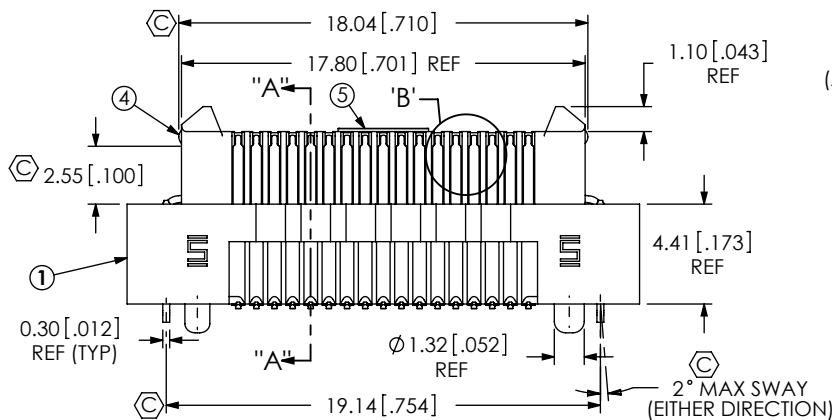
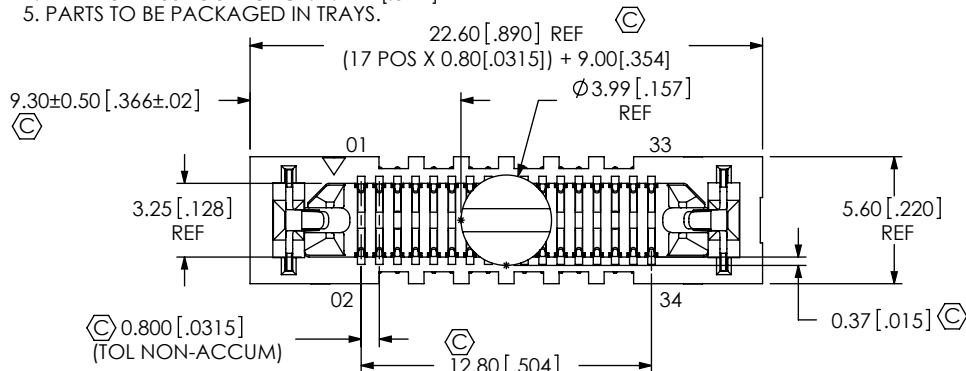

DETAIL 'B'  
SCALE 6 : 1  
SE SIDE

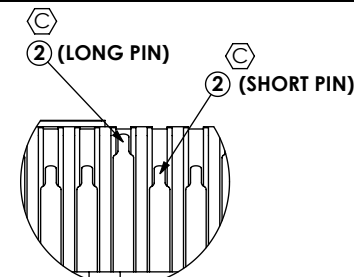

DETAIL 'D'  
SCALE 6 : 1  
DP SIDE

0.64 [.025] REF  
(APPLIES TO ALL OTHER SIGNALS)

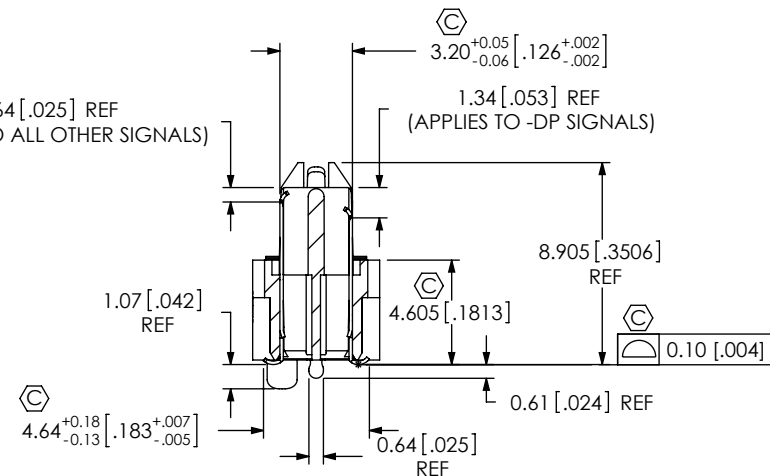

SECTION "A"-A

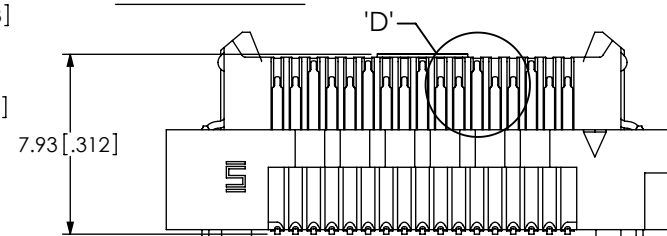

ODD ROW (DP SIDE, HOT PLUG SIDE)  
(PIN ORIENTATION TO BE EXACTLY AS SHOWN)

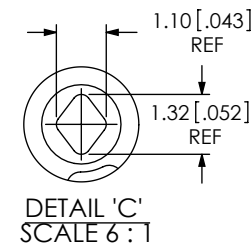

DETAIL 'C'  
SCALE 6 : 1

UNLESS OTHERWISE SPECIFIED,  
DIMENSIONS ARE IN MILLIMETERS.  
TOLERANCES ARE:  
DECIMALS ANGLES  
.X: ±.3[.01] 2°  
.XX: ±.13[.005]  
.XXX: ±.051[.0020]

PROPRIETARY NOTE

THIS DOCUMENT CONTAINS INFORMATION  
CONFIDENTIAL AND PROPRIETARY TO  
SAMTEC, INC. AND SHALL NOT BE REPRODUCED  
OR TRANSFERRED TO OTHER DOCUMENTS OR  
DISCLOSED TO OTHERS OR USED FOR ANY  
PURPOSE OTHER THAN THAT WHICH IT WAS  
OBTAINED WITHOUT THE EXPRESSED WRITTEN  
CONSENT OF SAMTEC, INC.



520 PARK EAST BLVD, NEW ALBANY, IN 47150  
PHONE: 812-944-6733 FAX: 812-948-5047  
e-Mail: info@SAMTEC.com code 53322

DO NOT SCALE DRAWING SHEET SCALE: 3:1

PLATING:  
CONTACT AREA: .000030 GOLD OVER .000050 NICKEL  
REMAINDER: .000200 REF TIN OVER .000050 NICKEL  
LATCHES: .000003 GOLD OVER .000050 NICKEL

DESCRIPTION:

MODIFIED ERM8 ASSEMBLY

DWG. NO.

ASP-137972-01

BY: David F

01/24/2008

SHEET 1 OF 2

ITEM NO.	PART NUMBER	QUANTITY	MATERIAL
1	ASP-136453-03-B	1.0000	VECTRA E130i, COLOR: BLACK
2	T-1M48-05.0-S	17.0000	PHOS BRONZE, 521 HARD TEMPER
3	T-1M37-05.0	17.0000	PHOS BRONZE, 521 HARD TEMPER
4	WT-29-03-F	2.0000	BeCu #25, 1/2 HT
5	K-DOT-.157-.250-.005	1.0000	POLYIMIDE FILM
6	TY-ASP121	1.0000	BLACK HIPS

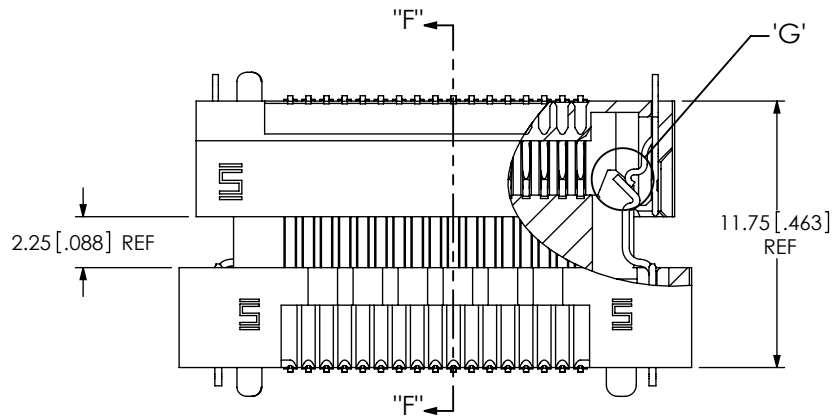

LATCH ENGAGING VIEW

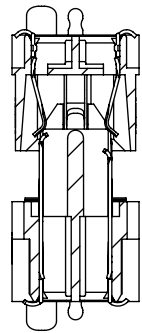

SECTION "F"-"F"

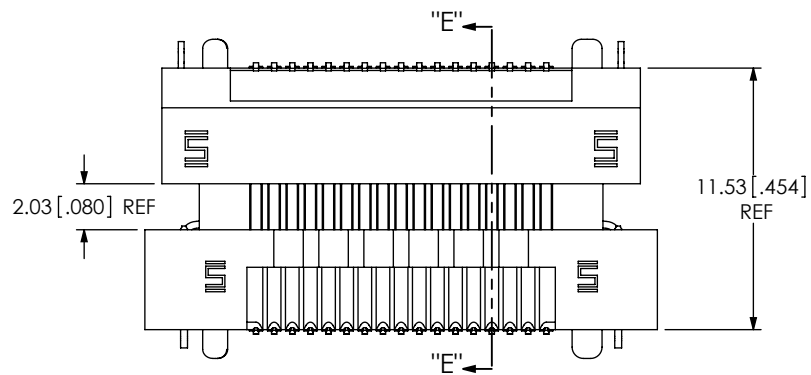

PIN ENGAGING VIEW

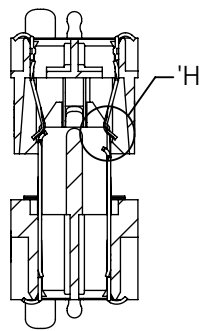

SECTION "E"-"E"

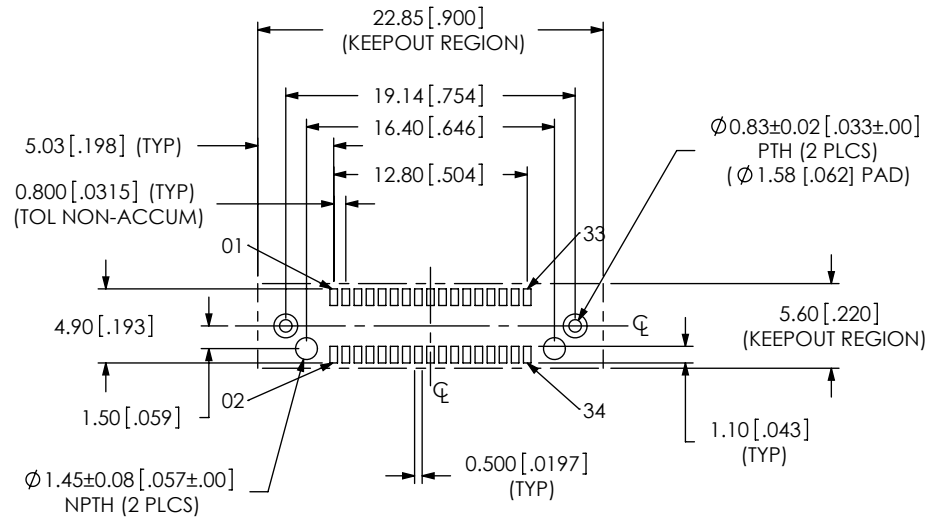

RECOMMENDED PCB LAYOUT

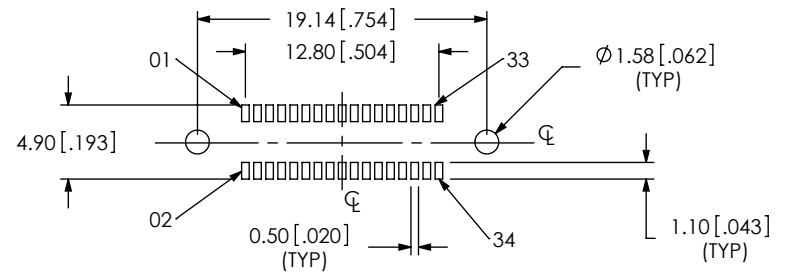

RECOMMENDED STENCIL LAYOUT

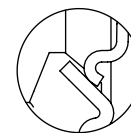

DETAIL 'G'  
SCALE 6 : 1

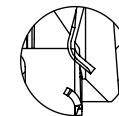

DETAIL 'H'  
SCALE 6 : 1

PROPRIETARY NOTE

THIS DOCUMENT CONTAINS INFORMATION CONFIDENTIAL AND PROPRIETARY TO SAMTEC, INC. AND SHALL NOT BE REPRODUCED OR TRANSFERRED TO OTHER DOCUMENTS OR DISCLOSED TO OTHERS OR USED FOR ANY PURPOSE OTHER THAN THAT WHICH IT WAS OBTAINED WITHOUT THE EXPRESSED WRITTEN CONSENT OF SAMTEC, INC.



520 PARK EAST BLVD, NEW ALBANY, IN 47150  
PHONE: 812-944-6733 FAX: 812-948-5047  
e-Mail info@SAMTEC.com code 53322

SHEET SCALE: 3:1

DESCRIPTION:

MODIFIED ERM8 ASSEMBLY

DWG. NO.

ASP-137972-01