

- NOTES:
 1. CUSTOM BODY IS NOT AVAILABLE AS STANDARD.
 2. MINIMUM PUSHOUT FORCE: .50 LBS
 3. NOTE DELETED.
 4. NOTE DELETED.
 5. PARTS TO BE PACKAGED IN TAPE & REEL.
 ATTACH LABEL "SEAX-0001" TO EACH TAPE & REEL PACKAGING.
 6. ORDERS WILL BE PACKAGED ACCORDING TO THE SAMTEC PACKAGING EFFICIENCY STANDARDS (SPES) FOUND ON WWW.SAMTEC.COM.
 7. ATTACH LABEL -4X2 TO EACH REEL.

DESIGNED AND DIMENSIONED IN INCHES[MILLIMETERS]
 ALL DIMENSIONS REFERENCE EXCEPT AS SHOWN



DO NOT SCALE FROM THIS PRINT

BY SIGNING THIS DOCUMENT YOU ARE ACCEPTING THE CONDITIONS SET WITHIN. YOUR REQUIREMENTS MUST BE LISTED WITHIN THIS DRAWING. WHERE NO DIRECTION FROM THE CUSTOMER IS IDENTIFIED SAMTEC'S PROCESS REQUIREMENTS WILL BE USED.

DATE: _____
 COMPANY: _____
 CUSTOMER SIGNATURE: _____
 PRINTED NAME: _____
 PHONE No.: _____
 EXCEPTIONS: _____

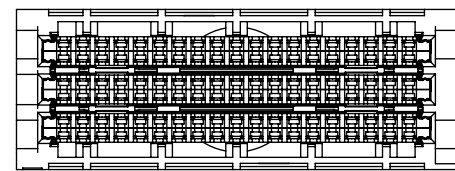
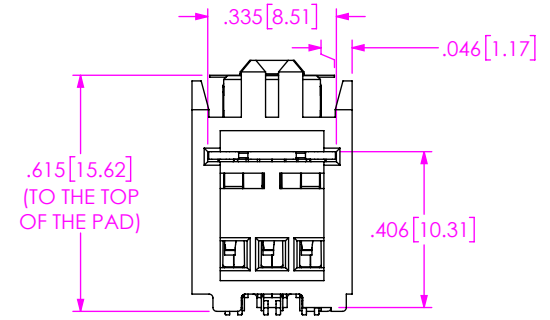
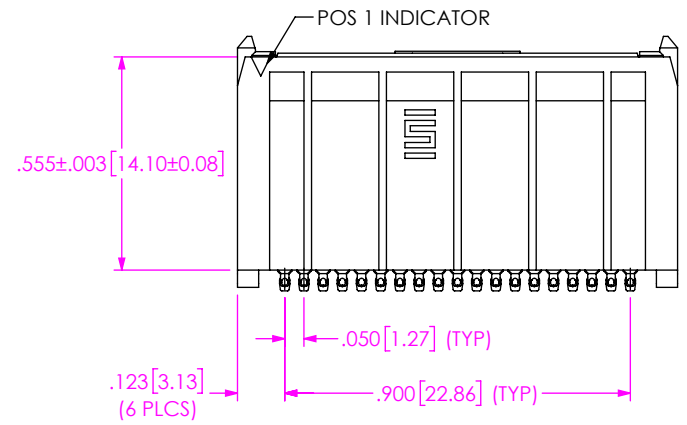
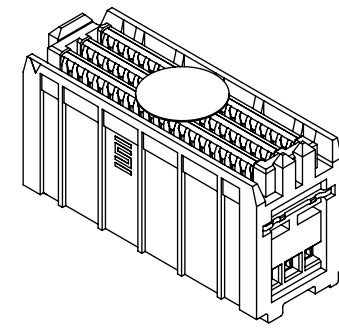
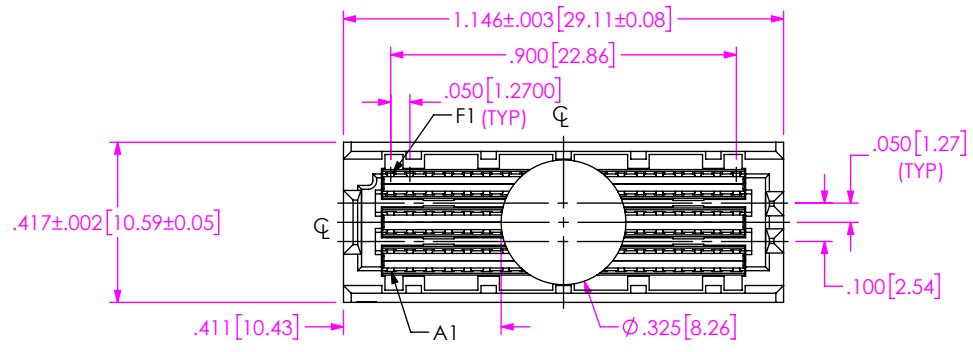

<p>PROPRIETARY NOTE THIS DOCUMENT CONTAINS CONFIDENTIAL AND PROPRIETARY INFORMATION AND ALL DESIGN, MANUFACTURING, REPRODUCTION, USE, PATENT RIGHTS AND SALES RIGHTS ARE EXPRESSLY RESERVED BY SAMTEC, INC. THIS DOCUMENT SHALL NOT BE DISCLOSED, IN WHOLE OR PART, TO ANY UNAUTHORIZED PERSON OR ENTITY NOR REPRODUCED, TRANSFERRED OR INCORPORATED IN ANY OTHER PROJECT IN ANY MANNER WITHOUT THE EXPRESS WRITTEN CONSENT OF SAMTEC, INC.</p>		<p>520 PARK EAST BLVD., NEW ALBANY, IN 47150 PHONE: 812-944-6733 FAX: 812-948-5047 e-Mail info@SAMTEC.com code 55322</p>	
<p>DO NOT SCALE DRAWING SHEET SCALE: 2:1</p>		<p>DESCRIPTION: VITA88 MODIFIED SEAM ASM</p>	
<p>MATERIAL: INSULATOR: LCP, COLOR: BLACK, UL 94 V-0 TERMINAL: COPPER ALLOY PLATING: CONTACT AREA: .000030 GOLD OVER .000050 NICKEL REMAINDER: .000200 REF TIN OVER .000050 NICKEL SOLDER COMPOSITION: 95.5% TIN / 3.8% SILVER / 0.7% COPPER CHARGE TAIL</p>		<p>DWG. NO. ASP-212956-04</p>	
<p>BY: ANN H</p>		<p>3/29/2023 SHEET 1 OF 2</p>	

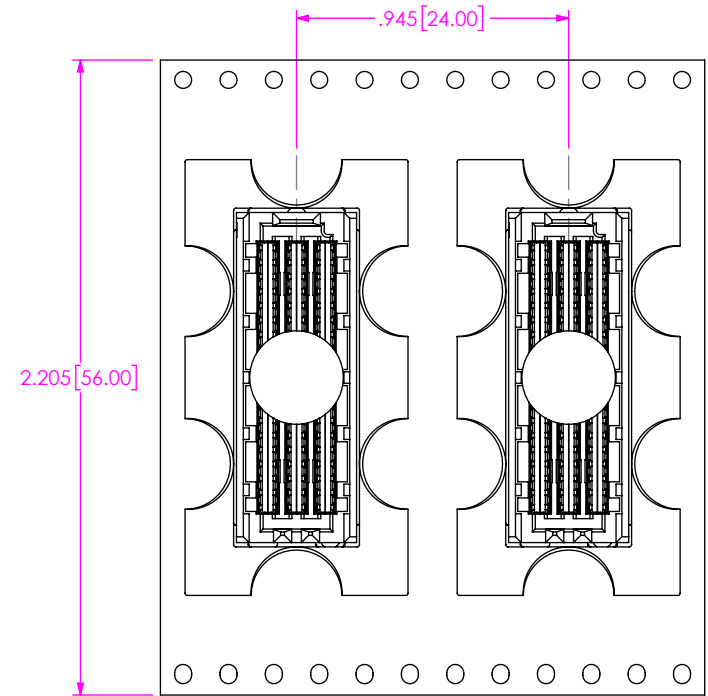
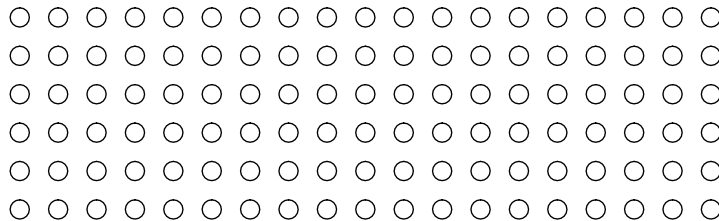
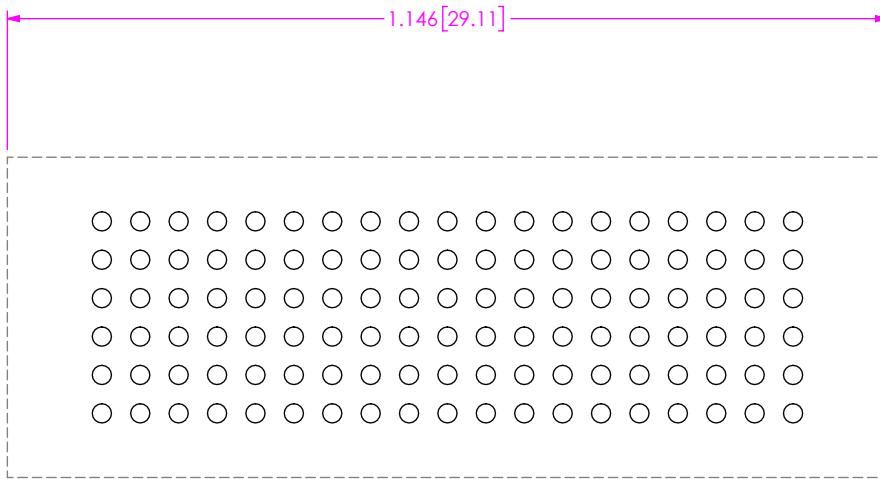

USER DIRECTION OF UN-REELING →
POCKET NOT DETAILED

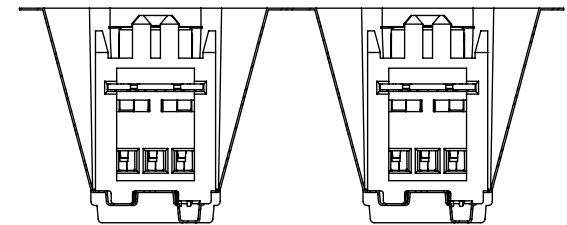

PACKAGING VIEW

PROPRIETARY NOTE
THIS DOCUMENT CONTAINS CONFIDENTIAL AND PROPRIETARY INFORMATION AND ALL DESIGN, MANUFACTURING, REPRODUCTION, USE, PATENT RIGHTS AND SALES RIGHTS ARE EXPRESSLY RESERVED BY SAMTEC, INC. THIS DOCUMENT SHALL NOT BE DISCLOSED, IN WHOLE OR PART, TO ANY UNAUTHORIZED PERSON OR ENTITY NOR REPRODUCED, TRANSFERRED OR INCORPORATED IN ANY OTHER PROJECT IN ANY MANNER WITHOUT THE EXPRESS WRITTEN CONSENT OF SAMTEC, INC.



520 PARK EAST BLVD., NEW ALBANY, IN 47150
PHONE: 812-944-6733 FAX: 812-948-5047
e-Mail: info@SAMTEC.com code 55322

SHEET SCALE: 2:1

DESCRIPTION:
VITA88 MODIFIED SEAM ASM

DWG. NO.
ASP-212956-04

BY: ANN H 3/29/2023 SHEET 2 OF 2