

DO NOT
SCALE FROM
THIS PRINT

B1SDS-XX-N-XX

No OF POS
*-04, *-05, *-07, -10,
-15, *-20, -25, -30, *-40
PLATING SPEC
-N: NICKEL PLATED
(* = NOT TOOLED)

OPTION
-CS: CAPTIVE SCREW
-L: LATCH TYPE

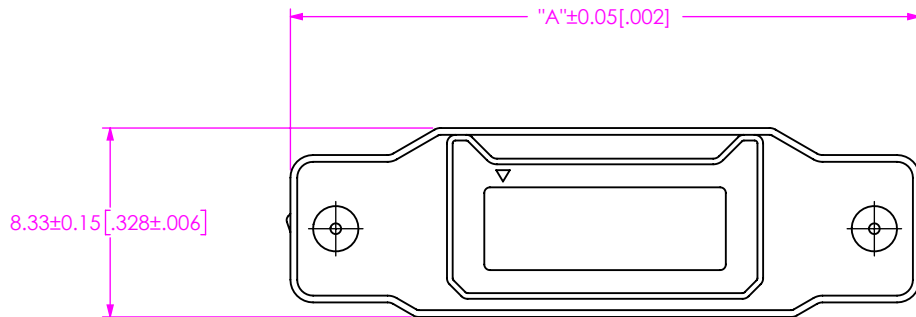
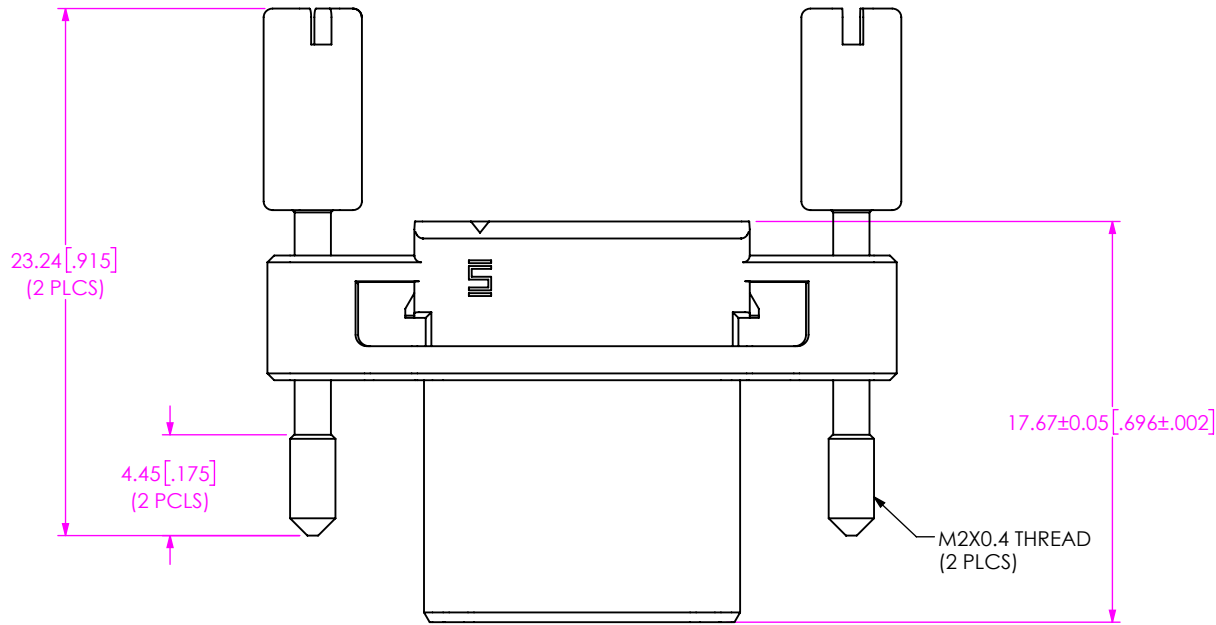

FIG 1
B1SDS-10-N-CS SHOWN

TABLE 1	
No. OF POS	"A"
-04	21.75 [0.856]
-05	22.75 [0.896]
-07	24.75 [0.974]
-10	27.75 [1.093]
-15	32.75 [1.289]
-20	37.75 [1.486]
-25	42.75 [1.683]
-30	47.75 [1.880]
-40	57.75 [2.274]

NOTES:

- PARTS TO BE BULK PACKAGED.

PROPRIETARY NOTE
THIS DOCUMENT CONTAINS CONFIDENTIAL AND PROPRIETARY INFORMATION AND ALL DESIGN, MANUFACTURING, REPRODUCTION, USE, PATENT RIGHTS AND SALES RIGHTS ARE EXPRESSLY RESERVED BY SAMTEC, INC. THIS DOCUMENT SHALL NOT BE DISCLOSED, IN WHOLE OR PART, TO ANY UNAUTHORIZED PERSON OR ENTITY NOR REPRODUCED, TRANSFERRED OR INCORPORATED IN ANY OTHER PROJECT IN ANY MANNER WITHOUT THE EXPRESS WRITTEN CONSENT OF SAMTEC, INC.

DO NOT SCALE DRAWING
SHEET SCALE: 1:2
MATERIAL:
SHIELD: ZINC ALLOY, PLATING: NICKEL
PANEL SCREW: STAINLESS STEEL



520 PARK EAST BLVD, NEW ALBANY, IN 47150
PHONE: 812-944-6733 FAX: 812-948-5047
e-Mail info@SAMTEC.com code 53322

DESCRIPTION:

B1SDX 1MM SHELL

DWG. NO.

B1SDS-XX-N-XX

BY: G DETHY 04/07/2018 SHEET 1 OF 1