

DO NOT
SCALE FROM
THIS PRINT

TABLE 1					
ITEM	COMPONENT	-HF	-HN	-GF	-GN
1	SUB ASSEMBLY	SUB-BNC5-J-C-F-ST-BH2	SUB-BNC5-J-C-N-ST-BH2	SUB-BNC5-J-C-F-ST-BH2	SUB-BNC5-J-C-N-ST-BH2
2	SOCKET	BTNC-SKT-004-H		BTNC-SKT-004-G	
3	INSULATOR	BNC5-INS-002			
4	INNER FERRULE	MCX-FER-012-F	MCX-FER-012-N	MCX-FER-012-F	MCX-FER-012-N
5	OUTER FERRULE	MCX-FER-004-F	MCX-FER-004-N	MCX-FER-004-F	MCX-FER-004-N
6	GASKET	BTNC-GKT-001			
7	LOCK WASHER	BTNC-LWAS-001-F	BTNC-LWAS-001-N	BTNC-LWAS-001-F	BTNC-LWAS-001-N
8	HEX NUT	BTNC-NUT-001-F	BTNC-NUT-001-N	BTNC-NUT-001-F	BTNC-NUT-001-N

GENDER
-J: JACK

TERMINATION
-BH2: BULKHEAD RG178

TYPE
-C: CABLE

ORIENTATION
-ST: STRAIGHT

PLATING SPECIFICATION
 -HF: 30µ" GOLD CENTER CONTACT,
 3µ" GOLD OUTER CONTACT
 -HN: 30µ" GOLD CENTER CONTACT,
 100µ" NICKEL OUTER CONTACT
 -GF: 10µ" GOLD CENTER CONTACT,
 3µ" GOLD OUTER CONTACT
 -GN: 10µ" GOLD CENTER CONTACT,
 100µ" NICKEL OUTER CONTACT
 (SEE TABLE 1)

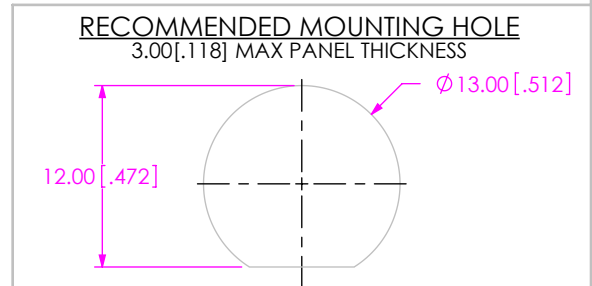
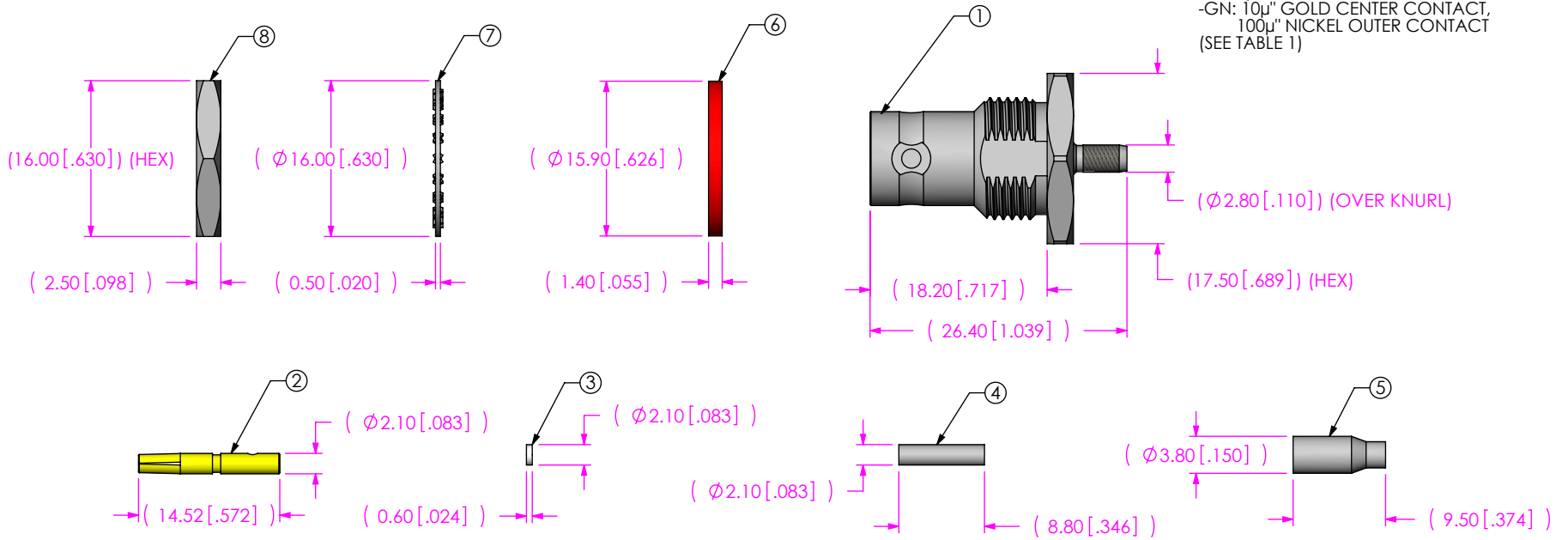

NOTES:
 1. NOTE DELETED.
 2. PRODUCT TO BE BULK PACKAGED PER PACKAGING STANDARD CO-RF-WI-3040-M.

UNLESS OTHERWISE SPECIFIED, DIMENSIONS ARE IN MILLIMETERS [INCHES]. TOLERANCES ARE:

DECIMALS	ANGLES
X.X: ±0.3 [.01]	5°
X.XX: ±0.13 [.005]	
X.XXX: ±0.051 [.0020]	

PROPRIETARY NOTE
 THIS DOCUMENT CONTAINS CONFIDENTIAL AND PROPRIETARY INFORMATION AND ALL DESIGN, MANUFACTURING, REPRODUCTION, USE, PATENT RIGHTS AND SALES RIGHTS ARE EXPRESSLY RESERVED BY SAMTEC, INC. THIS DOCUMENT SHALL NOT BE DISCLOSED, IN WHOLE OR PART, TO ANY UNAUTHORIZED PERSON OR ENTITY NOR REPRODUCED, TRANSFERRED OR INCORPORATED IN ANY OTHER PROJECT IN ANY MANNER WITHOUT THE EXPRESS WRITTEN CONSENT OF SAMTEC, INC.

MATERIAL: DO NOT SCALE DRAWING SHEET SCALE: 3:2
 CABLE BODY, FERRULES, LOCK WASHER, HEX NUT: BRASS
 GASKET: SILICON
 SOCKET: PHOS BRONZE
 DIELECTRICS: PTFE

520 PARK EAST BLVD. NEW ALBANY, IN 47150
 PHONE: 812-944-6733 FAX: 812-948-5047
 e-Mail info@SAMTEC.com code 55322

DESCRIPTION:
 50 OHM, BNC STRAIGHT JACK BULKHEAD, RG178

DWG. NO.
BNC5-J-C-XX-ST-BH2

BY: ALVIN W 07/13/2011 SHEET 1 OF 2

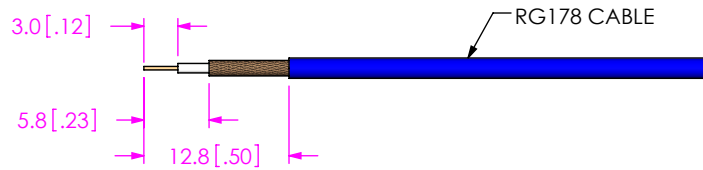

IN PROCESS 1
STRIP CABLE AND TIN INNER CONDUCTOR

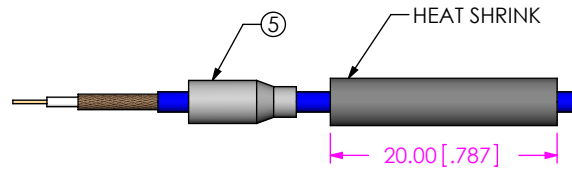

IN PROCESS 2
ADD HEAT SHRINK TUBING & OUTER FERRULE

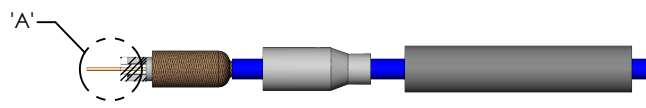

IN PROCESS 3
FLARE SHIELD, ADD INSULATOR & INNER FERRULE

INSULATOR WASHER AND
INNER FERRULE TO BE
FLUSH WITH CABLE
DIELECTRIC

DETAIL 'A'
SCALE 6 : 1

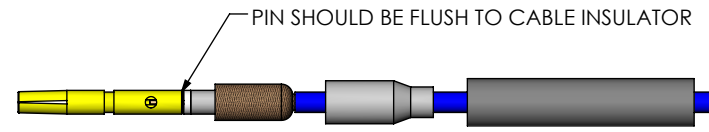

IN PROCESS 4
FLARE SHIELD, SOLDER SIGNAL SOCKET

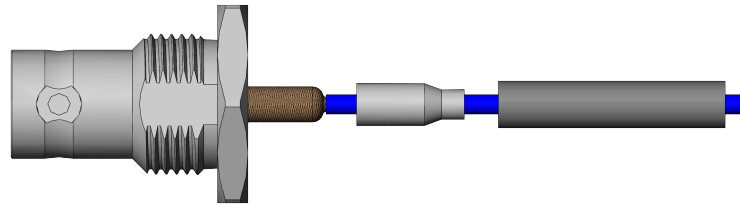

IN PROCESS 5
ADD SUB ASSEMBLY

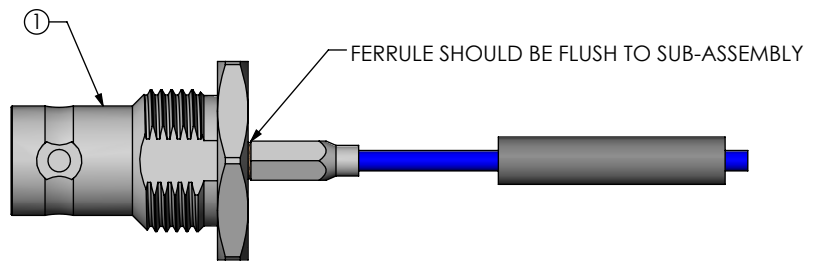

IN PROCESS 6
CRIMP OUTER FERRULE
(USE RF CRIMP HAND TOOL #CAT-RF-FER-01
USE 0.128" DIE SIZE)

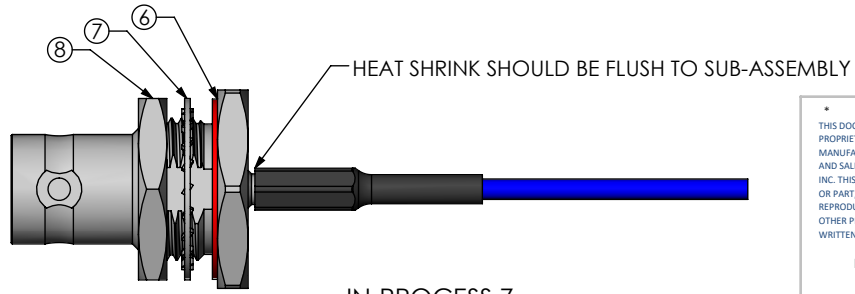

IN-PROCESS 7
ACTIVATE HEAT SHRINK TUBING
& ADD GASKET

PROPRIETARY NOTE
THIS DOCUMENT CONTAINS CONFIDENTIAL AND PROPRIETARY INFORMATION AND ALL DESIGN, MANUFACTURING, REPRODUCTION, USE, PATENT RIGHTS AND SALES RIGHTS ARE EXPRESSLY RESERVED BY SAMTEC, INC. THIS DOCUMENT SHALL NOT BE DISCLOSED, IN WHOLE OR PART, TO ANY UNAUTHORIZED PERSON OR ENTITY NOR REPRODUCED, TRANSFERRED OR INCORPORATED IN ANY OTHER PROJECT IN ANY MANNER WITHOUT THE EXPRESS WRITTEN CONSENT OF SAMTEC, INC.

DO NOT SCALE DRAWING

SHEET SCALE: 3:2



520 PARK EAST BLVD, NEW ALBANY, IN 47150
PHONE: 812-944-6733 FAX: 812-948-5047
e-Mail info@SAMTEC.com code 55322

DESCRIPTION:
50 OHM, BNC STRAIGHT JACK BULKHEAD, RG178

DWG. NO.
BNC5-J-C-XX-ST-BH2

BY: ALVIN W 07/13/2011 SHEET 2 OF 2