

DO NOT SCALE FROM THIS PRINT

DESIGNED & DIMENSIONED IN MILLIMETERS [INCHES]

DCA-ACP-16-M-X

SIZE METAL KEYING FEATURE COLOR (SEE TABLE 1)
 -1: ORANGE
 -2: GREEN
 -3: BLUE
 -4: YELLOW

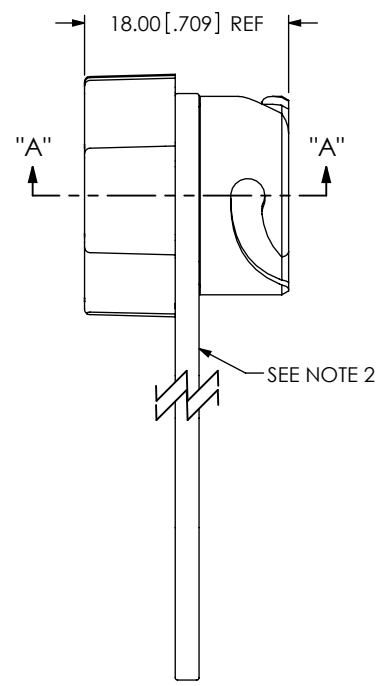
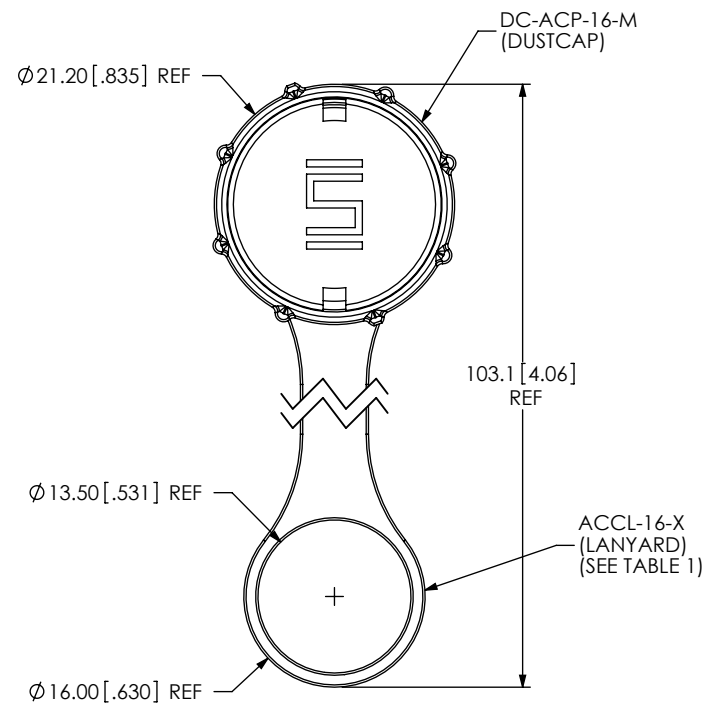
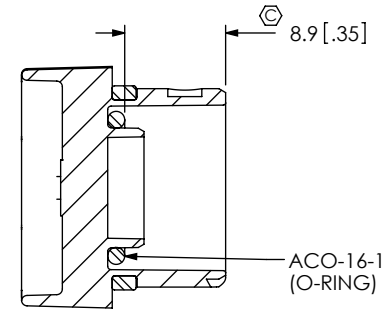
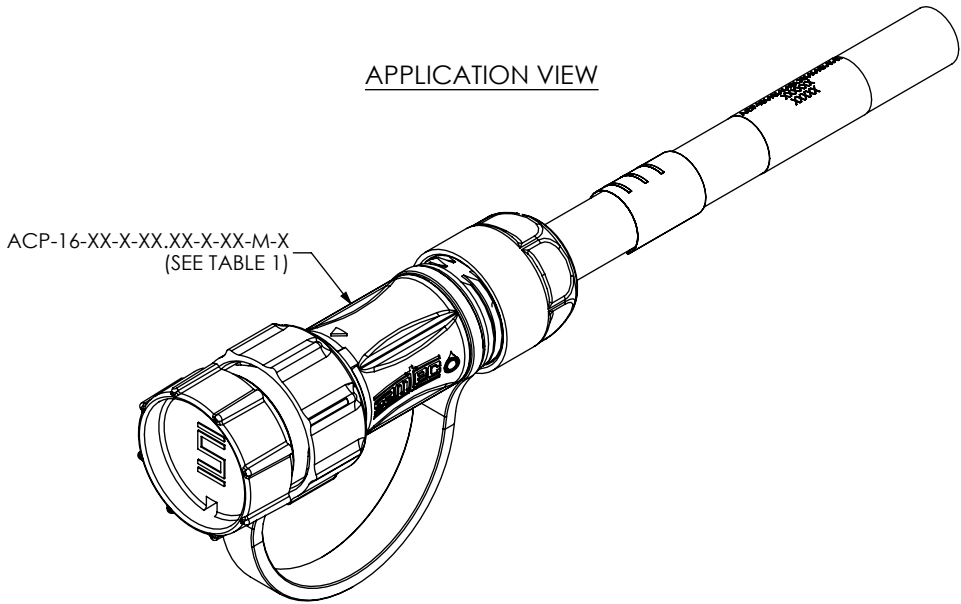

TABLE 1

CORRESPONDING CABLE PART NUMBER	KEYING FEATURE COLOR	ACCL-16-X
ACP-16-XX-X-XX.XX-X-XX-M-1	-1	ACCL-16-1
ACP-16-XX-X-XX.XX-X-XX-M-2	-2	ACCL-16-2
ACP-16-XX-X-XX.XX-X-XX-M-3	-3	ACCL-16-3
ACP-16-XX-X-XX.XX-X-XX-M-4	-4	ACCL-16-4

APPLICATION VIEW



SECTION "A"- "A"

- NOTES:
1. REPRESENTS A CRITICAL DIMENSION.
 2. ACCL-16-X MUST SEAT IN GROOVE IN DC-ACP-16-M.

UNLESS OTHERWISE SPECIFIED, DIMENSIONS ARE IN MILLIMETERS. TOLERANCES ARE: DECIMALS ANGLES X.X: ±0.3 [.01] 2° X.XX: ±0.08 [.003] X.XXX: ±0.051 [.0020]	PROPRIETARY NOTE THIS DOCUMENT CONTAINS INFORMATION CONFIDENTIAL AND PROPRIETARY TO SAMTEC, INC. AND SHALL NOT BE REPRODUCED OR TRANSFERRED TO OTHER DOCUMENTS OR DISCLOSED TO OTHERS OR USED FOR ANY PURPOSE OTHER THAN THAT WHICH IT WAS OBTAINED WITHOUT THE EXPRESSED WRITTEN CONSENT OF SAMTEC, INC.	 520 PARK EAST BLVD., NEW ALBANY, IN 47150 PHONE: 812-944-6733 FAX: 812-948-5047 e-Mail info@SAMTEC.com code 53322	
		MATERIAL: DC-ACP-16-M: ZINC ALLOY ACCL-16-X: SILICONE ACO-16-1: SILICONE	DESCRIPTION: M16 CABLE DUST CAP METAL DWG. NO. DCA-ACP-16-M-X
DO NOT SCALE DRAWING SHEET SCALE: 1.5:1		BY: D.SCHMELZ 04/26/2010 SHEET 1 OF 1	