

DESIGNED AND DIMENSIONED IN INCHES[MILLIMETERS]  
ALL DIMENSIONS REFERENCE EXCEPT AS SHOWN

DO NOT  
SCALE FROM  
THIS PRINT

GPCC-16-X-S-X-XX-XXXX-SD-1

SIZE  
-16: SIZE 16

SERIES  
-N: VNX

GENDER  
-S: SOCKET

TYPE  
-C: CABLE

OPTION  
-1

ORIENTATION  
-SD: DIRECT SOLDER

CABLE CALLOUT  
-047J:

FINISH  
-GG: 10μ" GOLD CENTER CONTACT  
10μ" GOLD OUTER BODY

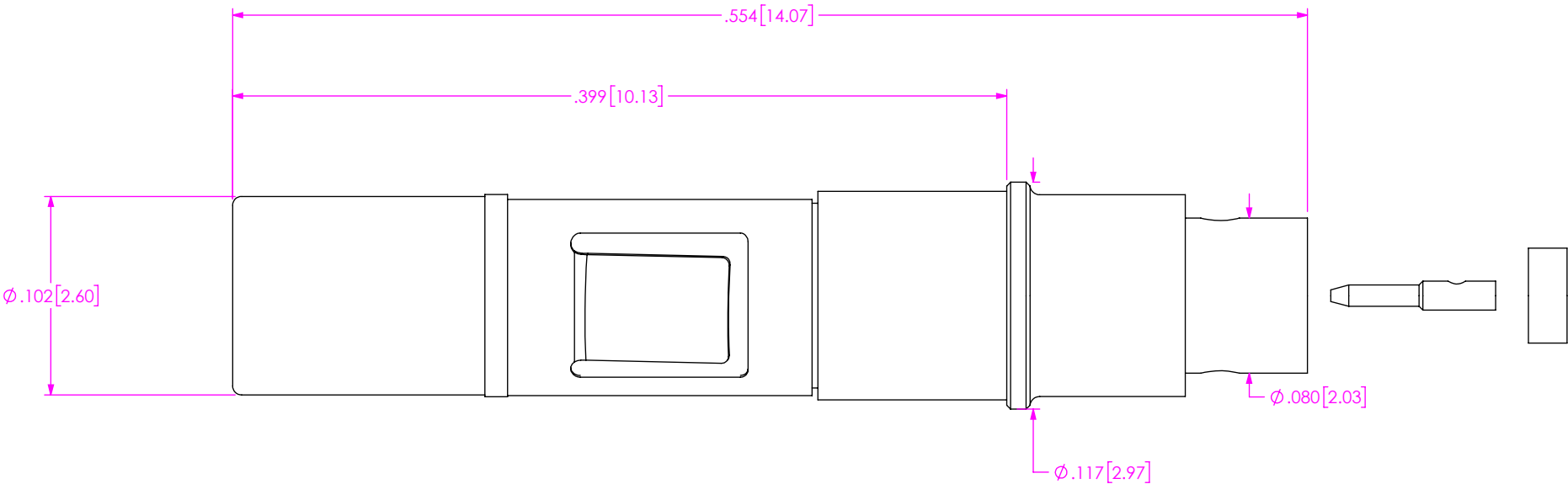
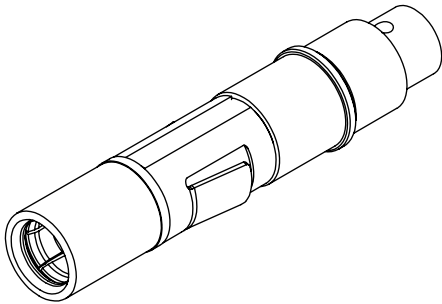

- NOTES:
1. MATERIAL:  
HOOD: STAINLESS STEEL.  
CONTACT, BUSHING, CLIP, OUTER CONTACT, REAR PIN: BERYLLIUM COPPER.  
FORWARD BEAD: PCTFE.  
REAR BEAD, DIELECTRIC STOP: PEEK VICTREX  
SOLDER FERRULE INSULATOR: PTFE
2. FINISH:  
CONTACT, BUSHING, CLIP, OUTER CONTACT, REAR PIN: GOLD OVER NICKEL PLATE,  
10 μIN MIN GOLD OVER 50 μIN MIN NICKEL.

|  |   |
|--|---|
| <p>• PROPRIETARY NOTE •</p> <p>THIS DOCUMENT CONTAINS CONFIDENTIAL AND PROPRIETARY INFORMATION AND ALL DESIGN, MANUFACTURING, REPRODUCTION, USE, PATENT RIGHTS AND SALES RIGHTS ARE EXPRESSLY RESERVED BY SAMTEC, INC. THIS DOCUMENT SHALL NOT BE DISCLOSED, IN WHOLE OR PART, TO ANY UNAUTHORIZED PERSON OR ENTITY NOR REPRODUCED, TRANSFERRED OR INCORPORATED IN ANY OTHER PROJECT IN ANY MANNER WITHOUT THE EXPRESS WRITTEN CONSENT OF SAMTEC, INC.</p> | <p><b>samtec</b></p> <p>520 PARK EAST BLVD, NEW ALBANY, IN 47150<br/>PHONE: 812-944-6733 FAX: 812-948-5047<br/>e-Mail info@SAMTEC.com code 55322</p>              |
| <p>DO NOT SCALE DRAWING<br/>SHEET SCALE: 12:1</p>  | <p>DESCRIPTION: GPCC, SOCKET, ST, CONTACT ASSEMBLY, SIZE 16, 75 OHM</p> <p>DWG. NO.<br/>GPCC-16-X-S-X-XX-XXXX-SD-1</p> <p>BY: MATT M. 05/30/2023 SHEET 1 OF 2</p> |

IN-PROCESS 1

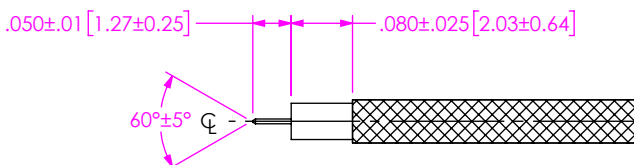

1. TRIM BRAID AND DIELECTRIC AND PRE-TIN CABLE JACKET TO DIM AS SHOWN.

IN-PROCESS 2

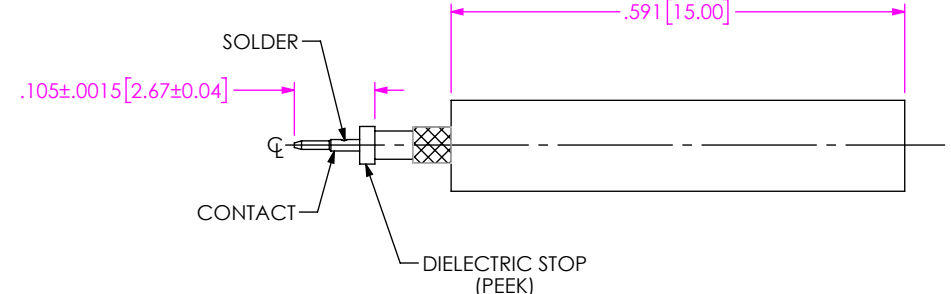

2A. ADD HEAT SHRINK & SUB ASSEMBLY.  
2B. SOLDER CABLE TO BACK BODY.  
2C.SLIDE DIELECTRIC STOP OVER CABLE CENTER CONDUCTOR AND SOLDER CONTACT FLUSH AGAINST STOP TO DIMENSION SHOWN.



3A. INSERT CONNECTOR SUB-ASSEMBLY ONTO CABLE SUB ASSEMBLY.  
3B. APPLY HEAT TO SHRINK TUBING.

|  |   |
|--|---|
| <p>• PROPRIETARY NOTE</p> <p>THIS DOCUMENT CONTAINS CONFIDENTIAL AND PROPRIETARY INFORMATION AND ALL DESIGN, MANUFACTURING, REPRODUCTION, USE, PATENT RIGHTS AND SALES RIGHTS ARE EXPRESSLY RESERVED BY SAMTEC, INC. THIS DOCUMENT SHALL NOT BE DISCLOSED, IN WHOLE OR PART, TO ANY UNAUTHORIZED PERSON OR ENTITY NOR REPRODUCED, TRANSFERRED OR INCORPORATED IN ANY OTHER PROJECT IN ANY MANNER WITHOUT THE EXPRESS WRITTEN CONSENT OF SAMTEC, INC.</p> |  <p>520 PARK EAST BLVD, NEW ALBANY, IN 47150<br/>PHONE: 812-944-6733 FAX: 812-948-5047<br/>e-Mail info@SAMTEC.com code 55322</p> |
| <p>DO NOT SCALE DRAWING</p> <p>SHEET SCALE: 3:2</p>  | <p>DESCRIPTION: GPCC, SOCKET, ST, CONTACT ASSEMBLY, SIZE 16, 75 OHM</p> <p>DWG. NO. GPCC-16-X-S-X-XX-XXXX-SD-1</p> <p>BY: MATT M. 05/30/2023 SHEET 2 OF 2</p>   |