

**THIS PRODUCT MANUFACTURED WITH LEAD-FREE PROCESSING**

**DESIGNED & DIMENSIONED IN MILLIMETERS [INCHES]**

DO NOT SCALE FROM THIS PRINT

TABLE 1		
ITEM	COMPONENT	-H
1	SUB ASSEMBLY	SUB-MMCX-P-C-HF-RA-CA1
2	FERRULE	MCX-FER-002-F
3	INSULATOR	MMCX-INS-001
4	CAP	MMCX-CAP-001-F

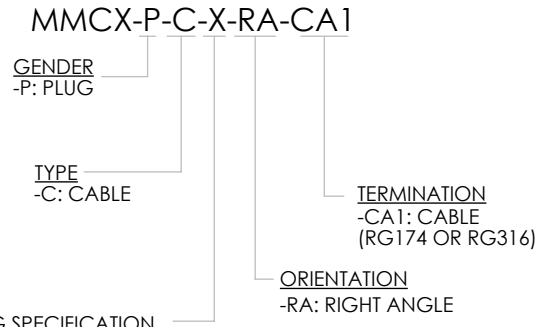

PLATING SPECIFICATION  
 -H: 30µ" GOLD CENTER CONTACT, 3µ" GOLD OUTER CONTACT (SEE TABLE 1)

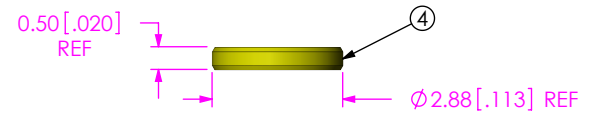
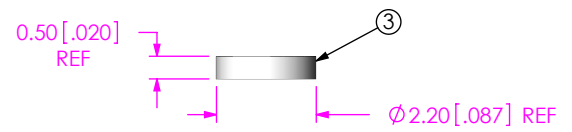
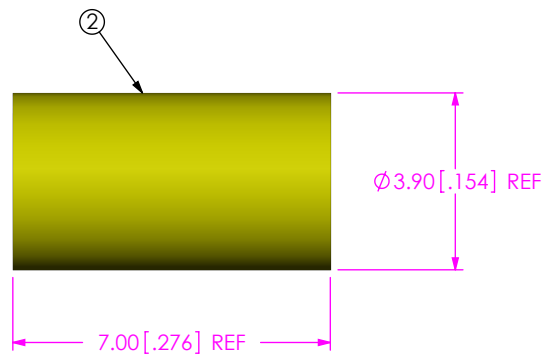
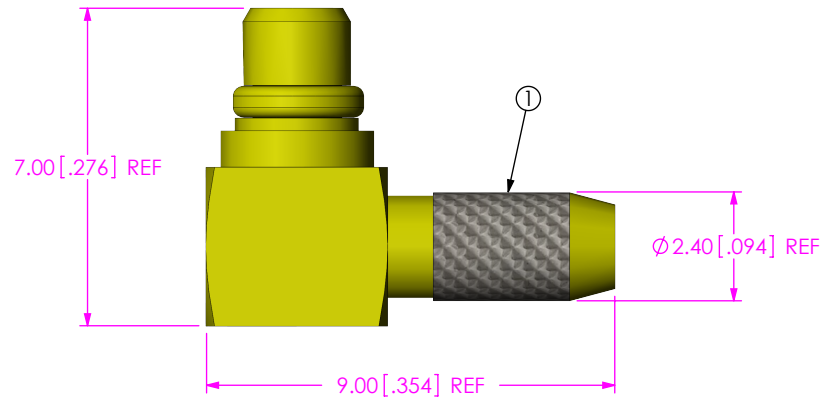

- NOTES:
- ⊙ REPRESENTS A CRITICAL DIMENSION.
  - CENTER CONTACT PUSHOUT FORCE: 26.69 N [6LB] MIN
  - NOTE DELETED.
  - NOTE DELETED.
  - PRODUCT TO BE PACKAGED PER PRECISION RF SECTION OF PACKAGING MANUAL
  - NOTE DELETED.
  - NOTE DELETED.
  - NOTE DELETED.

F:\DWG\SW\Exisprod\Assembly\Rf\Mmcx\Mmcx-p-c-x-ra-ca1\MMCX-P-C-X-RA-CA1-X-ASM.slddrw

**UNLESS OTHERWISE SPECIFIED, DIMENSIONS ARE IN MILLIMETERS [INCHES].**  
 TOLERANCES ARE:  
 DECIMALS ANGLES  
 .X: ±0.3 [.01] 5°  
 .XX: ±0.13 [.005]  
 .XXX: ±0.051 [.0020]

**PROPRIETARY NOTE**  
 THIS DOCUMENT CONTAINS CONFIDENTIAL AND PROPRIETARY INFORMATION AND ALL DESIGN, MANUFACTURING, REPRODUCTION, USE, PATENT RIGHTS AND SALES RIGHTS ARE EXPRESSLY RESERVED BY SAMTEC, INC. THIS DOCUMENT SHALL NOT BE DISCLOSED, IN WHOLE OR PART, TO ANY UNAUTHORIZED PERSON OR ENTITY NOR REPRODUCED, TRANSFERRED OR INCORPORATED IN ANY OTHER PROJECT IN ANY MANNER WITHOUT THE EXPRESS WRITTEN CONSENT OF SAMTEC, INC.



520 PARK EAST BLVD., NEW ALBANY, IN 47150  
 PHONE: 812-944-6733 FAX: 812-948-5047  
 e-Mail info@SAMTEC.com code 55322

**MATERIAL:** DO NOT SCALE DRAWING SHEET SCALE: 6:1  
 SHELL, FERRULE, CAP: BRASS  
 CONTACT: BRASS  
 DIELECTRIC: PTFE

DESCRIPTION:  
 MMCX R/A CABLE PLUG, RG174 & RG316- 50 OHM

DWG. NO.  
**MMCX-P-C-X-RA-CA1**

BY: R MUSSER 02/06/2008 SHEET 1 OF 2



1.50±0.30 [.059±.012]



2.70±0.30 [.106±.012]



7.60±0.30 [.299±.012]

RG174 OR RG316 CABLE



IN-PROCESS 1  
STRIP AND TIN INNER CONDUCTOR

0.05 [.002] REF  
TO CENTER CONTACT

Ø0.41 [.016] REF

1.70 [.067] REF  
TO INSULATOR

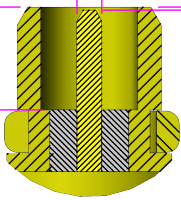

DETAIL 'A'  
SCALE 8:1

END OF CABLE DIELECTRIC  
SHOULD NOT SEAT AGAINST  
CONTACT CUP

CABLE CENTER CONDUCTOR  
SHOULD NOT PROTRUDE  
OUTSIDE CONTACT CUP AFTER  
FERRULE IS CRIMPED

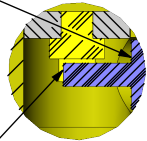

DETAIL 'C'



0.00±0.10 [.000±.004]

DETAIL 'B'  
SCALE 5:1



Ø2.40 [.094]  
(MIN. FLARED ID)

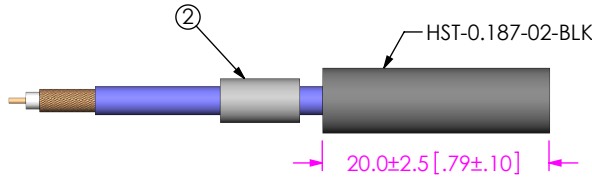

IN-PROCESS 2  
ADD HEAT SHRINK TUBE AND FERRULE

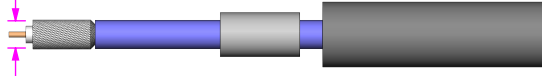

IN-PROCESS 3  
FLARE SHIELD

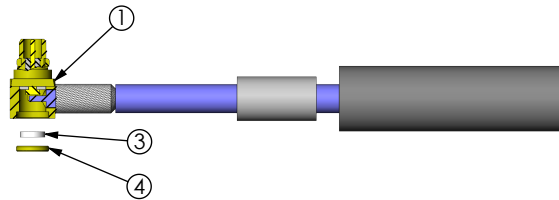

IN-PROCESS 4  
ADD SUB ASSEMBLY

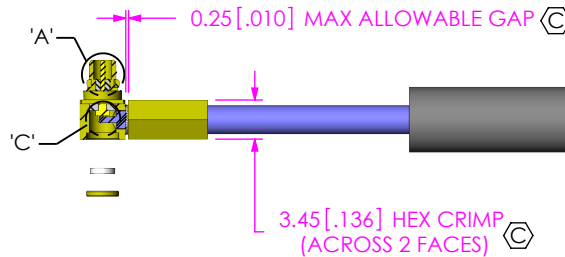

IN-PROCESS 5  
CRIMP FERRULE & SOLDER SIGNAL PIN  
(USE RF CRIMP HAND TOOL #CAT-RF-FER-001 AND 0.128" DIE SIZE)



IN-PROCESS 6  
INSERT INSULATOR AND CAP

0.6 [.03] MAX GAP ALLOWABLE



IN-PROCESS 7  
APPLY HEAT SHRINK TUBING

F:\DWG\SW\Exisprod\Assembly\RF\Mmcx\Mmcx-p-c-x-ra-ca1\MMCX-P-C-X-RA-CA1-X-ASM.slddrw

**PROPRIETARY NOTE**  
THIS DOCUMENT CONTAINS CONFIDENTIAL AND PROPRIETARY INFORMATION AND ALL DESIGN, MANUFACTURING, REPRODUCTION, USE, PATENT RIGHTS AND SALES RIGHTS ARE EXPRESSLY RESERVED BY SAMTEC, INC. THIS DOCUMENT SHALL NOT BE DISCLOSED, IN WHOLE OR PART, TO ANY UNAUTHORIZED PERSON OR ENTITY NOR REPRODUCED, TRANSFERRED OR INCORPORATED IN ANY OTHER PROJECT IN ANY MANNER WITHOUT THE EXPRESS WRITTEN CONSENT OF SAMTEC, INC.

DO NOT SCALE DRAWING

SHEET SCALE: 6:1



520 PARK EAST BLVD, NEW ALBANY, IN 47150  
PHONE: 812-944-6733 FAX: 812-948-5047  
e-Mail info@SAMTEC.com code 55322

DESCRIPTION:  
MMCX R/A CABLE PLUG, RG174 & RG316- 50 OHM

DWG. NO.  
**MMCX-P-C-X-RA-CA1**

BY: R MUSSER 02/06/2008 SHEET 2 OF 2