

DO NOT SCALE FROM THIS PRINT

DESIGNED & DIMENSIONED IN INCHES[MILLIMETERS]

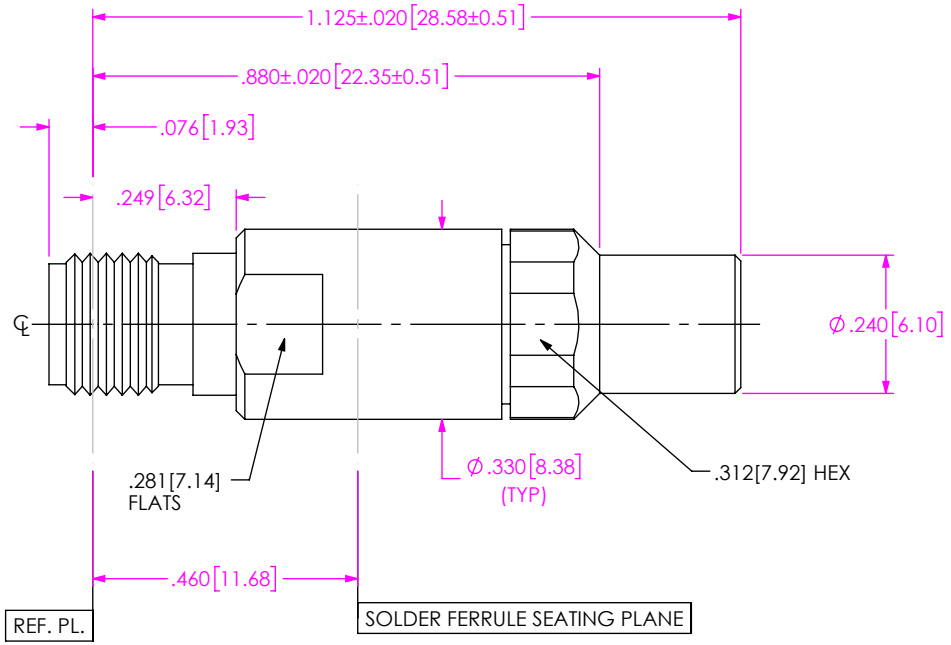

**PRF35-J-C-EP-160-SS**

**SERIES**  
-35: 3.5mm

**GENDER**  
-J: JACK

**TYPE**  
-C: CABLE

**TERMINATION**  
S: SOLDER CLAMP

**ORIENTATION**  
-S: STRAIGHT

**CABLE TYPE**  
-160: SEMFLEX HP160

**FINISH**  
-EP: 50µ" EXTRA HEAVY GOLD CENTER CONTACT, PASSIVATED OUTER CONTACT

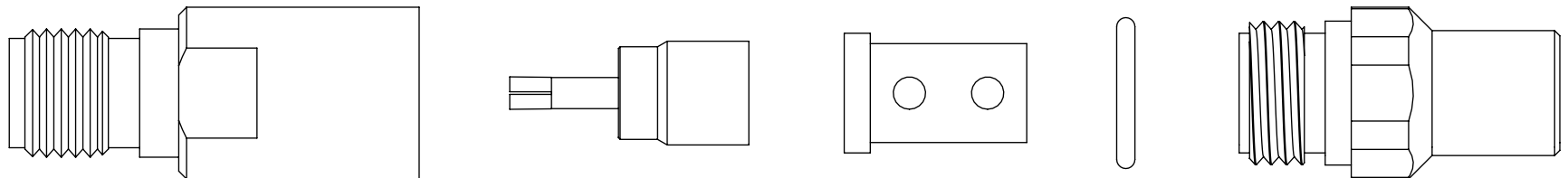
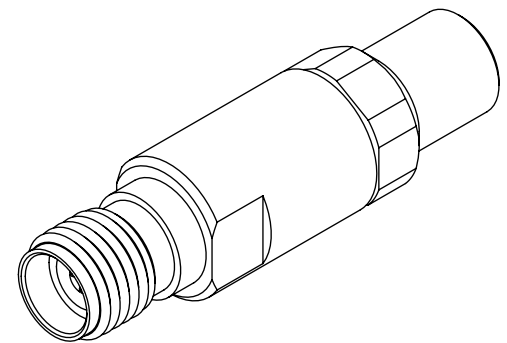

EXPLODED VIEW  
NOT TO SCALE  
(FOR CLARITY ONLY)

NOTES:

- MATERIAL:**  
BODY, BUSHING, CLAMP NUT: STAINLESS STEEL  
CONTACT: BERYLLIUM COPPER  
SOLDER FERRULE: BRASS ALLOY  
BEAD: PCTFE  
O-RING: SILICONE RUBBER
- FINISH:**  
BODY, BUSHING, CLAMP NUT: PASSIVATED  
CONTACT: 50µ" MIN. GOLD OVER 50µ" MIN. NICKEL PLATE  
SOLDER FERRULE: 10µ" MIN. GOLD OVER 50µ" MIN. NICKEL PLATE
- PCI P/N: 3416

<p><b>PROPRIETARY NOTE</b></p> <p>THIS DOCUMENT CONTAINS CONFIDENTIAL AND PROPRIETARY INFORMATION AND ALL DESIGN, MANUFACTURING, REPRODUCTION, USE, PATENT RIGHTS AND SALES RIGHTS ARE EXPRESSLY RESERVED BY SAMTEC, INC. THIS DOCUMENT SHALL NOT BE DISCLOSED, IN WHOLE OR PART, TO ANY UNAUTHORIZED PERSON OR ENTITY NOR REPRODUCED, TRANSFERRED OR INCORPORATED IN ANY OTHER PROJECT IN ANY MANNER WITHOUT THE EXPRESS WRITTEN CONSENT OF SAMTEC, INC.</p>	<p>520 PARK EAST BLVD. NEW ALBANY, IN 47150 PHONE: 812-944-6733 FAX: 812-948-5047 e-Mail: info@SAMTEC.com code 55322</p>
	<p>DESCRIPTION: 3.5MM JACK. SOLDER CLAMP FOR SEMFLEX HP160 CABLE</p>
<p>DO NOT SCALE DRAWING SHEET SCALE: 3:1</p>	<p>DWG. NO. <b>PRF35-J-C-EP-160-SS</b></p>
<p>F:\DWG\SW\Exisprod\Assembly\RF\350\PRF35-J-C-EP-160-SS\PRF35-J-C-EP-160-SS.SLDDRW</p>	<p>BY: SAMUEL C 05/07/2019 SHEET 1 OF 3</p>

# CABLE APPLICATION VIEWS

1. TRIM CABLE TO EXPOSE DIELECTRIC CORE AND BRAIDS AS SHOWN.

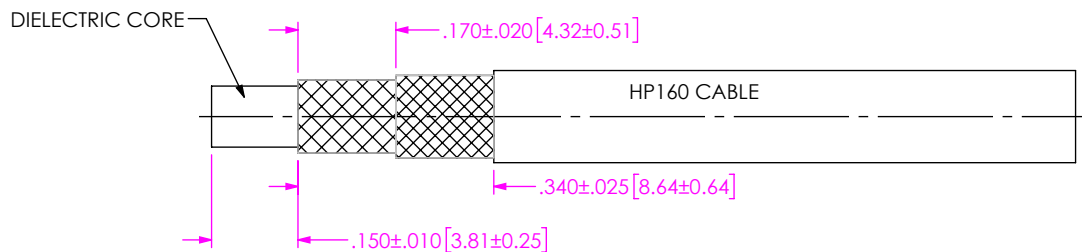

IN-PROCESS VIEW 1

- 2A. INSTALL O-RING ONTO CLAMP NUT WHERE SHOWN AND SLIDE CLAMP NUT OVER CABLE IN ORIENTATION SHOWN.
- 2B. INSERT CABLE INTO SOLDER FERRULE UNTIL INNER BRAID IS SEATED AND SOLDER CABLE BRAIDS WHERE SHOWN.
- 2C. TRIM CABLE DIELECTRIC FLUSH WITH FACE OF SOLDER FERRULE.
- 2D. POINT CABLE CENTER CONDUCTOR AS SHOWN.

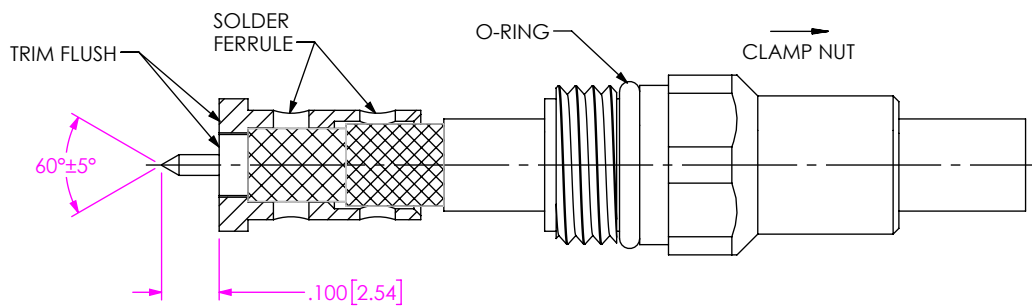

IN-PROCESS VIEW 2

3. INSERT CONTACT/BUSHING SUB-ASSEMBLY INTO CONNECTOR HEAD IN ORIENTATION SHOWN UNTIL BUSHING SEATS.

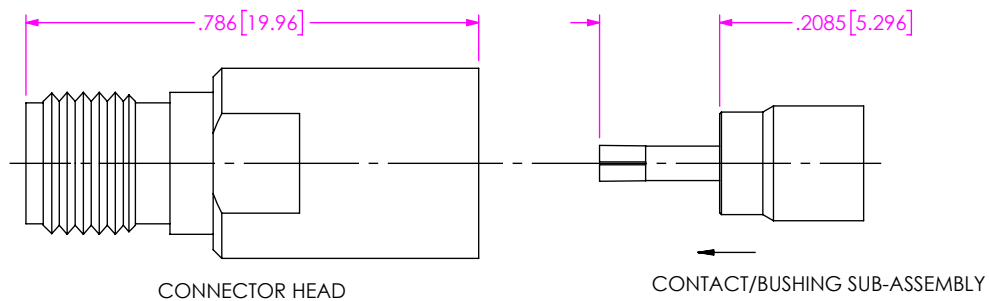

IN-PROCESS VIEW 3

**PROPRIETARY NOTE**  
 THIS DOCUMENT CONTAINS CONFIDENTIAL AND PROPRIETARY INFORMATION AND ALL DESIGN, MANUFACTURING, REPRODUCTION, USE, PATENT RIGHTS AND SALES RIGHTS ARE EXPRESSLY RESERVED BY SAMTEC, INC. THIS DOCUMENT SHALL NOT BE DISCLOSED, IN WHOLE OR PART, TO ANY UNAUTHORIZED PERSON OR ENTITY NOR REPRODUCED, TRANSFERRED OR INCORPORATED IN ANY OTHER PROJECT IN ANY MANNER WITHOUT THE EXPRESS WRITTEN CONSENT OF SAMTEC, INC.



520 PARK EAST BLVD, NEW ALBANY, IN 47150  
 PHONE: 812-944-6733 FAX: 812-948-5047  
 e-Mail info@SAMTEC.com code 55322

DO NOT SCALE DRAWING

SHEET SCALE: 3:1

DESCRIPTION: 3.5MM JACK, SOLDER CLAMP FOR SEMFLEX HP160 CABLE

DWG. NO. PRF35-J-C-EP-160-SS

BY: SAMUEL C 05/07/2019 SHEET 2 OF 3

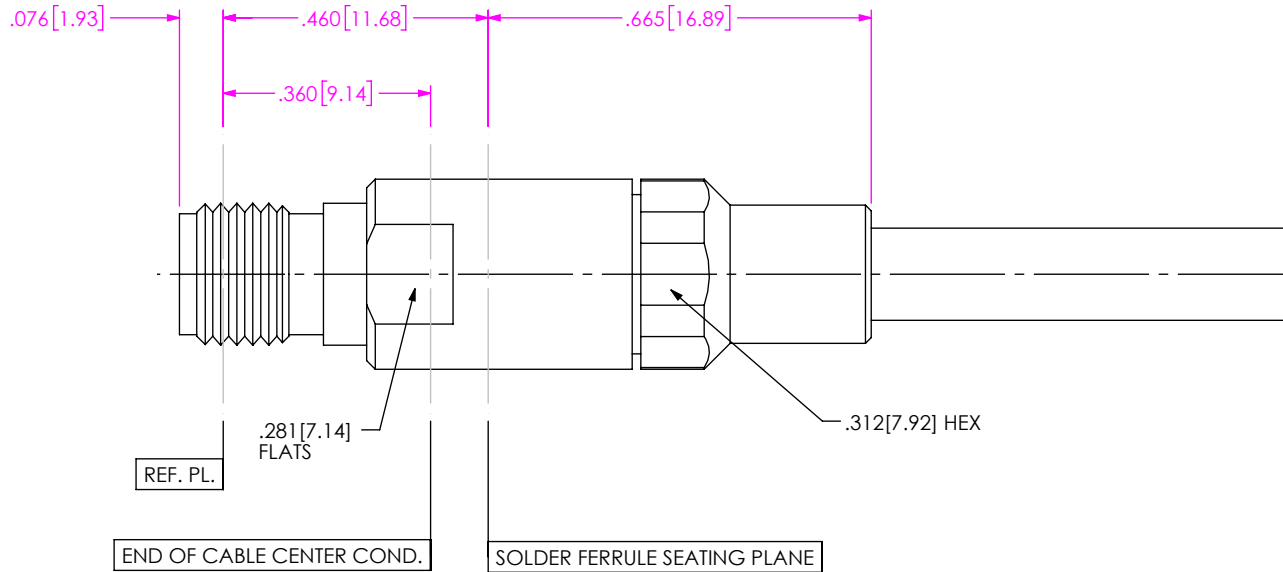

4. INSERT CABLE/CONTACT SUB-ASSEMBLY INTO CONNECTOR UNTIL CABLE CENTER CONDUCTOR PLUGS INTO CONTACT AND SOLDER FERRULE SEATS. TIGHTEN CLAMP NUT TO 25-35 IN. LBS.

IN-PROCESS VIEW 4

**PROPRIETARY NOTE**  
 THIS DOCUMENT CONTAINS CONFIDENTIAL AND PROPRIETARY INFORMATION AND ALL DESIGN, MANUFACTURING, REPRODUCTION, USE, PATENT RIGHTS AND SALES RIGHTS ARE EXPRESSLY RESERVED BY SAMTEC, INC. THIS DOCUMENT SHALL NOT BE DISCLOSED, IN WHOLE OR PART, TO ANY UNAUTHORIZED PERSON OR ENTITY NOR REPRODUCED, TRANSFERRED OR INCORPORATED IN ANY OTHER PROJECT IN ANY MANNER WITHOUT THE EXPRESS WRITTEN CONSENT OF SAMTEC, INC.



520 PARK EAST BLVD, NEW ALBANY, IN 47150  
 PHONE: 812-944-6733 FAX: 812-948-5047  
 e-Mail info@SAMTEC.com code 55322

DO NOT SCALE DRAWING

SHEET SCALE: 3:1

DESCRIPTION: 3.5MM JACK. SOLDER CLAMP FOR SEMFLEX HP160 CABLE

DWG. NO. PRF35-J-C-EP-160-SS

BY: SAMUEL C 05/07/2019 SHEET 3 OF 3