

DO NOT SCALE FROM THIS PRINT

DESIGNED AND DIMENSIONED IN INCHES[MILLIMETERS]
ALL DIMENSIONS REFERENCE EXCEPT AS SHOWN

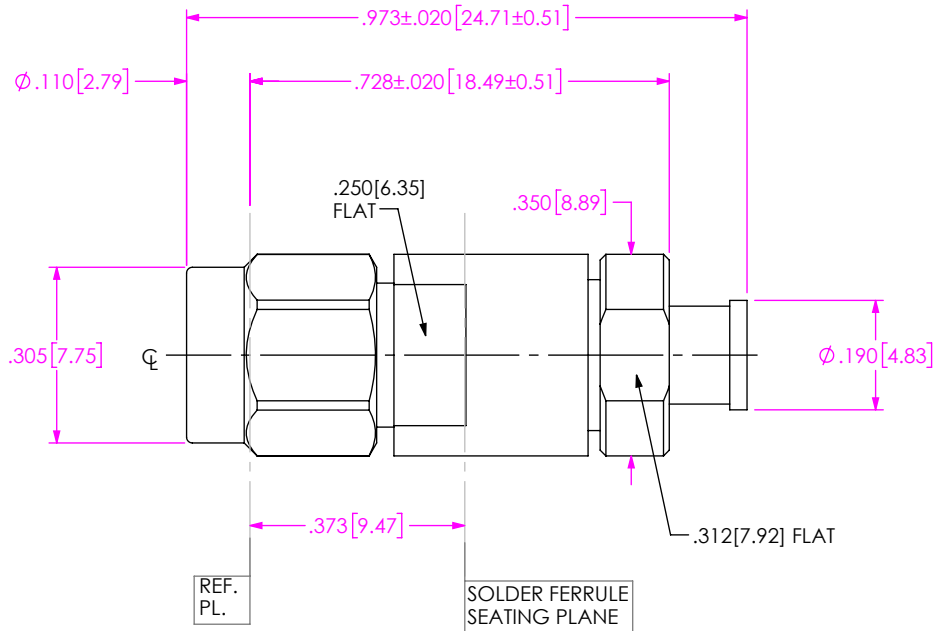

PRF92-P-C-EP-086-SS-1-X

SERIES
-92: 2.92MM

GENDER
-P: PLUG

TYPE
-C: CABLE

FINISH
-EP: 50µ" EXTRA HEAVY GOLD CENTER CONTACT, PASSIVATED OUTER CONTACT

PACKAGING
-B: BULK (IN INCREMENTS OF 50) (BLANK): STANDARD PACKAGING

OPTION
-1

TERMINATION
-S: SOLDER CLAMP

ORIENTATION
-S: STRAIGHT

CABLE TYPE
-086: TEMP FLEX 1001935086

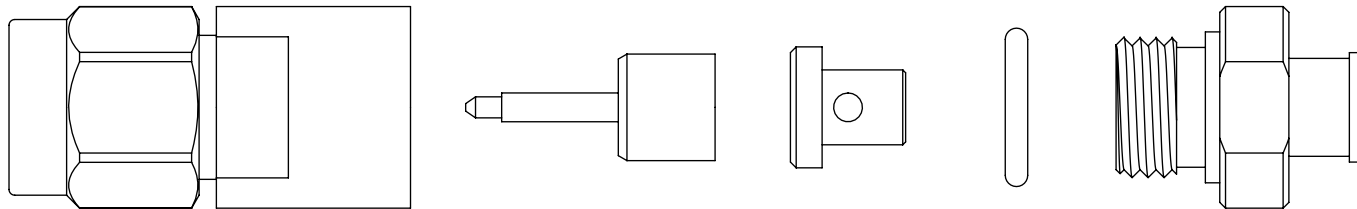
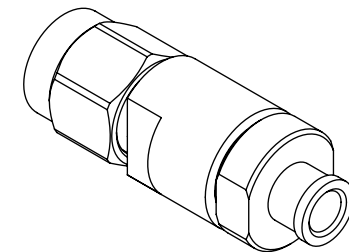

EXPLODED VIEW
NOT TO SCALE
(FOR CLARITY ONLY)

- NOTES:
- MATERIAL:**
BODY, CLAMP NUT, COUPLING NUT, OUTER CONTACT: STAINLESS STEEL.
GASKET, O-RING: SILICONE RUBBER.
BEAD: PCTFE.
SOLDER FERRULE: BRASS ALLOY
CONTACT, LOCK RING: BERYLLIUM COPPER.
 - FINISH:**
BODY, CLAMP NUT, COUPLING NUT, OUTER CONTACT: PASSIVATED.
CONTACT: 50 µ" MIN GOLD OVER 50 µ" MIN NICKEL.
SOLDER FERRULE: 10 µ" MIN GOLD OVER 50 µ" MIN NICKEL.

<p>PROPRIETARY NOTE</p> <p>THIS DOCUMENT CONTAINS CONFIDENTIAL AND PROPRIETARY INFORMATION AND ALL DESIGN, MANUFACTURING, REPRODUCTION, USE, PATENT RIGHTS AND SALES RIGHTS ARE EXPRESSLY RESERVED BY SAMTEC, INC. THIS DOCUMENT SHALL NOT BE DISCLOSED, IN WHOLE OR PART, TO ANY UNAUTHORIZED PERSON OR ENTITY NOR REPRODUCED, TRANSFERRED OR INCORPORATED IN ANY OTHER PROJECT IN ANY MANNER WITHOUT THE EXPRESS WRITTEN CONSENT OF SAMTEC, INC.</p>	<p>520 PARK EAST BLVD, NEW ALBANY, IN 47150 PHONE: 812-944-6733 FAX: 812-948-5047 e-Mail: info@SAMTEC.com code 55322</p>
	<p>DESCRIPTION: 2.92MM PLUG, SOLDER CLAMP FOR TEMP FLEX 1001935086</p>
<p>DO NOT SCALE DRAWING SHEET SCALE: 3:1</p>	<p>DWG. NO. PRF92-P-C-EP-086-SS-1-X</p>
<p>F:\DWG\SW\Exisprod\Assembly\RF\292\PRF92-P-C-EP-086-SS-1-X\PRF92-P-C-EP-086-SS-1-X.SLDDRW</p>	<p>BY: SHERRY W 4/29/2020 SHEET 1 OF 2</p>

CABLE APPLICATION VIEWS

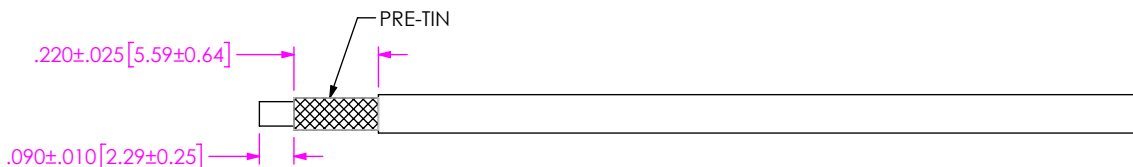

1A. TRIM CABLE TO EXPOSE OUTER BRAID AND DIELECTRIC CORE AS SHOWN.

IN-PROCESS VIEW 1

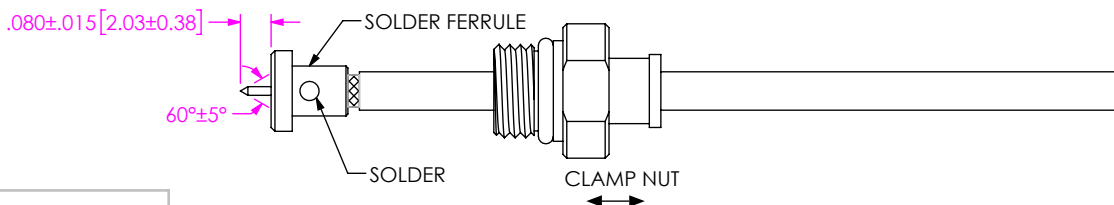

2A. SLIDE CLAMP NUT, ADD O-RING ONTO CABLE IN ORIENTATION AS SHOWN.
 2B. INSERT CABLE INTO SOLDER FERRULE UNTIL BRAIDS SEAT IN FERRULE. THEN SOLDER CABLE TO FERRULE WHERE SHOWN.
 2C. TRIM CABLE DIELECTRIC FLUSH WITH FERRULE FACE (DO NOT SCORE CENTER CONDUCTOR). THEN POINT CENTER CONDUCTOR AS SHOWN.

IN-PROCESS VIEW 2

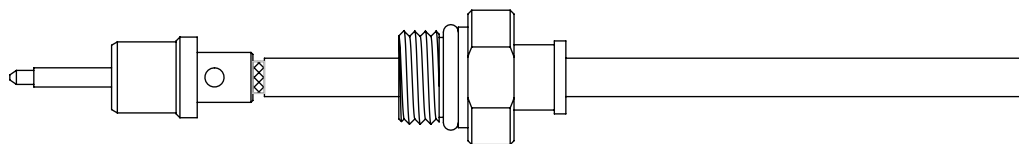

3A. SLIDE CONTACT/BUSHING SUB-ASSEMBLY INTO CONNECTOR HEAD UNTIL SEATED (SLIP FIT)

IN-PROCESS VIEW 3

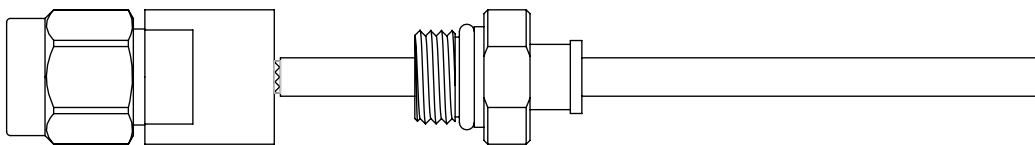

4A. INSERT CABLE SUB-ASSEMBLY INTO CONNECTOR BODY UNTIL SOLDER FERRULE IS SEATED

IN-PROCESS VIEW 4

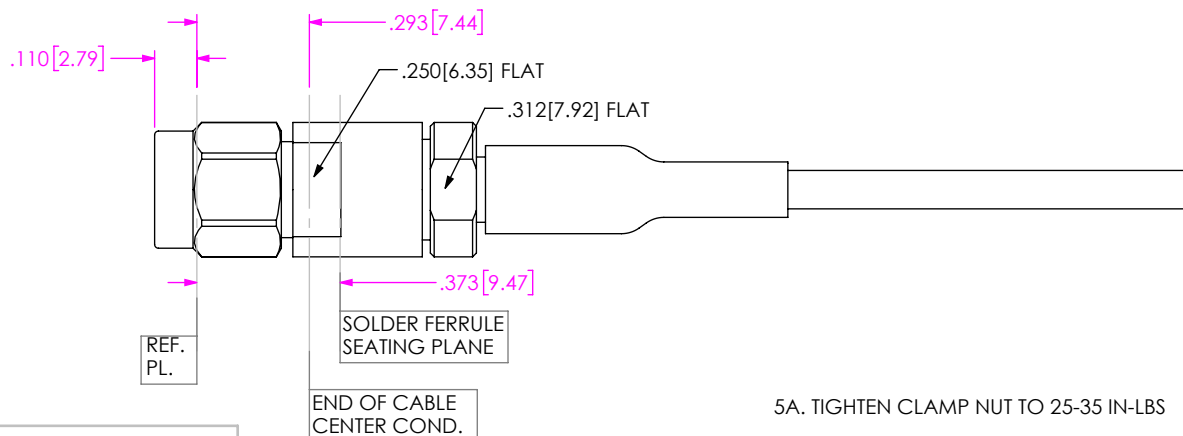

DISTANCE FROM END OF CABLE CENTER CONDUCTOR TO REF PLANE IS .293 REF.

5A. TIGHTEN CLAMP NUT TO 25-35 IN-LBS

IN-PROCESS VIEW 5

PROPRIETARY NOTE
 THIS DOCUMENT CONTAINS CONFIDENTIAL AND PROPRIETARY INFORMATION AND ALL DESIGN, MANUFACTURING, REPRODUCTION, USE, PATENT RIGHTS AND SALES RIGHTS ARE EXPRESSLY RESERVED BY SAMTEC, INC. THIS DOCUMENT SHALL NOT BE DISCLOSED, IN WHOLE OR PART, TO ANY UNAUTHORIZED PERSON OR ENTITY NOR REPRODUCED, TRANSFERRED OR INCORPORATED IN ANY OTHER PROJECT IN ANY MANNER WITHOUT THE EXPRESS WRITTEN CONSENT OF SAMTEC, INC.



520 PARK EAST BLVD, NEW ALBANY, IN 47150
 PHONE: 812-944-6733 FAX: 812-948-5047
 e-Mail: info@SAMTEC.com code 55322

DO NOT SCALE DRAWING

SHEET SCALE: 2:1

DESCRIPTION: 2.92MM PLUG, SOLDER CLAMP FOR TEMP FLEX 1001935086

DWG. NO. PRF92-P-C-EP-086-SS-1-X

BY: SHERRY W 4/29/2020 SHEET 2 OF 2