

DO NOT SCALE FROM THIS PRINT

- NOTES:
 1. 80 POSITIONS NOT AVAILABLE AS STANDARD.
 2. Ⓢ REPRESENTS A CRITICAL DIMENSION.
 3. MAXIMUM VARIANCE: .002[0.05]
 4. MINIMUM PUSHOUT FORCE: 6 OZ.
 5. PIN CAN EXTEND PAST THE WALL: .003 [0.08]
 6. AVAILABLE ON -01 & -02 ONLY.
 7. AVAILABLE ON -03 ONLY.
 8. AVAILABLE ON -02 & -03 ONLY.
 9. SEE TABLE 1 FOR PACKAGING.

TABLE 1	
-XX	PACKAGING
-01	TRAY
-02	TRAY
-03	TAPE & REEL

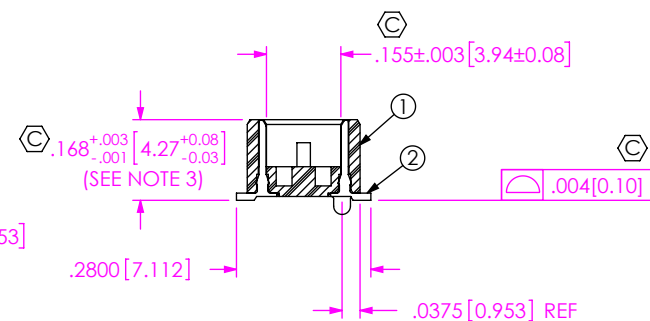
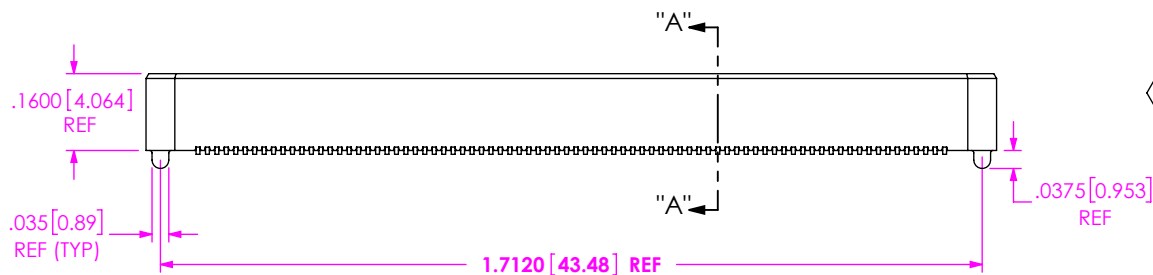
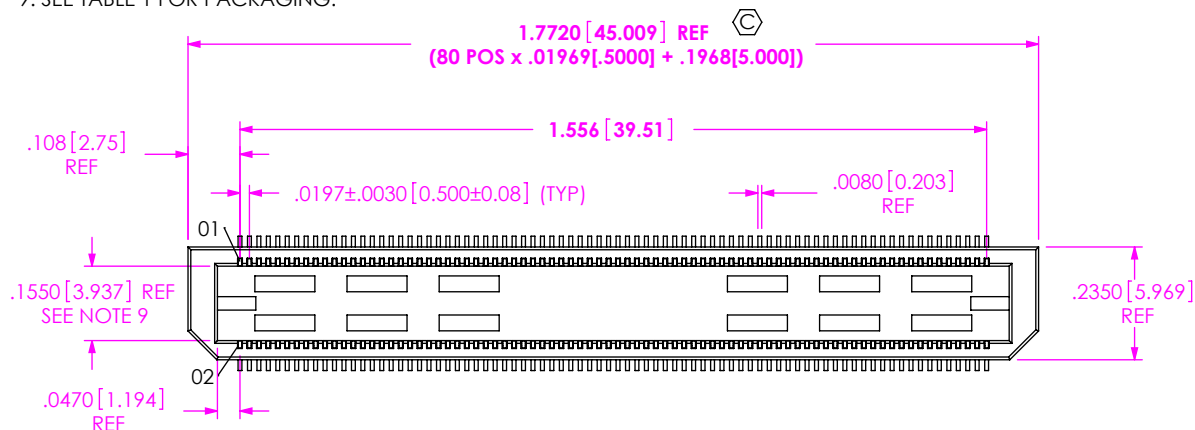

FIG 1
REF-178709-01 SHOWN

SECTION "A"- "A"

UNLESS OTHERWISE SPECIFIED, DIMENSIONS ARE IN INCHES. TOLERANCES ARE:
 DECIMALS ANGLES
 .XX: ±.01 [.3] 2°
 .XXX: ±.005 [.13]
 .XXXX: ±.0020 [.051]

PROPRIETARY NOTE
 THIS DOCUMENT CONTAINS INFORMATION CONFIDENTIAL AND PROPRIETARY TO SAMTEC, INC. AND SHALL NOT BE REPRODUCED OR TRANSFERRED TO OTHER DOCUMENTS OR DISCLOSED TO OTHERS OR USED FOR ANY PURPOSE OTHER THAN THAT WHICH IT WAS OBTAINED WITHOUT THE EXPRESSED WRITTEN CONSENT OF SAMTEC, INC.



520 PARK EAST BLVD, NEW ALBANY, IN 47150
 PHONE: 812-944-6733 FAX: 812-948-5047
 e-Mail: info@SAMTEC.com code 55322

DO NOT SCALE DRAWING SHEET SCALE: 2.5:1
 PLATING:
 CONTACT AREA: .000010 GOLD OVER .000050 NICKEL
 REMAINDER: .000200 REF TIN OVER .000050 NICKEL

DESCRIPTION:
 .5mm DOUBLE ROW TERMINAL ASSEMBLY

DWG. NO. REF-178709-XX

BY: J. BROWNING 09/11/2014 SHEET 1 OF 2

(SEE NOTE 8)
 (SEE NOTE 7)
 (SEE NOTE 6)

ITEM NO.	PART NUMBER	QUANTITY	MATERIAL
1	BTH-080-01-D-A	1.0000	VECTRA E130i, COLOR: BLACK
2	T-1S39-01-L	160.00	PHOS BRONZE, 510 SPRING TEMPER
3	K-DOT-.276-.375-.005	1.0000	POLYIMIDE FILM
4	CT-ASP3613MS	.00235	CONDUCTIVE POLYMER
5	TY-ASP209	.01786	ANTI-STATIC BLACK HIPS



FIG 2
REF-178709-02/-03 SHOWN
SAME AS FIG 1 EXCEPT AS SHOWN

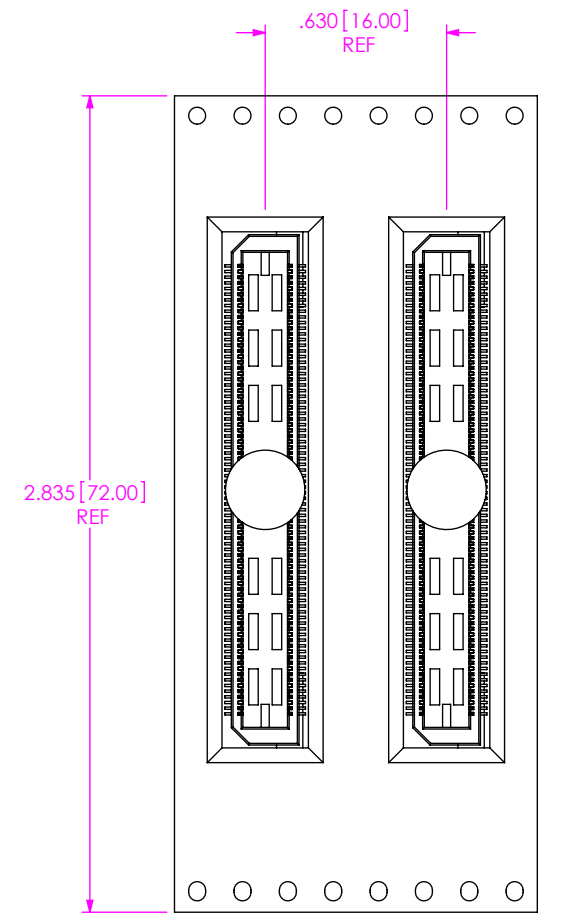

USER DIRECTION OF UN-REELING →
POCKET NOT DETAILED

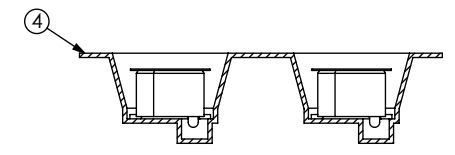

TAPE & REEL VIEW
(-03 ONLY)

PROPRIETARY NOTE

THIS DOCUMENT CONTAINS INFORMATION
CONFIDENTIAL AND PROPRIETARY TO
SAMTEC, INC. AND SHALL NOT BE REPRODUCED
OR TRANSFERRED TO OTHER DOCUMENTS OR
DISCLOSED TO OTHERS OR USED FOR ANY
PURPOSE OTHER THAN THAT WHICH IT WAS
OBTAINED WITHOUT THE EXPRESSED WRITTEN
CONSENT OF SAMTEC, INC.



520 PARK EAST BLVD. NEW ALBANY, IN 47150
PHONE: 812-944-6733 FAX: 812-948-5047
e-Mail info@SAMTEC.com code 55322

SHEET SCALE: 2.5:1

DESCRIPTION:
.5mm DOUBLE ROW TERMINAL ASSEMBLY

DWG. NO. REF-178709-XX