

DO NOT SCALE FROM THIS PRINT

SMA-J-C-X-ST-BR4

GENDER
-J: JACK

TERMINATION
-BR4: REVERSE POLARITY BULKHEAD (MH113)

TYPE
-C: CABLE

ORIENTATION
-ST: STRAIGHT

PLATING SPECIFICATION
-H: HEAVY GOLD (SEE NOTES 7 & 8)
(SMA-J-C-X-ST-BH4-SHL)
(SMA-INS-017)
(SMA-PIN-006-H)
(SMA-INS-004)
(SMA-LWAS-001-F)
(SMA-NUT-001-F)

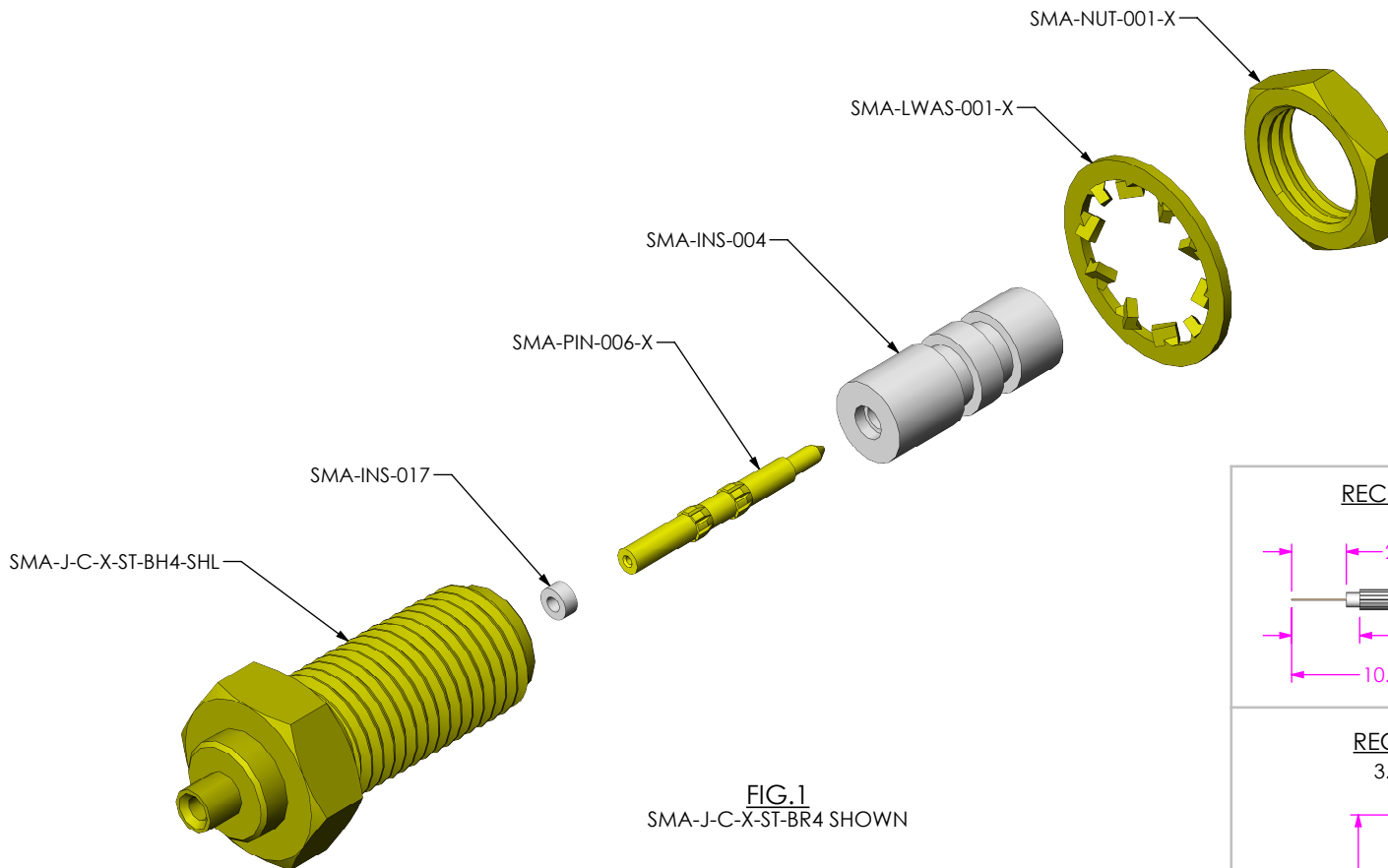
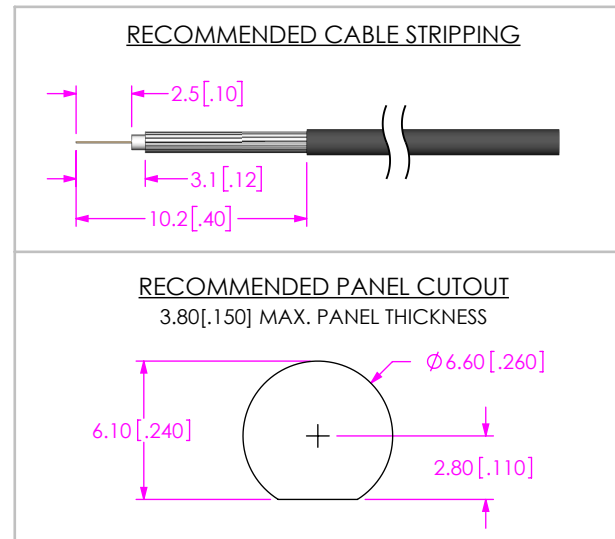

FIG.1
SMA-J-C-X-ST-BR4 SHOWN



NOTES:

1. REPRESENTS A CRITICAL DIMENSION.
2. CENTER CONTACT PUSHOUT FORCE = 13.35 N [3 LB] MIN.
3. SEE SHEET 3 FOR TERMINATION INFORMATION.
4. NOTE DELETED.
5. PRODUCT TO BE PACKAGED PER PACKAGING STANDARD CO-RF-WI-3040-M.
6. RoHS COMPLIANT.
7. PLATING: -F: .00003" MIN GOLD OVER .000050" MIN NICKEL.
-H: .000030" MIN GOLD OVER .000050" MIN NICKEL.
8. ASSEMBLY PLATING DESIGNATIONS:
-H: (CENTER CONTACT)-H
(OUTER CONTACT) -F
(REMAINING METAL PARTS) -F

<p>UNLESS OTHERWISE SPECIFIED, DIMENSIONS ARE IN MILLIMETERS [INCHES].</p> <p>TOLERANCES ARE:</p> <table border="0"> <tr> <td>DECIMALS</td> <td>ANGLES</td> </tr> <tr> <td>.X: ±0.3 [.01]</td> <td>2°</td> </tr> <tr> <td>.XX: ±0.13 [.005]</td> <td></td> </tr> <tr> <td>.XXX: ±0.051 [.0020]</td> <td></td> </tr> </table>		DECIMALS	ANGLES	.X: ±0.3 [.01]	2°	.XX: ±0.13 [.005]		.XXX: ±0.051 [.0020]		<p>PROPRIETARY NOTE</p> <p>THIS DOCUMENT CONTAINS CONFIDENTIAL AND PROPRIETARY INFORMATION AND ALL DESIGN, MANUFACTURING, REPRODUCTION, USE, PATENT RIGHTS AND SALES RIGHTS ARE EXPRESSLY RESERVED BY SAMTEC, INC. THIS DOCUMENT SHALL NOT BE DISCLOSED, IN WHOLE OR PART, TO ANY UNAUTHORIZED PERSON OR ENTITY NOR REPRODUCED, TRANSFERRED OR INCORPORATED IN ANY OTHER PROJECT IN ANY MANNER WITHOUT THE EXPRESS WRITTEN CONSENT OF SAMTEC, INC.</p>
DECIMALS	ANGLES									
.X: ±0.3 [.01]	2°									
.XX: ±0.13 [.005]										
.XXX: ±0.051 [.0020]										
<p>MATERIAL: DO NOT SCALE DRAWING SHEET SCALE: 3:1</p>										
<p>SHELL, NUT & WASHER: BRASS CONTACT: BRASS DIELECTRIC: PTFE</p>										



520 PARK EAST BLVD. NEW ALBANY, IN 47150
PHONE: 812-944-6733 FAX: 812-948-5047
e-Mail info@SAMTEC.com code 55322

DESCRIPTION:	SMA STR JACK REV POLARITY BULKHEAD, MH113- 50 OHM
DWG. NO.	SMA-J-C-X-ST-BR4
BY:	R MUSSER 01/28/2008 SHEET 1 OF 3

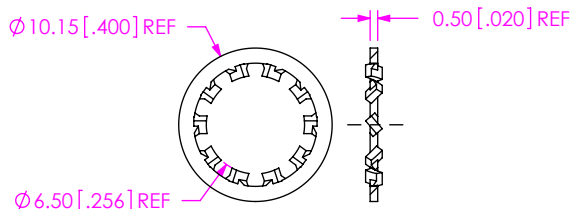

SAMTEC PART NUMBER	ITEM
SMA-LWAS-001-X	LOCK WASHER

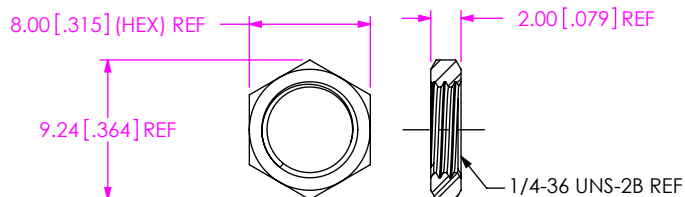

SAMTEC PART NUMBER	ITEM
SMA-NUT-001-X	HEX NUT

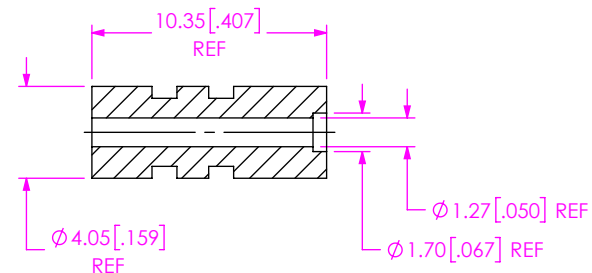

SAMTEC PART NUMBER	ITEM
SMA-INS-004	INSULATOR

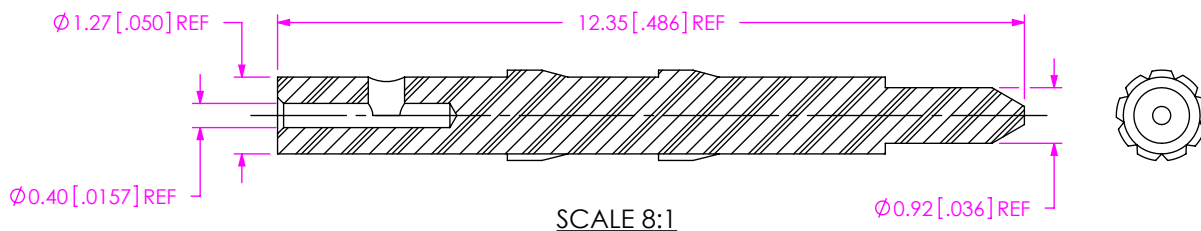

SAMTEC PART NUMBER	ITEM
SMA-PIN-006-X	PIN

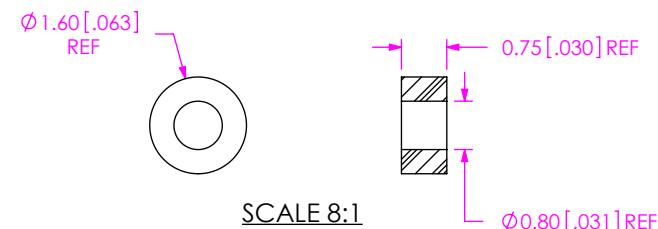

SAMTEC PART NUMBER	ITEM
SMA-INS-017	INSULATOR

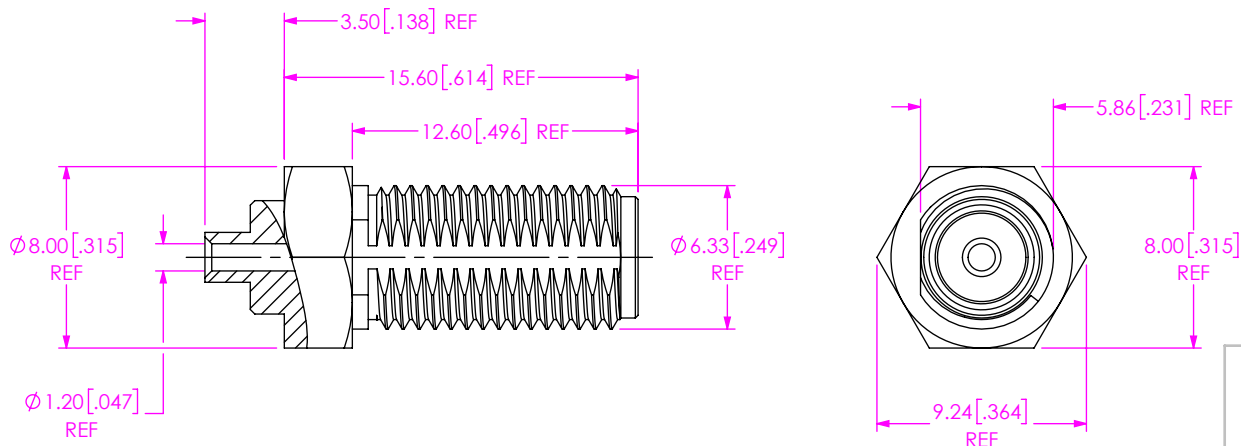

SAMTEC PART NUMBER	ITEM
SMA-J-C-X-ST-BH4-SHL	SHELL

F:\DWG\MISC\MKTG\SMA-J-C-X-ST-BR4-MKT.SLDDRW

PROPRIETARY NOTE
 THIS DOCUMENT CONTAINS CONFIDENTIAL AND PROPRIETARY INFORMATION AND ALL DESIGN, MANUFACTURING, REPRODUCTION, USE, PATENT RIGHTS AND SALES RIGHTS ARE EXPRESSLY RESERVED BY SAMTEC, INC. THIS DOCUMENT SHALL NOT BE DISCLOSED, IN WHOLE OR PART, TO ANY UNAUTHORIZED PERSON OR ENTITY NOR REPRODUCED, TRANSFERRED OR INCORPORATED IN ANY OTHER PROJECT IN ANY MANNER WITHOUT THE EXPRESS WRITTEN CONSENT OF SAMTEC, INC.

DO NOT SCALE DRAWING

SHEET SCALE: 2:1



520 PARK EAST BLVD, NEW ALBANY, IN 47150
 PHONE: 812-944-6733 FAX: 812-948-5047
 e-Mail info@SAMTEC.com code 55322

DESCRIPTION:
 SMA STR JACK REV POLARITY BULKHEAD, MH113- 50 OHM

DWG. NO. **SMA-J-C-X-ST-BR4**

BY: R MUSSER 01/28/2008 SHEET 2 OF 3

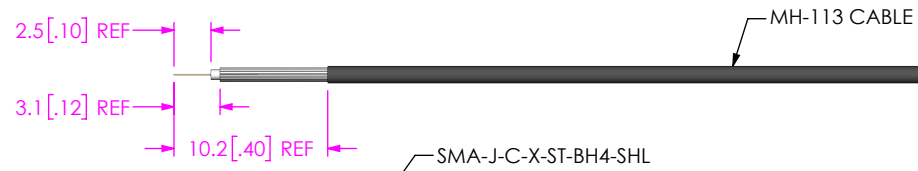

STRIP AND TIN INNER AND OUTER CONDUCTOR

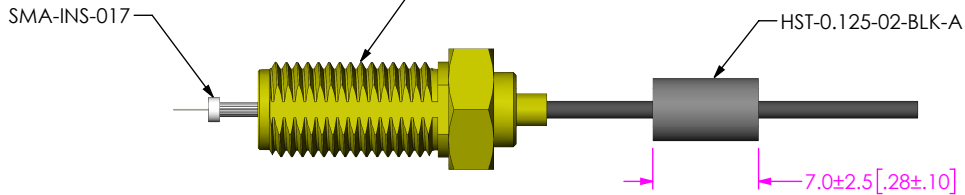

ADD HEAT SHRINK TUBE, SHELL AND INSULATOR

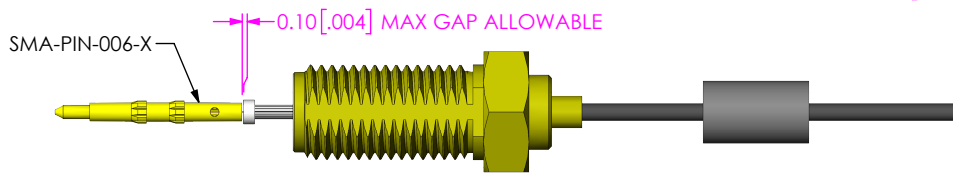

SOLDER SIGNAL SOCKET

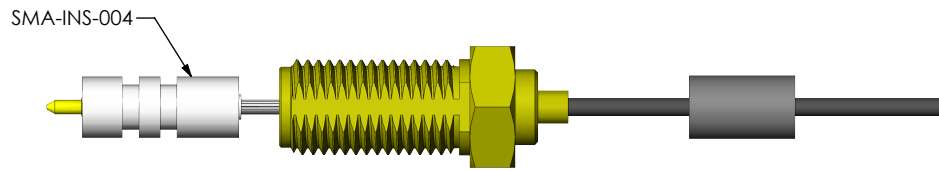

ADD INSULATOR

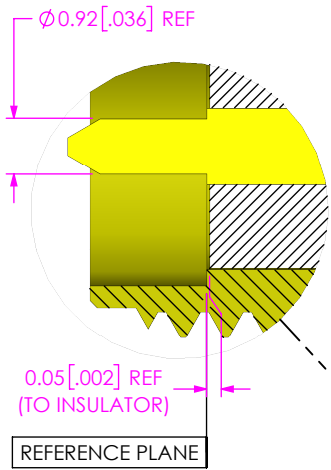

DETAIL 'A'
SCALE 8 : 1

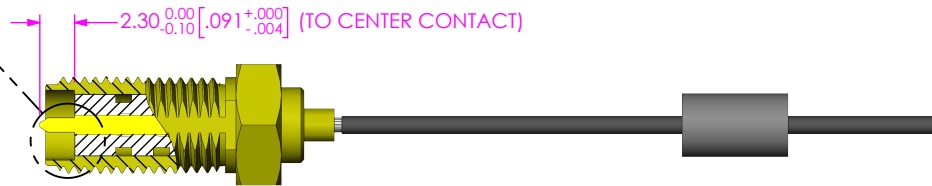

PRESS THE CONTACT/INSULATORS INTO THE SHELL
THEN SOLDER THE SHELL

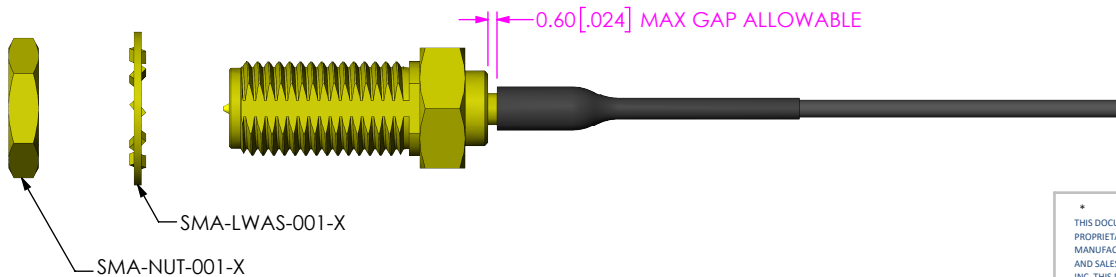

APPLY HEAT SHRINK TUBING

F:\DWG\MISC\MKTG\SMA-J-C-X-ST-BR4-MKT.SLDDRW

PROPRIETARY NOTE
THIS DOCUMENT CONTAINS CONFIDENTIAL AND PROPRIETARY INFORMATION AND ALL DESIGN, MANUFACTURING, REPRODUCTION, USE, PATENT RIGHTS AND SALES RIGHTS ARE EXPRESSLY RESERVED BY SAMTEC, INC. THIS DOCUMENT SHALL NOT BE DISCLOSED, IN WHOLE OR PART, TO ANY UNAUTHORIZED PERSON OR ENTITY NOR REPRODUCED, TRANSFERRED OR INCORPORATED IN ANY OTHER PROJECT IN ANY MANNER WITHOUT THE EXPRESS WRITTEN CONSENT OF SAMTEC, INC.

DO NOT SCALE DRAWING

SHEET SCALE: 2:1



520 PARK EAST BLVD, NEW ALBANY, IN 47150
PHONE: 812-944-6733 FAX: 812-948-5047
e-Mail info@SAMTEC.com code 55322

DESCRIPTION:
SMA STR JACK REV POLARITY BULKHEAD, MH113- 50 OHM

DWG. NO.
SMA-J-C-X-ST-BR4

BY: R MUSSER 01/28/2008 SHEET 3 OF 3