

REVISION

**THIS PRODUCT MANUFACTURED WITH LEAD-FREE PROCESSING**

**DESIGNED & DIMENSIONED IN MILLIMETERS [INCHES]**

DO NOT SCALE FROM THIS PRINT

TNC-P-C-XX-ST-CA1S

GENDER -P: PLUG  
 TYPE -C: CABLE  
 TERMINATION CA1S: CCA-316-S (RG-316 CABLE, DOUBLE SHIELD)  
 ORIENTATION -ST: STRAIGHT

PLATING SPECIFICATION  
 -GN: 10μ" GOLD CENTER CONTACT,  
 3μ" GOLD OUTER CONTACT  
 100μ" NICKEL REMAINING PARTS  
 (SEE TABLE 1)

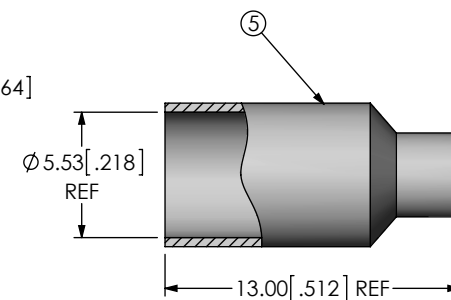
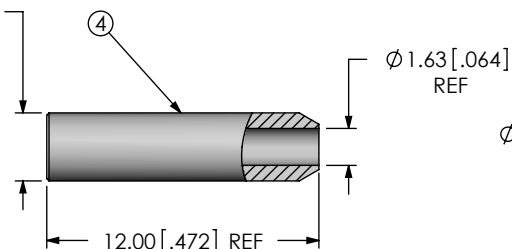
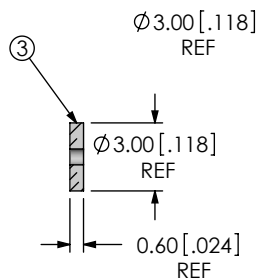
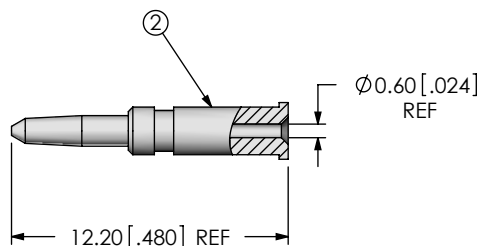
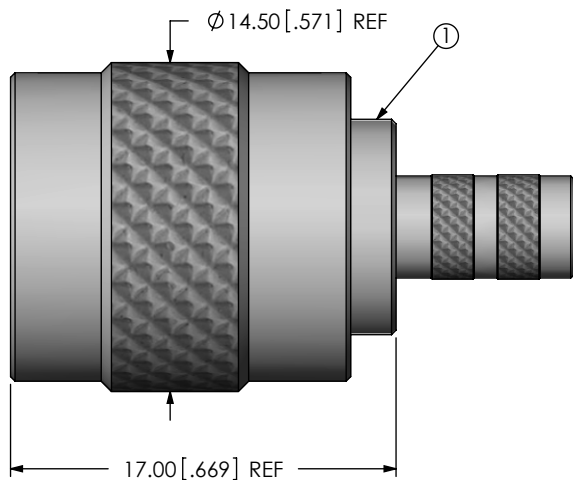



TABLE 1

ITEM	COMPONENT	-GN
1	SUB ASSEMBLY	SUB-TNC-P-C-N-ST-CA1
2	PIN	TNC-PIN-001-G
3	INSULATOR	TNC-INS-001
4	FERRULE 1	TNC-FER-001-N
5	FERRULE 2	TNC-FER-005-N

NOTES:

- ① REPRESENTS A CRITICAL DIMENSION.
- PRODUCT TO BE PACKAGED PER PACKING STANDARD CO-RF-WI-3040-M.  
 TRAY: TY-BNC002-1  
 COVER: TY-BNC002-2  
 36 PARTS PER TRAY (1 PARTS PER POCKET).
- PIN & FERRULE TO BE PACKAGED SEPARATELY.

UNLESS OTHERWISE SPECIFIED DIMENSIONS ARE IN MILLIMETERS [INCHES] TOLERANCES ARE: DECIMALS ANGLES .X: ±0.3 [.01] 5° .XX: ±0.13 [.005] .XXX: ±0.051 [.0020]	PROPRIETARY NOTE THIS DOCUMENT CONTAINS INFORMATION CONFIDENTIAL AND PROPRIETARY TO SAMTEC, INC. AND SHALL NOT BE REPRODUCED OR TRANSFERRED TO OTHER DOCUMENTS OR DISCLOSED TO OTHERS OR USED FOR ANY PURPOSE OTHER THAN THAT WHICH IT WAS OBTAINED WITHOUT THE EXPRESSED WRITTEN CONSENT OF SAMTEC, INC.	 520 PARK EAST BLVD, NEW ALBANY, IN 47150 PHONE: 812-944-6733 FAX: 812-948-5047 e-Mail info@SAMTEC.com code 55322	
		DESCRIPTION: TNC STRAIGHT CABLE PLUG, RD316 - 50 OHM	
MATERIAL: DO NOT SCALE DRAWING SHEET SCALE: 3:1 SHELL, FERRULE: BRASS CONTACT: BRASS DIELECTRIC: PTFE GASKET: SILICONE		DWG. NO. TNC-P-C-XX-ST-CA1S	
BY: ALVIN W 06/27/2013		SHEET 1 OF 2	



IN-PROCESS 1  
STRIP AND TIN INNER CONDUCTOR

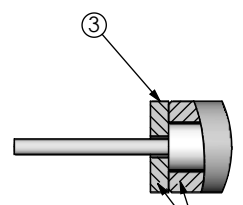

DETAIL 'B'  
SCALE 4:1

TNC-INS-001 & TNC-FER-001-X  
TO BE FLUSH WITH CABLE DIELECTRIC

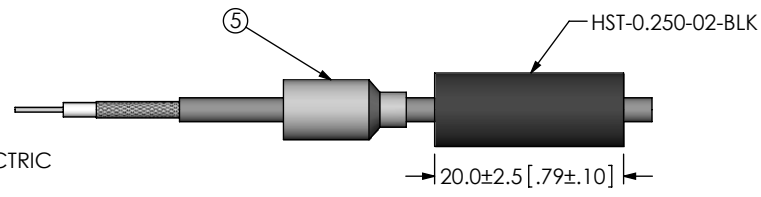

IN-PROCESS 2  
ADD HEAT SHRINK TUBE AND FERRULE

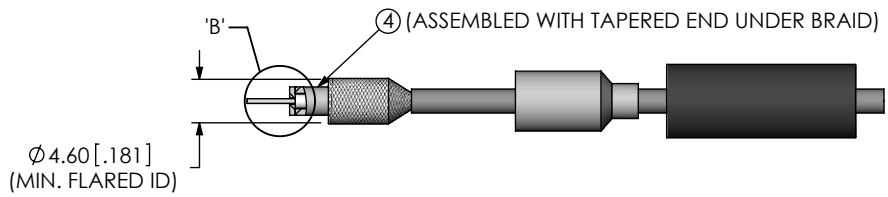

IN-PROCESS 3  
FLARE SHIELD, ADD INNER FERRULE AND INSULATOR

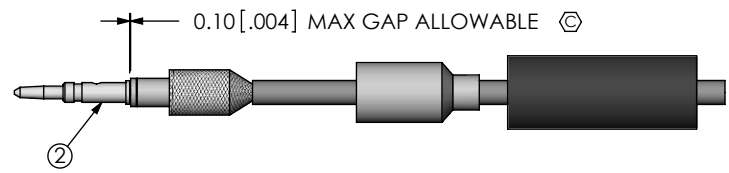

IN-PROCESS 4  
SOLDER SIGNAL PIN

0.45 [.018] REF  
TO CENTER CONTACT

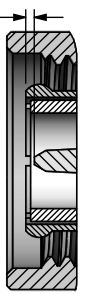

DETAIL 'A'  
SCALE 2.5:1

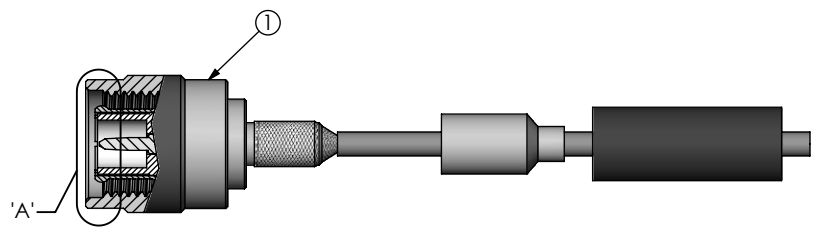

IN-PROCESS 5  
ADD SUB-TNC-P-C-X-ST-CA1

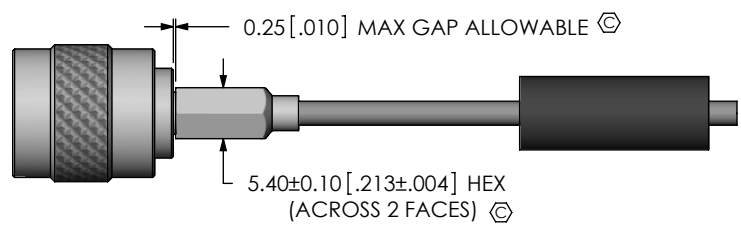

IN-PROCESS 6  
CRIMP FERRULE  
(USE RF CRIMP HAND TOOL #CAT-HT-126667-21 OR EQUIVALENT)  
(USE .213" HEX DIE)

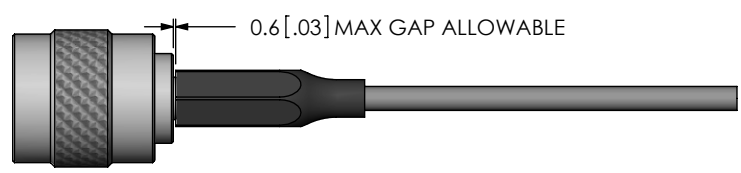

IN-PROCESS 7  
APPLY HEAT SHRINK TUBE

<p>PROPRIETARY NOTE</p> <p>THIS DOCUMENT CONTAINS INFORMATION CONFIDENTIAL AND PROPRIETARY TO SAMTEC, INC. AND SHALL NOT BE REPRODUCED OR TRANSFERRED TO OTHER DOCUMENTS OR DISCLOSED TO OTHERS OR USED FOR ANY PURPOSE OTHER THAN THAT WHICH IT WAS OBTAINED WITHOUT THE EXPRESSED WRITTEN CONSENT OF SAMTEC, INC.</p>			
	<p>520 PARK EAST BLVD., NEW ALBANY, IN 47150 PHONE: 812-944-6733 FAX: 812-948-5047 e-Mail: info@SAMTEC.com code 55322</p>		
	<p>DO NOT SCALE DRAWING</p>	<p>DESCRIPTION: TNC STRAIGHT CABLE PLUG, RD316 - 50 OHM</p>	
<p>SHEET SCALE: 1:0.8</p>	<p>DWG. NO. TNC-P-C-XX-ST-CA1S</p>		
	<p>BY: ALVIN W</p>	<p>06/27/2013</p>	<p>SHEET 2 OF 2</p>