

DESIGNED AND DIMENSIONED IN MILLIMETERS[INCHES]
EXCEPT WHERE NOTED, ALL DIMENSIONS ARE REFERENCE

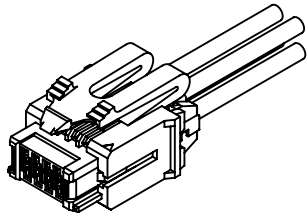

TABLE 1	
No. OF POS	"A"
-02	12.85 [.506]
-03	14.85 [.585]
-04	16.85 [.663]
-05	18.85 [.742]
-06	20.85 [.821]
-07	22.85 [.900]
-08	24.85 [.978]
-09	26.85 [1.057]
-10	28.85 [1.136]

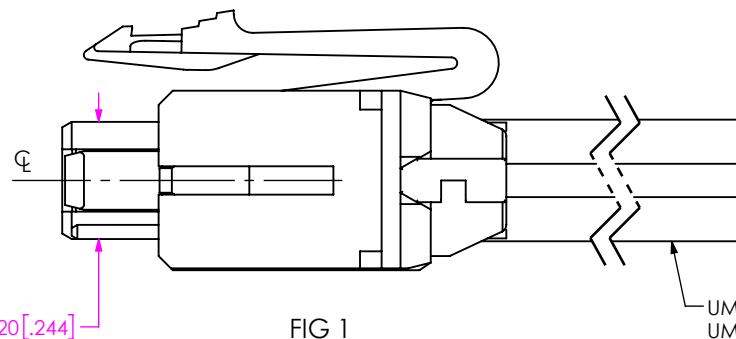
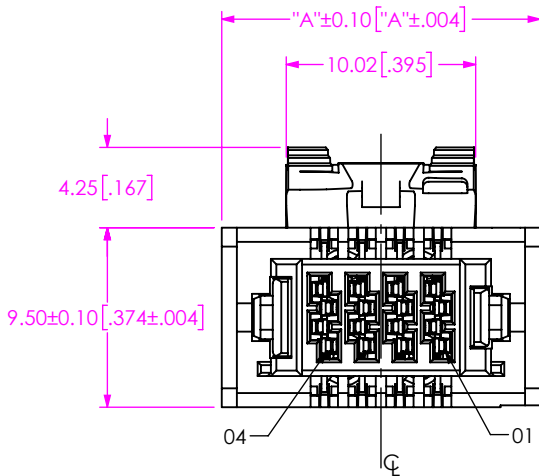
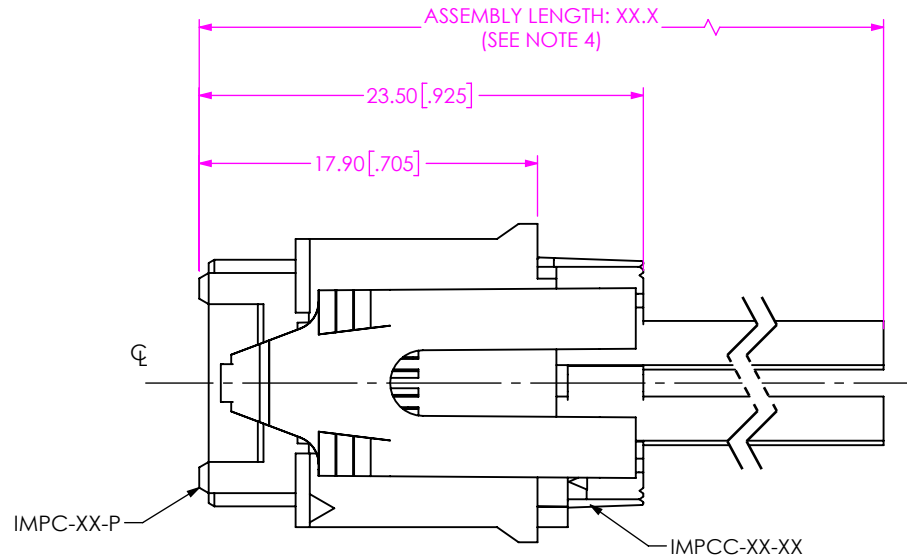

FIG 1
UMPCX-04-X-XXX-P-XX.X SHOWN

UMPCX-XX-X-XXX-X-XX.X-X

FEP CABLE OPTION
-T: FEP INSULATION (ONLY AVAILABLE WITH -M LATCHING)
(LEAVE BLANK FOR STANDARD PVC INSULATION)

No OF POSITIONS
-02, -03, -04, -05,
-06, -07, -08, -09,
-10

PLATING SPECIFICATION
-T: BRIGHT ACID TIN (BAT)
-L: 10μ" SELECTIVE GOLD IN CONTACT AREA, BRIGHT ACID TIN (BAT) ON THE TAIL.
-S: 30μ" SELECTIVE GOLD IN CONTACT AREA, BRIGHT ACID TIN (BAT) ON THE TAIL.

WIRE GAUGE
-16: 16 AWG
(UMPC USES 16 AWG 300 VOLT PVC)
(UMPC USES 16 AWG 600 VOLT FEP)
-18: 18 AWG
(UMPC USES 18 AWG 300 VOLT PVC)
(UMPC USES 18 AWG 300 VOLT FEP)

COLOR CODE
C: COLOR CODE WIRE
(SEE COLOR SEQUENCE TABLE, SHEET 3)
(LEAVE BLANK FOR STANDARD WIRE)
NOT AVAILABLE WITH UMPC

LATCH OPTIONS
(LATCHING REQUIRED.
MUST CHOOSE -P OR -M)
-P: PLASTIC TOP LATCH
-M: METAL SIDE LATCHES

ASSEMBLY LENGTH
SPECIFY IN INCHES
SINGLE ENDED: 03.0 INCHES MINIMUM
DOUBLE ENDED 2-4 POSITIONS : 04.0 INCHES MINIMUM
DOUBLE ENDED 5-10 POSITIONS : 05.0 INCHES MINIMUM
DOUBLE ENDED, FEP CABLE, 2-4 POSITIONS: 09.0 INCH MINIMUM
DOUBLE ENDED, FEP CABLE, 5-10 POSITIONS: 10.0 INCH MINIMUM

PINOUT
(LEAVE BLANK FOR SINGLE ENDED ASSEMBLY)
-1: PIN 01 TO 01
-2: PIN 01 TO N

NOTES:

- CONTACT MUST BE INSERTED UNTIL RETENTION FEATURE LOCKS INTO PLACE.
- ALL ASSEMBLIES TO BE 100% ELECTRICALLY TESTED FOR SHORTS AND OPENS.
- ALL FINISHED GOODS ARE TO BE ELECTRICAL TESTED INCLUDING HI-POT TEST @ 1000 VOLTS DC. AFTER FINAL ELECTRICAL TEST, LABEL EACH ASSEMBLY WITH (1) ET STAMP ON THE BODY.
- FOR LENGTHS LESS THAN 12 IN, TOLERANCE SHALL BE ±.125. FOR OTHER LENGTHS, TOLERANCES SHALL BE ±2%.
- CUT LENGTH IS ASSEMBLY LENGTH MINUS OVERALL LENGTH SUBTRACTOR.
- PARTS TO BE INDIVIDUALLY PACKAGED IN A ASBBLTXXXXX BUBBLE BAG.
- NOTE DELETED

PROPRIETARY NOTE

THIS DOCUMENT CONTAINS CONFIDENTIAL AND PROPRIETARY INFORMATION AND ALL DESIGN, MANUFACTURING, REPRODUCTION, USE, PATENT RIGHTS AND SALES RIGHTS ARE EXPRESSLY RESERVED BY SAMTEC, INC. THIS DOCUMENT SHALL NOT BE DISCLOSED, IN WHOLE OR PART, TO ANY UNAUTHORIZED PERSON OR ENTITY NOR REPRODUCED, TRANSFERRED OR INCORPORATED IN ANY OTHER PROJECT IN ANY MANNER WITHOUT THE EXPRESS WRITTEN CONSENT OF SAMTEC, INC.

DO NOT SCALE DRAWING
SHEET SCALE: 1:2

MATERIAL:
INSULATOR: LCP
CONTACT: COPPER ALLOY
HOLDER: NYLON
CAP: POLYPROPYLENE

samtec

520 PARK EAST BLVD, NEW ALBANY, IN 47150
PHONE: 812-944-6733 FAX: 812-948-5047
e-Mail: info@SAMTEC.com code 55322

DESCRIPTION:
2MM ULTRA MICRO POWER CABLE

DWG. NO.
UMPCX-XX-X-XXX-X-XX.X-X

BY: ETHAN C 07/17/2019 SHEET 1 OF 6

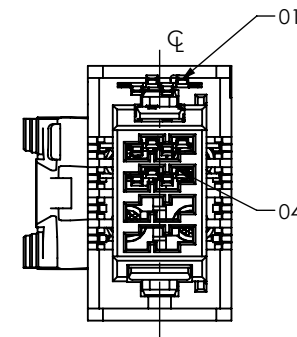
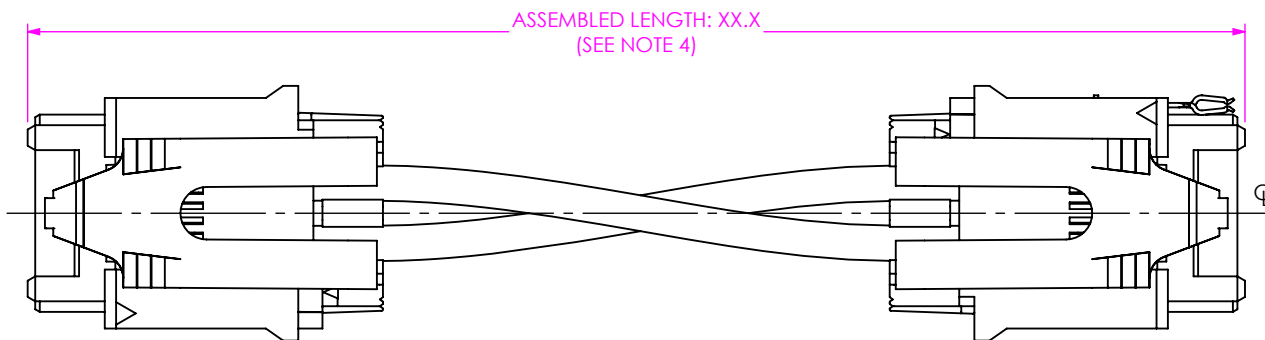
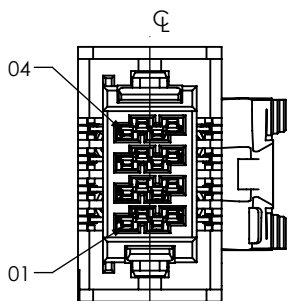

FIG 2
UMPCX-04-X-XXX-P-XX.X-1 SHOWN
(DIFFERENT AS SHOWN, OTHERWISE SAME AS FIG 1)

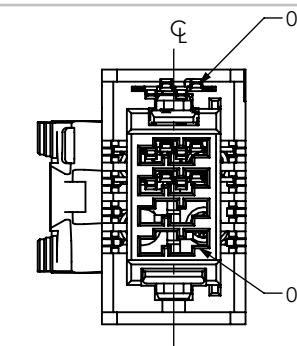
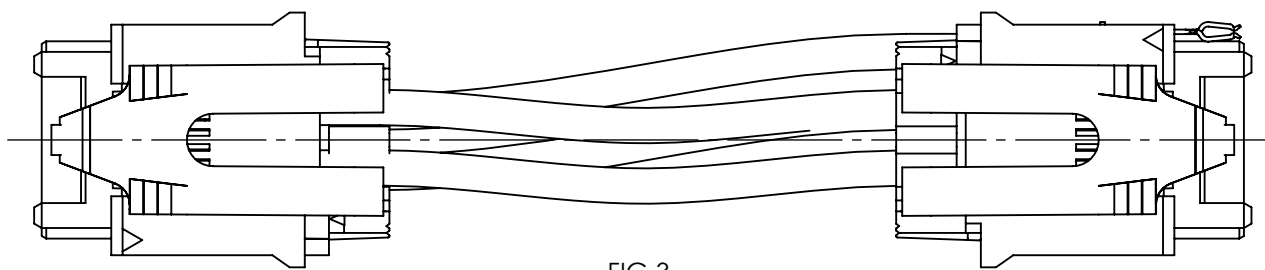
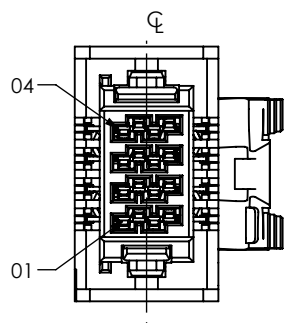

FIG 3
-02, -04, -06, -08, -10 Pos Only
UMPCX-04-X-XXX-P-XX.X-2 SHOWN
(DIFFERENT AS SHOWN, OTHERWISE SAME AS FIG 1 & FIG 2)

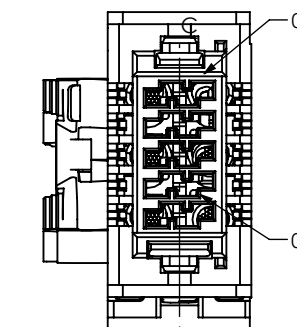
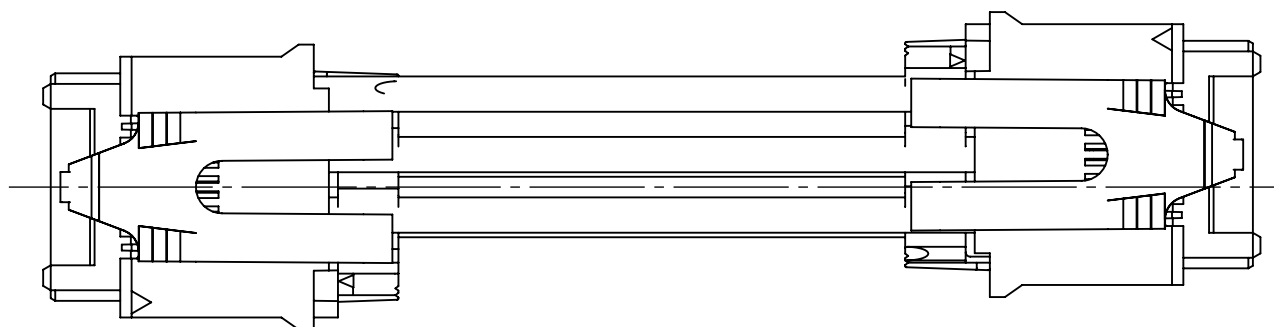
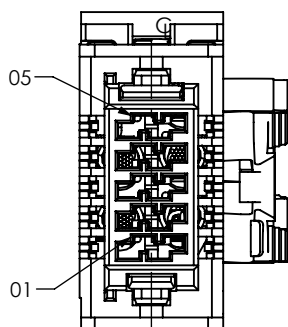

FIG 4
-03, -05, -07, -09 Pos Only
UMPCX-05-X-XXX-P-XX.X-2 SHOWN
(DIFFERENT AS SHOWN, OTHERWISE SAME AS FIG 1)

samtec

520 PARK EAST BLVD, NEW ALBANY, IN 47150
PHONE: 812-944-6733 FAX: 812-948-5047
e-Mail: info@SAMTEC.com code 55322

DO NOT SCALE DRAWING

SHEET SCALE: 1:1

DESCRIPTION:
2MM ULTRA MICRO POWER CABLE

DWG. NO.
UMPCX-XX-X-XXX-X-XX.X-X

BY: ETHAN C 07/17/2019 SHEET 2 OF 6

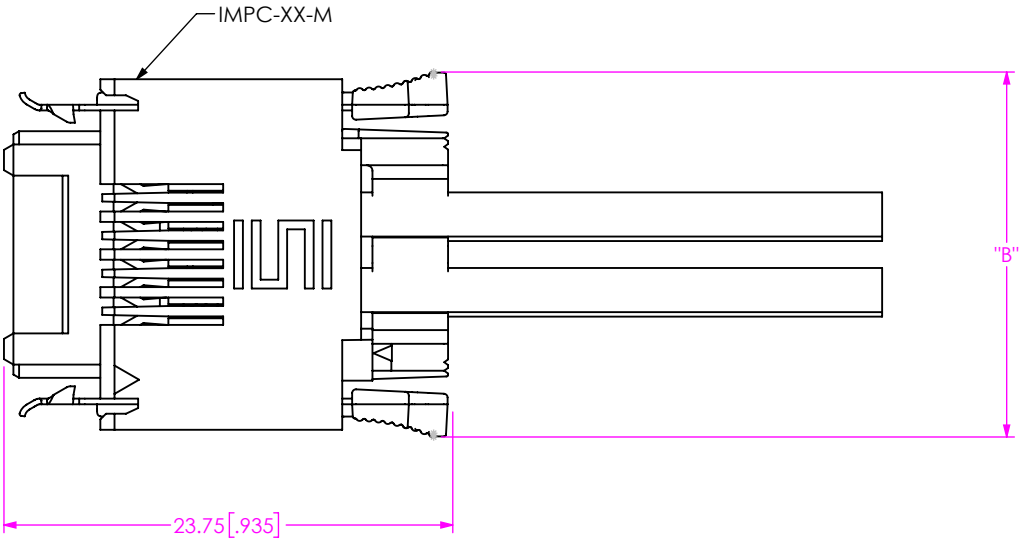

TABLE 2	
No. OF POS	"B"
-02	15.38 [.606]
-03	17.38 [.684]
-04	19.38 [.763]
-05	21.38 [.842]
-06	23.38 [.920]
-07	25.38 [.999]
-08	27.38 [1.078]
-09	29.38 [1.157]
-10	31.38 [1.235]

FIG 5
UMPC-04-X-XXX-M-XX.X SHOWN
(DIFFERENT AS SHOWN, OTHERWISE SAME AS FIG 1)

UMPC COLOR CODED WIRE SEQUENCE										
PIN #	COLOR									
	BROWN	RED	ORANGE	YELLOW	GREEN	BLUE	VIOLET	GRAY	WHITE	BLACK
1	2	3	4	5	6	7	8	9	10	

PROPRIETARY NOTE

THIS DOCUMENT CONTAINS CONFIDENTIAL AND PROPRIETARY INFORMATION AND ALL DESIGN, MANUFACTURING, REPRODUCTION, USE, PATENT RIGHTS AND SALES RIGHTS ARE EXPRESSLY RESERVED BY SAMTEC, INC. THIS DOCUMENT SHALL NOT BE DISCLOSED, IN WHOLE OR PART, TO ANY UNAUTHORIZED PERSON OR ENTITY NOR REPRODUCED, TRANSFERRED OR INCORPORATED IN ANY OTHER PROJECT IN ANY MANNER WITHOUT THE EXPRESS WRITTEN CONSENT OF SAMTEC, INC.

520 PARK EAST BLVD, NEW ALBANY, IN 47150
PHONE: 812-944-6733 FAX: 812-948-5047
e-Mail info@SAMTEC.com code 55322

DO NOT SCALE DRAWING

SHEET SCALE: 1:1

DESCRIPTION:
2MM ULTRA MICRO POWER CABLE

DWG. NO.
UMPCX-XX-X-XXX-X-XX.X-X

BY: ETHAN C 07/17/2019 SHEET 3 OF 6

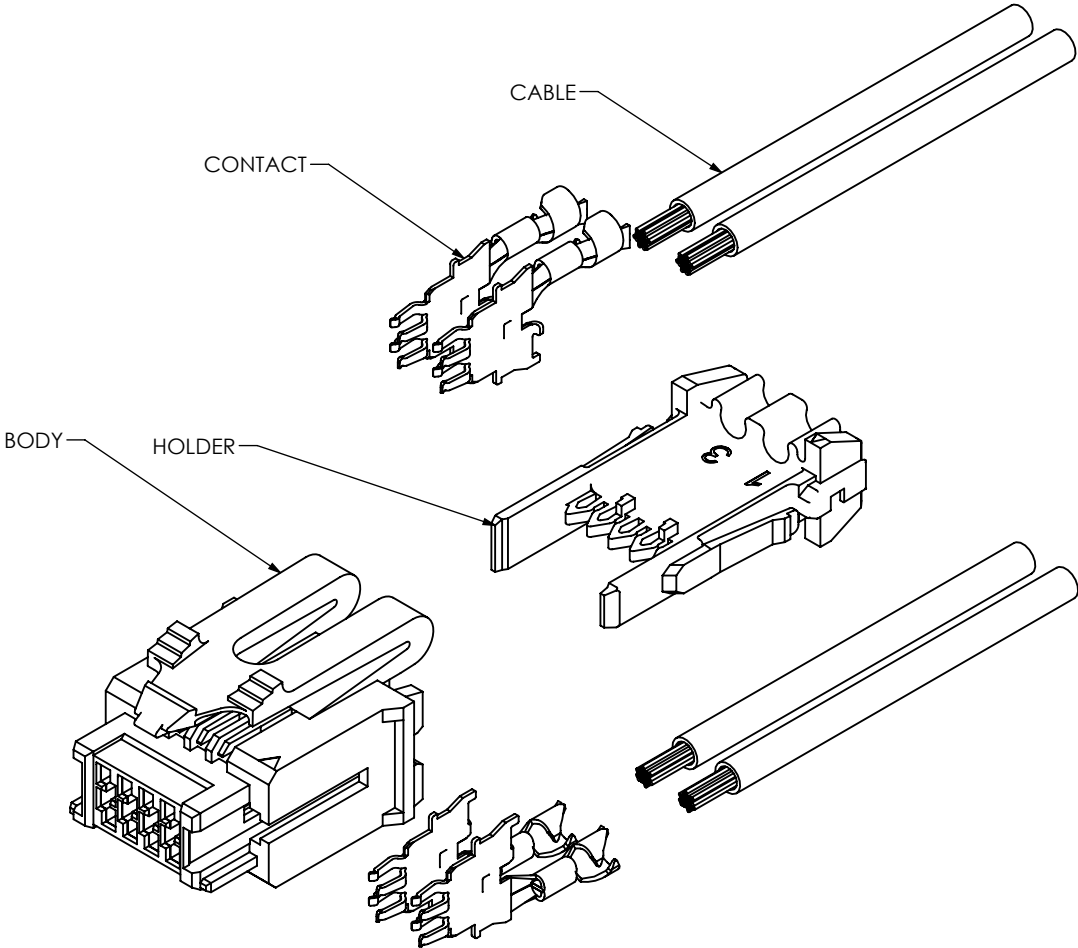

EXPLODED VIEW

TABLE 3

SERIES	WIRE GAUGE	VOLTAGE	BODY	HOLDER	CONTACT	CABLE
UMPC	16 AWG	300V	PLASTIC LATCH: IMPC-XX-P METAL LATCHES: IMPC-XX-M	IMPCC-XX-01	CC489-01-X-X	DWC-16-XX-300
	18 AWG			IMPCC-XX-02		DWC-18-XX-300
UMPCT	16 AWG	600V		IMPCC-XX-01	CC489-02-X-X	DWCT-16-01-600
	18 AWG	300V		IMPCC-XX-03		DWCT-18-01

PROPRIETARY NOTE

THIS DOCUMENT CONTAINS CONFIDENTIAL AND PROPRIETARY INFORMATION AND ALL DESIGN, MANUFACTURING, REPRODUCTION, USE, PATENT RIGHTS AND SALES RIGHTS ARE EXPRESSLY RESERVED BY SAMTEC, INC. THIS DOCUMENT SHALL NOT BE DISCLOSED, IN WHOLE OR PART, TO ANY UNAUTHORIZED PERSON OR ENTITY NOR REPRODUCED, TRANSFERRED OR INCORPORATED IN ANY OTHER PROJECT IN ANY MANNER WITHOUT THE EXPRESS WRITTEN CONSENT OF SAMTEC, INC.

520 PARK EAST BLVD, NEW ALBANY, IN 47150
PHONE: 812-944-6733 FAX: 812-948-5047
e-Mail: info@SAMTEC.com code 55322

DO NOT SCALE DRAWING

SHEET SCALE: 1:1

DESCRIPTION:
2MM ULTRA MICRO POWER CABLE

DWG. NO.
UMPCX-XX-X-XXX-X-XX.X-X

BY: ETHAN C 07/17/2019 SHEET 4 OF 6

REVISION K

IMPCC-XX-XX

17.40[.685]

ENSURE THAT ALL OF THE CONTACTS ARE
LOCKED IN THIS RECESS FEATURE OF HOLDER

CC489-XX-X-X

STEP 1

STEP 2

IN-PROCESS 1
CC489 WITH CABLE AND IMPCC INSTALLATION
(CRIMP SPECIFICATION SEE CC489 PRINT)

DETAIL 'B'
SCALE 6 : 1

IMPC-XX-P

IN-PROCESS 2
IMPC INSTALLATION

• PROPRIETARY NOTE •
THIS DOCUMENT CONTAINS CONFIDENTIAL AND
PROPRIETARY INFORMATION AND ALL DESIGN,
MANUFACTURING, REPRODUCTION, USE, PATENT RIGHTS
AND SALES RIGHTS ARE EXPRESSLY RESERVED BY SAMTEC,
INC. THIS DOCUMENT SHALL NOT BE DISCLOSED, IN WHOLE
OR PART, TO ANY UNAUTHORIZED PERSON OR ENTITY NOR
REPRODUCED, TRANSFERRED OR INCORPORATED IN ANY
OTHER PROJECT IN ANY MANNER WITHOUT THE EXPRESS
WRITTEN CONSENT OF SAMTEC, INC.

DO NOT SCALE DRAWING

SHEET SCALE: 1:2

samtec

520 PARK EAST BLVD, NEW ALBANY, IN 47150
PHONE: 812-944-6733 FAX: 812-948-5047
e-Mail: info@SAMTEC.com code 55322

DESCRIPTION:
2MM ULTRA MICRO POWER CABLE

DWG. NO.
UMPCX-XX-X-XXX-X-XX.X-X

BY: ETHAN C 07/17/2019 SHEET 5 OF 6

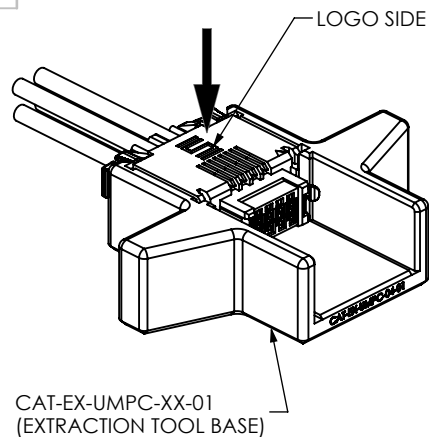

EX-PROCESS 1
PUT CONNECOTR ON THE EXTRACTION TOOL BASE AS SHOWN

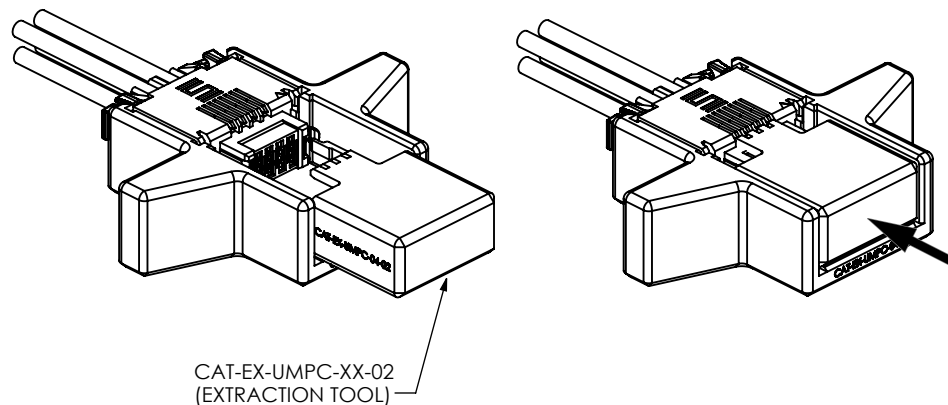

EX-PROCESS 2
SLIDE IN EXTRACTION TOOL TO THE END OF CONNECTOR

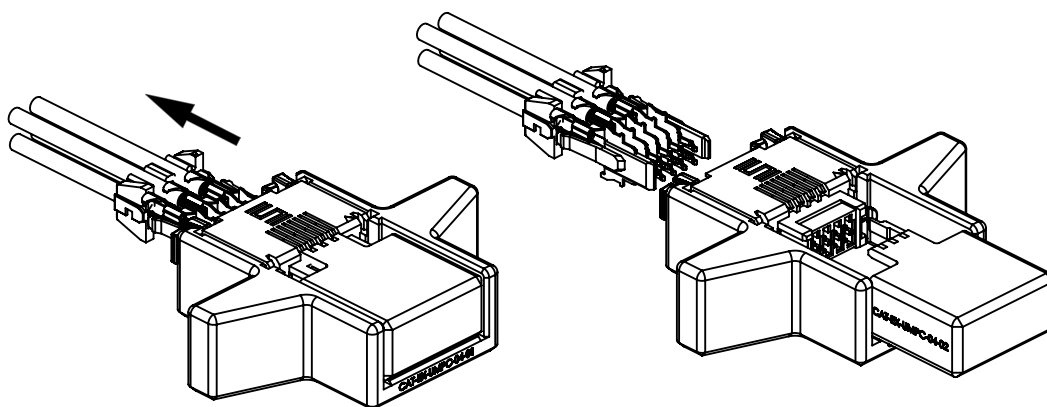

EX-PROCESS 3
PULL OUT THE CABLES FROM CONNECTOR BACK SIDE
THEN WITHDRAW THE EXTRACTION TOOL

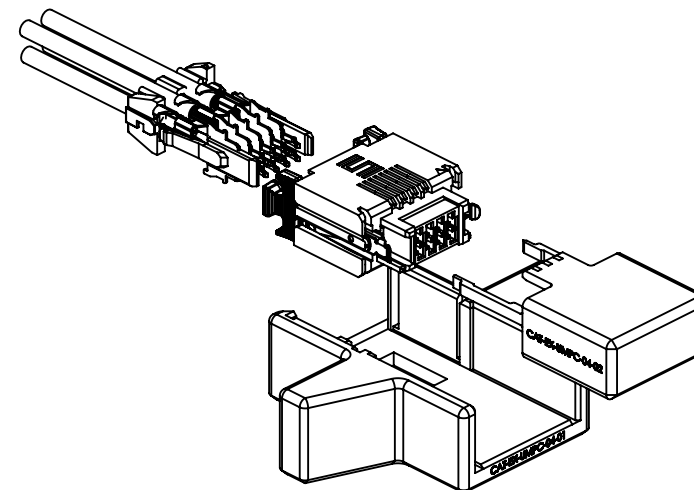

EX-PROCESS 4
REMOVE EXTRACTION TOOL BASE

PROPRIETARY NOTE
THIS DOCUMENT CONTAINS CONFIDENTIAL AND PROPRIETARY INFORMATION AND ALL DESIGN, MANUFACTURING, REPRODUCTION, USE, PATENT RIGHTS AND SALES RIGHTS ARE EXPRESSLY RESERVED BY SAMTEC, INC. THIS DOCUMENT SHALL NOT BE DISCLOSED, IN WHOLE OR PART, TO ANY UNAUTHORIZED PERSON OR ENTITY NOR REPRODUCED, TRANSFERRED OR INCORPORATED IN ANY OTHER PROJECT IN ANY MANNER WITHOUT THE EXPRESS WRITTEN CONSENT OF SAMTEC, INC.

DO NOT SCALE DRAWING

SHEET SCALE: 1:1

samtec

520 PARK EAST BLVD, NEW ALBANY, IN 47150
PHONE: 812-944-6733 FAX: 812-948-5047
e-Mail: info@SAMTEC.com code 55322

DESCRIPTION:
2MM ULTRA MICRO POWER CABLE

DWG. NO.
UMPCX-XX-X-XXX-X-XX.X-X

BY: ETHAN C 07/17/2019 SHEET 6 OF 6