

Series: E-Band (60GHz to 90GHz) PCB RA Waveguide Compression Mount, 50 Ω

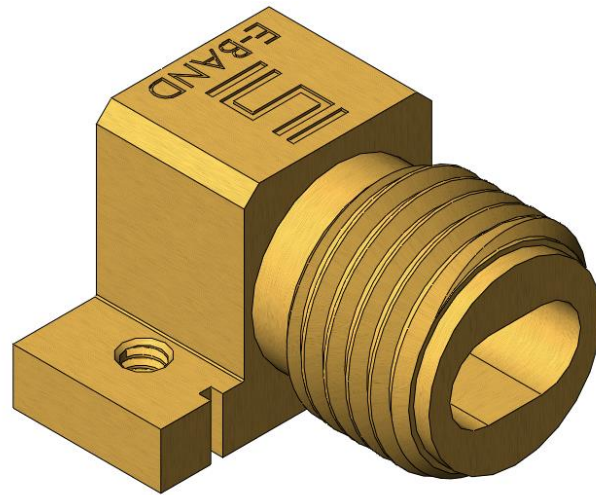

### 90T-J-P-XX-RA-CM

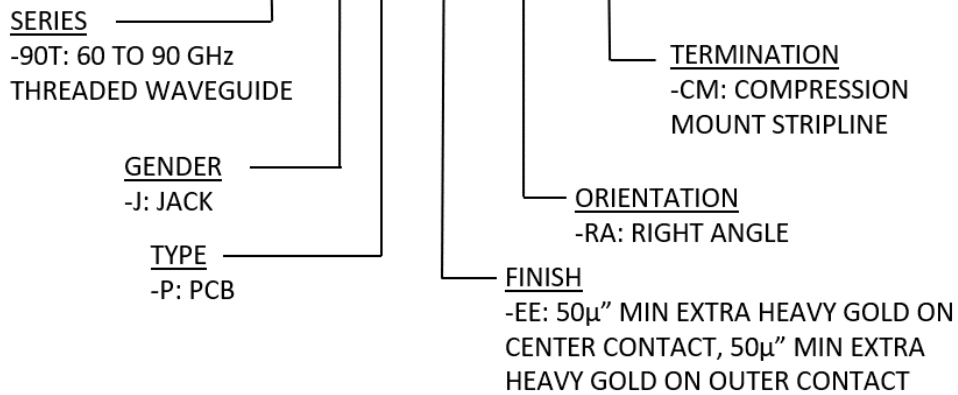

### MATERIAL AND FINISHES

Connector part	Material	Finish
Body	Brass	1.27 μm (50μ") Min. Gold Over 1.27μm (50 μ") Min. Nickel
Bushing	Brass	1.27 μm (50μ") Min. Gold Over 1.27μm (50 μ") Min. Nickel
Bead	PEEK	N/A
Center Contact	Beryllium Copper	1.27 μm (50μ") Min. Gold Over 1.27μm (50 μ") Min. Nickel

**Series:** E-Band (60GHz to 90GHz) PCB RA Waveguide Compression Mount, 50 Ω

### ELECTRICAL DATA

Impedance	50 Ohm
Frequency Range	60 to 90 GHz (E-BAND)
VSWR <sup>1</sup>	1.4:1 VSWR TYPICAL (RL -15dB)
Insertion Loss <sup>2</sup>	$0.03\sqrt{F(GHz)}$ dB Max.
Insulation Resistance	5000 MΩ Min.
Outer Contact Resistance	2.0 mΩ Max.

<sup>1</sup>VSWR per connector when tested on Samtec multi-layer test PCB.

<sup>2</sup>Single connector insertion loss only.

### MECHANICAL DATA

Interface	Custom to Samtec
Recommended Mating Coupler Torque	8 in-lb. [0.90 N-m]
Durability	500 Cycles minimum
Mass	3.23g (0.0071 pounds)

### ENVIRONMENTAL DATA

Temperature Range	-40 to +125°C
Thermal Shock	10 Cycles, -40°C to +125°C

### REFERENCED DOCUMENTS

<b>Configuration and Features</b>	<b>Drawing &amp; Footprint</b>
Compression Mount, Stripline	<a href="#"><u>90T-J-P-EE-RA-CM</u></a>

**Series:** E-Band (60GHz to 90GHz) PCB RA Waveguide Compression Mount, 50  $\Omega$

**USE OF PRODUCT SPECIFICATION SHEET**

This Product Specification Sheet ("PSS") is a brief summary of information related to the Product identified. As a summary, it should only be used for the limited purpose of considering the purchase/use of Product. This PSS is the property of Samtec, Inc. ("Samtec") and contains proprietary information of Samtec, our various licensors, or both. Samtec does not grant express or implied rights or license under any patent, copyright, trademark or other proprietary rights and the use of the PSS for building, reverse engineering or replication is strictly prohibited. By using the PSS, the user agrees to not infringe, directly or indirectly, upon any intellectual property rights of Samtec and acknowledges that Samtec, our various licensors, or both own all intellectual property therein. The PSS is presented "AS IS". While Samtec makes every effort to present excellent information, the PSS is only provided as a guideline and does not, therefore, warrant it is without error or defect or that the PSS contains all necessary and/or relevant information about the Product. The user agrees that all access and use of the PSS is at its own risk. **NO WARRANTIES EXPRESSED OR IMPLIED, INCLUDING ANY WARRANTY OF MERCHANTABILITY, FITNESS FOR A PARTICULAR PURPOSE OR OF ANY KIND WHATSOEVER ARE PROVIDED**