

1. INTRODUCTION

This instruction sheet covers the use of the SAMTEC XCede HD Backplane Header Extraction Tool CAT-EX-HDTM. This tool assists in the removal of the HDTM connector from a PCB.

2. CUSTOMER SERVICE

Further tooling and product application assistance is available by contacting the **Samtec Application Service Line +1-800-726-8329 (+1-812-944-6733)** 8:00 AM to 5:00 PM EST. To expedite your inquiry, have the pertinent part numbers for the product and tooling.

3. DESCRIPTION

To minimize cost, the largest removal tool for a given column pitch may be used to remove any connector with the same column pitch. To use a larger tool, disassemble the tool and remove and excess pins. See set-up chart in Section 5.

4. REMOVAL

The following steps are recommended for removing the HDTM from a PCB:

1. The connector removal tool is a hand tool used to remove HDTM headers from the back side of the PCB by pressing on the pin tips. A hand operated arbor press and bottom support tool (not included with the removal tool) are required to actuate the tool and provide support around the connector during the removal process.
2. With the connector to be removed facing downward, place the board assembly over a bottom support tool (not included) that is appropriate for the board layout.
3. Make sure that the support tool extends along the entire length of at least two opposing sides of the connector. Also make sure that no small components (chip resistors, chip capacitors, etc.) are between the board and the support tool. The size and shape of the support tooling will vary due to the connector size, number of pins, whether there are adjacent connectors, and any other surrounding components.

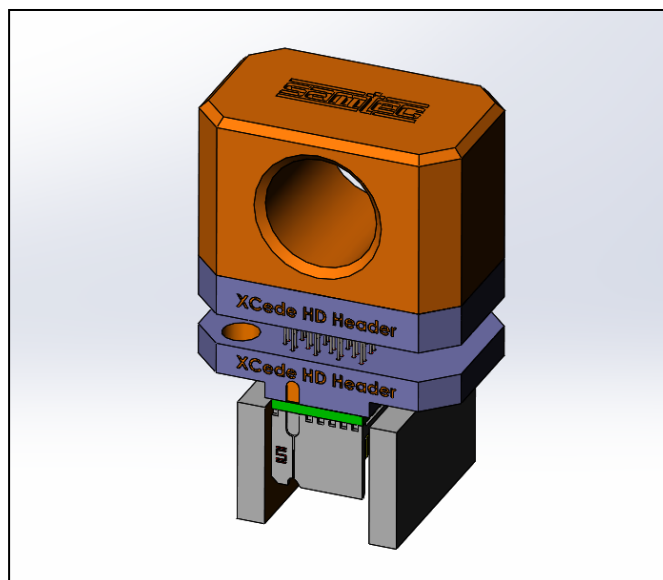

FIGURE 1

- From the back side of the board, roughly align the A1 side of the tool with the A1 via location on the PCB (**Figure 2**).

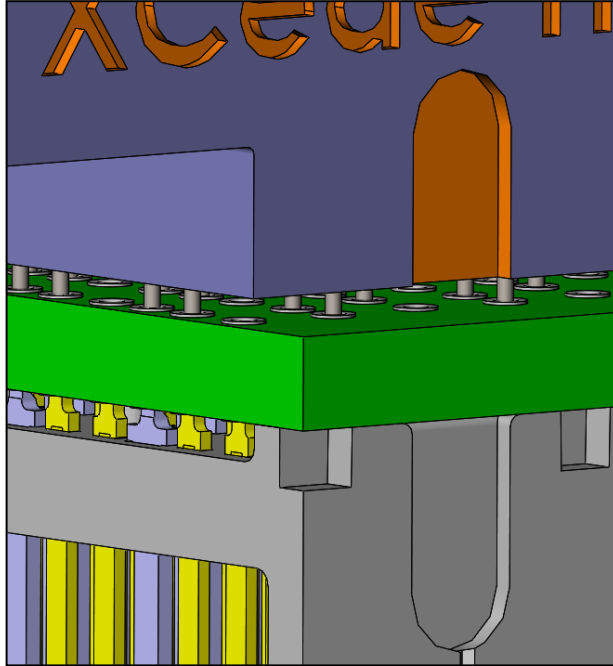

FIGURE 2

- Actuate the press so that the tool is compressed. Apply pressure evenly and slowly, not with a quick motion. Stop applying pressure when the force drops or the press handle becomes easy to move. This will indicate that the pins have released from the PCB. The connector should be lying on the bench or can be easily removed by hand.

5. Set-Up Chart

The chart below shows the pin patterns needed for each part configuration. The red arrow indicates the A pin marker position (same for all images).

<p>HDTM-3-04-X-X-VT-X-X-X-X-X</p> <p>(3 pair, 4 column)</p>	
---	--

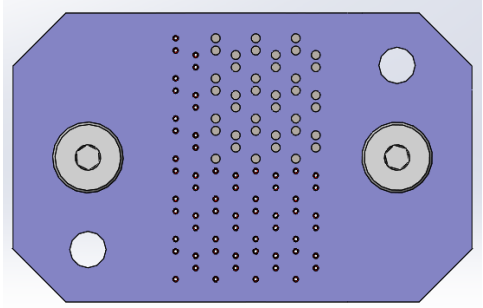
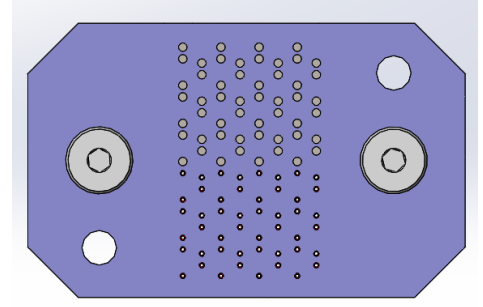
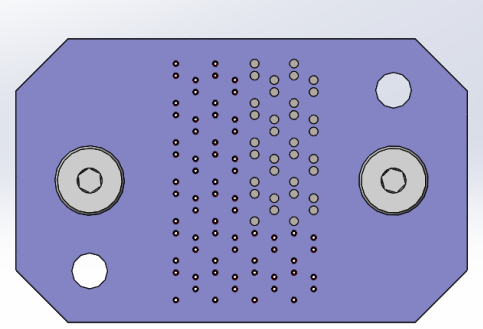
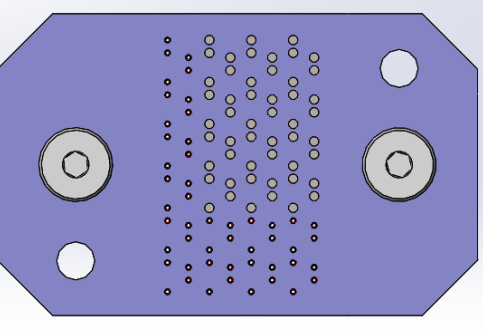
<p>HDTM-3-06-X-X-VT-X-X-X-X-X</p> <p>(3 pair, 6 column)</p>	
<p>HDTM-3-08-X-X-VT-X-X-X-X-X</p> <p>(3 pair, 8 column)</p>	
<p>HDTM-4-04-X-X-VT-X-X-X-X-X</p> <p>(4 pair, 4 column)</p>	
<p>HDTM-4-06-X-X-VT-X-X-X-X-X</p> <p>(4 pair, 6 column)</p>	

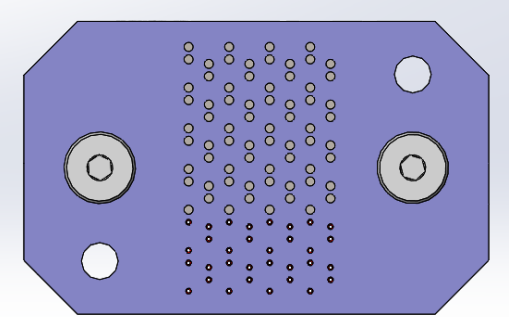
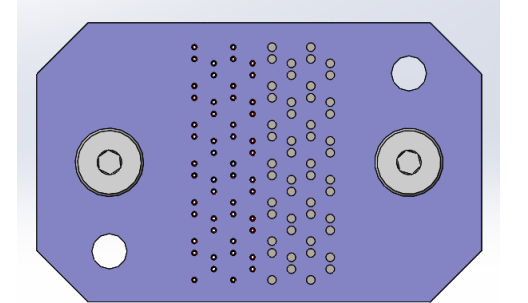
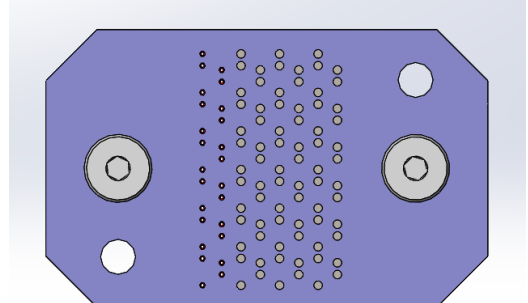
<p>HDTM-4-08-X-X-VT-X-X-X-X-X</p> <p>(4 pair, 8 column)</p>	
<p>HDTM-6-04-X-X-VT-X-X-X-X-X</p> <p>(6 pair, 4 column)</p>	
<p>HDTM-6-06-X-X-VT-X-X-X-X-X</p> <p>(6 pair, 6 column)</p>	



XCede® HD Backplane Header
HDTM Series
CAT-EX-HDTM – HDTM Extraction Tool

Instruction Sheet
STS-X-XXX
Rev. A
Date: 8/27/2019

HDTM-6-08-X-X-VT-X-X-X-X-X
(6 pair, 8 column)

