

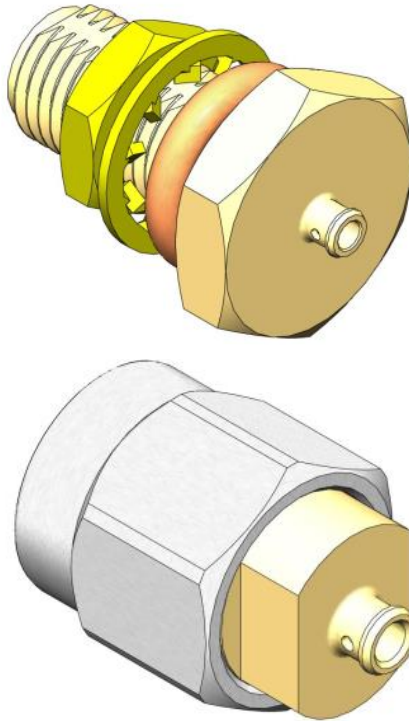

Project Number: Design Qualification Test Report	Tracking Code: CR-959901_Report_Rev_1
Requested by: Jenny Chou	Date: 10/9/2023
Part #: PRF01-J-C-EG-047A-BD-1\PRF01-P-C-EG-047A-SD	
Part description: PRF01-J\PRF01-P	Tech: Kason He
Test Start: 7/27/2023	Test Completed: 8/3/2023



Design Qualification Test Report
PRF01-J\PRF01-P
PRF01-J-C-EG-047A-BD-1\PRF01-P-C-EG-047A-SD

CERTIFICATION

All instruments and measuring equipment were calibrated to National Institute for Standards and Technology (NIST) traceable standards according to ISO 10012-1 and ANSI/NCSL 2540-1, as applicable.

All contents contained herein are the property of Samtec. No portion of this report, in part or in full shall be reproduced without prior written approval of Samtec.

SCOPE

To perform the following tests: Design qualification test. See test plan.

APPLICABLE DOCUMENTS

Standards: CEI\IEC 60529

TEST SAMPLES AND PREPARATION

- 1) All materials were manufactured in accordance with the applicable product specification.
- 2) All test samples were identified and encoded to maintain traceability throughout the test sequences.
- 3) Either an automated cleaning procedure or an ultrasonic cleaning procedure may be used.
- 4) Any additional preparation will be noted in the individual test sequences.

FLOWCHARTS

Dust/Water

IPx7 Water Submersion

Group 1

PRF01-J-C-EG-047A-BD-1

PRF01-P-C-EG-047A-SD

6 Assemblies

Step	Description
1.	Water Submersion - IPX7 ⁽²⁾ Depth = 1 meters
2.	Visual Inspection

IP6x Dust

Group 2

PRF01-J-C-EG-047A-BD-1

PRF01-P-C-EG-047A-SD

6 Assemblies

Step	Description
1.	Dust - IP6X ⁽¹⁾
2.	Visual Inspection

(1) Dust - IP6X = CEI/IEC 60529

(2) Water Submersion - IPX7 = CEI/IEC 60529

ATTRIBUTE DEFINITIONS

The following is a brief, simplified description of attributes.

WATER TESTING:

- 1) Reference document: CEI/IEC 60529 Code IPX7

DUST TESTING:

- 1) Reference document: CEI/IEC 60529 Code IP6X

RESULTS**IP6X & IPX7 Testing (Dust & Water)**

Dust	<u>Initial (Before Exposure)</u> No Dust Present	<u>After Exposure</u> No Dust Present
Water	<u>Initial (Before Exposure)</u> No Water Present	<u>After Exposure</u> No Water Present

DATA SUMMARIES**IP6X & IPX7 Testing (Dust & Water)****Dust**

Sample #	Visual Inspection
1	PASS
2	PASS
3	PASS
4	PASS
5	PASS
6	PASS

Water

Sample #	Visual Inspection
1	PASS
2	PASS
3	PASS
4	PASS
5	PASS
6	PASS

EQUIPMENT AND CALIBRATION SCHEDULES**Equipment #:** WATER-01**Description:** IP-67 1.0 Meter Water Column Chamber**Manufacturer:** Samtec Machine**Model:** N/A**Serial #:** N/A**Accuracy:** No Calibration Required**Equipment #:** DUST-01**Description:** IP-X6 Dust Tester**Manufacturer:** Samtec Machine**Model:** N/A**Serial #:** N/A**Accuracy:** No Calibration Required